

Quotation Advert

Opening Date: 2020-11-16 ☐

Closing Date: 2020-11-26 ☐

Closing Time: 11:00

INSTITUTION DETAILS

Institution Name: Queen Nandi ☐

Province: KwaZulu-Natal

Department or Entity: Department of Health

Division or section: Central Supply Chain Management

Place where goods / services is required: Queen Nandi Regional Hospital 29 Union Street Empangeni 3880

Date Submitted: 2020-11-10 ☐

ITEM CATEGORY AND DETAILS

Quotation Number: ZNQ: 455/20-21

Item Category: Services ☐

Item Description: INSTALLATION OF NEW CANVAS TENT(FLU CLINIC)

Quantity (If supplies) 01 UNIT

COMPULSORY BRIEFING SESSION / SITE VISIT

Select Type: Compulsory Site Visit ☐

Date : 2020-11-20 ☐

Time: 14:00

Venue: QUEEN NANDI HOSPITAL, MAIN GATE

QUOTES CAN BE COLLECTED FROM: QUEEN NANDI REGIONAL HOSPITAL, 29 UNION STREET EMPANGENI

QUOTES SHOULD BE DELIVERED TO: QUEEN NANDI REGIONAL HOSPITAL, 29 UNION STREET EMPANGENI

ENQUIRIES REGARDING THE ADVERT MAY BE DIRECTED TO:

Supply Chain Management - AdvertQuote

Page 2 of 2

Name:

Mr KR Nzimande

Email:

fikile.mlambo@kznhealth.gov.za

Contact Number:

035 907 7769

Finance Manager Name:

Mrs VT Mtantato

Finance Manager Signature:



No late quotes will be considered

YOU ARE HEREBY INVITED TO QUOTE FOR REQUIREMENTS AT: QUEEN NANDI REGIONAL HOSPITAL

DATE ADVERTISED: 16/11/2020 CLOSING DATE: 26/11/2020 CLOSING TIME: 11:00

FACSIMILE NUMBER: 0866292075 E-MAIL ADDRESS: fikile.mlambo@kznhealth.gov.za

PHYSICAL ADDRESS: 29 UNION STREET, EMPANGENI, 3880

ZNQ NUMBER: 455/20-21

DESCRIPTION: INSTALLATION OF NEW CANVAS TENT(FLU CLINIC)

SIGNATURE OF BIDDER DATE.....
 [By signing this document I hereby agree to all terms and conditions]

CAPACITY UNDER WHICH THIS QUOTE IS SIGNED.....

Item No	Quantity	Description	Brand & model	Country of manufacture	Price	
					R	c
	01	INSTALLATION OF NEW CANVAS TENT				
	UNIT	(FLU CLINIC)AT QUEEN NANDI				
		REGIONAL HOSPITAL				
		(SEE THE ATTACHED SPECIFICATION)				
		-PLEASE ATTACH THE FF DOCUMENTS TOGETHER				
		WITH YOUR BID:				
		- TAX CLEARANCE CERTIFICATE				
		- BBBEE CERTIFICATE				
		- CSD FULL REPORT (NOT OLDER THAN 2 DAYS)				
VALUE ADDED TAX @ 15% (Only if VAT Vendor)						
TOTAL QUOTATION PRICE (VALIDITY PERIOD 60 Days)						

Does This Offer Comply With The Specification?	Does The Article Conform To The S.A.N.S. / S.A.B.S. Specification?
Is The Price Firm?	State Delivery Period E.G. <i>E.G. 1day, 1week</i>

<p>Enquiries regarding the <u>quote</u> may be directed to:</p> <p>Contact Person: <u>F.T. MLAMBO</u>.....Tel: <u>0359077064</u>.....</p> <p>E-Mail Address: <u>fikile.mlambo@kznhealth.gov.za</u>.....</p>	<p>Enquiries regarding <u>technical information</u> may be directed to:</p> <p>Contact Person: <u>PV MASONDO</u>.....Tel: <u>035907071</u>.....</p>
---	---

DECLARATION OF INTEREST

- Any legal person, including persons employed by the state¹, or persons having a kinship with persons employed by the state, including a blood relationship, may make an offer or offers in terms of this invitation to quote (includes a price quotation, advertised competitive quote, limited quote or proposal). In view of possible allegations of favouritism, should the resulting quote, or part thereof, be awarded to persons employed by the state, or to persons connected with or related to them, it is required that the bidder or his/her authorised representative declare his/her position in relation to the evaluating/adjudicating authority where-
 - the bidder is employed by the state; and/or
 - the legal person on whose behalf the bidding document is signed, has a relationship with persons/a person who are/is involved in the evaluation and or adjudication of the quote(s), or where it is known that such a relationship exists between the person or persons for or on whose behalf the declarant acts and persons who are involved with the evaluation and or adjudication of the quote.
- In order to give effect to the above, the following questionnaire must be completed and submitted with the quote.

- 2.1. Full Name of bidder/representative.....
- 2.2. Identity Number:
- 2.3. Position occupied in the Company (director, trustee, shareholder²):.....
- 2.4. Company Registration Number:
- 2.5. Tax Reference Number:
- 2.6. VAT Registration Number:

- The names of all directors / trustees / shareholders / members, their individual identity numbers, tax reference numbers and, if applicable, employee / persal numbers must be indicated in paragraph 3 below. [TICK APPLICABLE]

- Are you or any person connected with the bidder presently employed by the state? YES ☐ NO ☐

- If so, furnish the following particulars:

Name of person / director / trustee / shareholder/ member:

Name of state institution at which you or the person connected to the bidder is employed:.....

Position occupied in the state institution:Any other particulars:.....

- If you are presently employed by the state, did you obtain the appropriate authority to undertake remunerative work outside employment in the public sector? YES ☐ NO ☐

- If yes, did you attach proof of such authority to the quote document?

(Note: Failure to submit proof of such authority, where applicable, may result in the disqualification of the quote.)

- If no, furnish reasons for non-submission of such proof:

- Did you or your spouse, or any of the company's directors / trustees / shareholders / members or their spouses conduct business with the state in the previous twelve months? YES ☐ NO ☐

- If so, furnish particulars:.....

- Do you, or any person connected with the bidder, have any relationship (family, friend, other) with a person employed by the state and who may be involved with the evaluation and or adjudication of this quote? YES ☐ NO ☐

- If so, furnish particulars:.....

- Are you, or any person connected with the bidder, aware of any relationship (family, friend, other) between any other bidder and any person employed by the state who may be involved with the evaluation and or adjudication of this quote? YES ☐ NO ☐

- If so, furnish particulars:.....

- Do you or any of the directors / trustees / shareholders / members of the company have any interest in any other related companies whether or not they are bidding for this contract? YES ☐ NO ☐

- If so, furnish particulars:.....

- Full details of directors / trustees / members / shareholders.

NB: The Department Of Health will validate details of directors / trustees / members / shareholders on CSD. It is the suppliers' responsibility to ensure that their details are up-to-date and verified on CSD. If the Department cannot validate the information on CSD, the quote will not be considered and passed over as non-compliant according to National Treasury Instruction Note 4 (a) 2016/17.

4 DECLARATION

I, THE UNDERSIGNED (NAME).....CERTIFY THAT THE INFORMATION FURNISHED IN PARAGRAPHS 2.

I ACCEPT THAT THE STATE MAY REJECT THE QUOTE OR ACT AGAINST ME SHOULD THIS DECLARATION PROVE TO BE FALSE.

Name of bidder	Signature	Position	Date
----------------	-----------	----------	------

¹"State" means –

- | | |
|---|---|
| <ol style="list-style-type: none"> a) any national or provincial department, national or provincial public entity or constitutional institution within the meaning of the Public Finance Management Act, 1999 (Act No. 1 of 1999); b) any municipality or municipal entity; | <ol style="list-style-type: none"> c) provincial legislature; d) national Assembly or the national Council of provinces; or e) Parliament. |
|---|---|

²"Shareholder" means a person who owns shares in the company and is actively involved in the management of the enterprise or business and exercises control over the enterprise.

SPECIAL CONTRACT CONDITIONS OF QUOTATIONS

1. AMENDMENT OF CONTRACT

- 1.1. Any amendment to or renunciation of the provisions of the contract shall at all times be done in writing and shall be signed by both parties.

2. CHANGE OF ADDRESS

- 2.1. Bidders must advise the Department of Health (institution where the offer was submitted) should their address (*domicilium citandi et executandi*) details change from the time of bidding to the expiry of the contract.

3. GENERAL CONDITIONS ATTACHED TO THIS QUOTATION

- 3.1. The institution is under no obligation to accept the lowest or any quote.
- 3.2. The price quoted must include VAT (if VAT vendor). However, it must be noted that the department reserves the right to evaluate all quotations excluding VAT as some bidders may not be VAT vendors.
- 3.3. The bidder must ensure the correctness & validity of quote:
 - (i) *that the price(s), rate(s) & preference quoted cover all for the work/item (s) & accept that any mistakes regarding the price (s) & calculations will be at the bidder's risk*
- 3.4. The bidder must accept full responsibility for the proper execution & fulfilment of all obligations conditions devolving on under this agreement, as the Principal (s) liable for the due fulfilment of this contract.
- 3.5. This quotation will be evaluated based on the 80/20 points system, specification & correctness of information. All required documentation must be completed in full and submitted.
- 3.6. Offers must comply strictly with the specification.
- 3.7. Only offers that meet or are greater than the specification will be considered.
- 3.8. Late quotes will not be considered.
- 3.9. Expired product/s will not be accepted. All products supplied must be valid for a minimum period of six months.
- 3.10. A bidder not registered on the Central Suppliers Database or verification has failed will not be considered.
- 3.11. All delivery costs must be included in the quote price, for delivery at the prescribed destination.
- 3.12. Only firm prices will be accepted. Such prices must remain firm for the contract period. Non-firm prices (including rates of exchange variations) will not be considered.
- 3.13. In cases where different delivery points influence the pricing, a separate pricing schedule must be submitted for each delivery point.
- 3.14. In the event of a bidder having multiple quotes, only the cheapest according to specification will be considered. Furthermore a verification will be done to identify if bidders have multiple companies and are quoting (cover-quoting) for this bid. In such instances only the cheapest bid according to specification will be considered.

4. SPECIAL INSTRUCTIONS AND NOTICES TO BIDDERS REGARDING THE COMPLETION OF THIS QUOTATION.

- 4.1. Unless inconsistent with or expressly indicated otherwise by the context, the singular shall include the plural and vice versa and with words importing the masculine gender shall include the feminine and the neuter.
- 4.2. Under no circumstances whatsoever may the quotation/bid forms be retyped or redrafted. Photocopies of the original bid documentation may be used, but an original signature must appear on such photocopies.
- 4.3. The bidder is advised to check the number of pages and to satisfy himself that none are missing or duplicated.
- 4.4. Quotation submitted must be complete in all respects.
- 4.5. Any alteration made by the bidder must be initialled.
- 4.6. Use of correcting fluid is prohibited
- 4.7. Quotation will be opened in public as soon as practicable after the closing time of quotation.
- 4.8. Where practical, prices are made public at the time of opening quotations.
- 4.9. If it is desired to make more than one offer against any individual item, such offers should be given on a photocopy of the page in question. Clear indication thereof must be stated on the schedules attached.

5. SPECIAL INSTRUCTIONS REGARDING HAND DELIVERED QUOTATIONS

- 5.1. Quotation shall be lodged at the address indicated not later than the closing time specified for their receipt, and in accordance with the directives in the quotation documents.
- 5.2. Each quotation shall be addressed in accordance with the directives in the quotation documents and shall be lodged in a separate sealed envelope, with the name and address of the bidder, the quotation number and closing date indicated on the envelope. The envelope shall not contain documents relating to any quotation other than that shown on the envelope. If this provision is not complied with, such quotations/bids may be rejected as being invalid.
- 5.3. All quotations received in sealed envelopes with the relevant quotation numbers on the envelopes are kept unopened in safe custody until the closing time of the quotation/bids. Where, however, a quotation is received open, it shall be sealed. If it is received without a quotation/bid number on the envelope, it shall be opened, the quotation number ascertained, the envelope sealed and the quotation number written on the envelope.
- 5.4. A specific box is provided for the receipt of quotations, and no quotation found in any other box or elsewhere subsequent to the closing date and time of quotation will be considered.

- 5.5. No quotation/bid sent through the post will be considered if it is received after the closing date and time stipulated in the quotation documentation, and proof of posting will not be accepted as proof of delivery.
- 5.6. Quotation documents must not be included in packages containing samples. Such quotations may be rejected as being invalid.

6. SAMPLES

- 6.1. In the case of the quote document stipulating that samples are required, the supplier will be informed in due course when samples should be provided to the institution. (This decreases the time of safety and storage risk that may be incurred by the respective institution). The bidders sample will be retained if such bidder wins the contract.
- (i) If a company/s who has not won the quote requires their samples, they must advise the institution in writing of such.
- (ii) If samples are not collected within three months of close of quote the institution reserves the right to dispose of them at their discretion.
- 6.2. **Samples must be made available when requested in writing or if stipulated on the document.**
- (i) If a Bidder fails to provide a sample of their product on offer for scrutiny against the set specification when requested, their offer will be rejected. All testing will be for the account of the bidder.

7. COMPULSORY SITE INSPECTION / BRIEFING SESSION

- 7.1. Bidders who fail to attend the compulsory meeting will be disqualified from the evaluation process.

- (i) The institution has determined that a compulsory site meeting ☐ YES ☐ take place
- (ii) Date 11/20/2020 Time 14:00 Place QUEEN NANDI REGIONAL HOSPITAL

Institution Stamp:	Institution Site Inspection / briefing session Official
	Full Name:
	Signature:
	Date:

8. STATEMENT OF SUPPLIES AND SERVICES

- 8.1. The contractor shall, when requested to do so, furnish particulars of supplies delivered or services executed. If he/she fails to do so, the Department may, without prejudice to any other rights which it may have, institute inquiries at the expense of the contractor to obtain the required particulars.

9. SUBMISSION AND COMPLETION OF SBD 6.1

- 9.1. Should a bidder wish to qualify for preference points they must complete a SBD 6.1 document. Failure by a bidder to provide all relevant information required, will result in such a bidder not being considered for preference point's allocation. The preferences applicable on the closing date will be utilized. Any changes after the closing date will not be considered for that particular quote.

10. TAX COMPLIANCE REQUIREMENTS

- 10.1. In the event that the tax compliance status has failed on CSD, **it is the suppliers' responsibility to provide a SARS pin in order for the institution to validate the tax compliance status of the supplier.**
- 10.2. In the event that the institution cannot validate the suppliers' tax clearance on SARS as well as the Central Suppliers Database, **the quote will not be considered and passed over as non-compliant according to National Treasury Instruction Note 4 (a) 2016/17.**

11. TAX INVOICE

- 11.1. A tax invoice shall be in the currency of the Republic of South Africa and shall contain the following particulars:

- | | |
|--|--|
| (i) the name, address and registration number of the supplier; | (iv) a description and quantity or volume of the goods or services supplied; |
| (ii) the name and address of the recipient; | (v) the official department order number issued to the supplier; |
| (iii) an individual serialized number and the date upon which the tax invoice is issued; | (vi) the value of the supply, the amount of tax charged; |
| | (vii) the words tax invoice in a prominent place. |

12. PATENT RIGHTS

The supplier shall indemnify the KZN Department of Health (hereafter known as the purchaser) against all third-party claims of infringement of patent, trademark, or industrial design rights arising from use of the goods or any part thereof by the purchaser.

13. PENALTIES

- 13.1. If at any time during the contract period, the service provider is unable to perform in a timely manner, the service provider must notify the institution in writing/email of the cause of and the duration of the delay. Upon receipt of the notification, the institution should evaluate the circumstances and, if deemed necessary, the institution may extend the service provider's time for performance.
- 13.2. In the event of delayed performance that extends beyond the delivery period, the institution is entitled to purchase commodities of a similar quantity and quality as a substitution for the outstanding commodities, without terminating the contract, as well as return commodities delivered at a later stage at the service provider's expense.
- 13.3. Alternatively, the institution may elect to terminate the contract and procure the necessary commodities in order to complete the contract. In the event that the contract is terminated the institution may claim damages from the service provider in the form of a penalty. The service provider's performance should be captured on the service provider database in order to determine whether or not the service provider should be awarded any contracts in the future.
- 13.4. If the supplier fails to deliver any or all of the goods or to perform the services within the period(s) specified in the contract, the purchaser shall, without prejudice to its other remedies under the contract, deduct from the contract price, as a penalty, a sum calculated on the delivered price of the delayed goods or unperformed services using the current prime interest rate calculated for each day of the delay until actual delivery or performance.

14. TERMINATION FOR DEFAULT

- 14.1. The purchaser, without prejudice to any other remedy for breach of contract, by written notice of default sent to the supplier, may terminate this contract in whole or in part:
 - (i) if the supplier fails to deliver any or all of the goods within the period(s) specified in the contract,
 - (ii) if the supplier fails to perform any other obligation(s) under the contract; or
 - (iii) if the supplier, in the judgment of the purchaser, has engaged in corrupt or fraudulent practices in competing for or in executing the contract.
- 14.2. In the event the purchaser terminates the contract in whole or in part, the purchaser may procure, upon such terms and in such manner as it deems appropriate, goods, works or services similar to those undelivered, and the supplier shall be liable to the purchaser for any excess costs for such similar goods, works or services.
- 14.3. Where the purchaser terminates the contract in whole or in part, the purchaser may decide to impose a restriction penalty on the supplier by prohibiting such supplier from doing business with the public sector for a period not exceeding 10 years.

15. FAILURE TO COMPLY WITH ABOVE WILL RESULT IN YOUR QUOTE BEING PASSED OVER.

PREFERENCE POINTS CLAIM FORM IN TERMS OF THE PREFERENTIAL PROCUREMENT REGULATIONS 2017

This preference form must form part of all quotes invited. It contains general information and serves as a claim form for preference points for Broad-Based Black Economic Empowerment (B-BBEE) Status Level of Contribution

NB: BEFORE COMPLETING THIS FORM, BIDDERS MUST STUDY THE GENERAL CONDITIONS, DEFINITIONS AND DIRECTIVES APPLICABLE IN RESPECT OF B-BBEE, AS PRESCRIBED IN THE PREFERENTIAL PROCUREMENT REGULATIONS, 2017.

1. GENERAL CONDITIONS

1.1 The following preference point systems are applicable to all quotes:

- the 80/20 system for requirements with a Rand value of up to R50 000 000 (all applicable taxes included); and

1.2 The value of this quote is estimated to not exceed R50 000 000 (all applicable taxes included) and therefore the 80/20 preference point system shall be applicable.

1.3 Points for this quote shall be awarded for:

- (a) Price; and
- (b) B-BBEE Status Level of Contributor.

1.4 The maximum points for this quote is allocated as follows:

	POINTS
PRICE	80
B-BBEE STATUS LEVEL OF CONTRIBUTOR	20
Total points for Price and B-BBEE must not exceed	100

1.5 Failure on the part of a bidder to submit proof of B-BBEE Status level of contributor together with the quote, will be interpreted to mean that preference points for B-BBEE status level of contribution are not claimed.

1.6 The purchaser reserves the right to require of a bidder, either before a quote is adjudicated or at any time subsequently, to substantiate any claim in regard to preferences, in any manner required by the purchaser.

2. DEFINITIONS

- (a) **"B-BBEE"** means broad-based black economic empowerment as defined in section 1 of the Broad-Based Black Economic Empowerment Act;
- (b) **"B-BBEE status level of contributor"** means the B-BBEE status of an entity in terms of a code of good practice on black economic empowerment, issued in terms of section 9(1) of the Broad-Based Black Economic Empowerment Act;
- (c) **"bid"** means a written offer in a prescribed or stipulated form in response to an invitation by an organ of state for the provision of goods or services, through price quotations, advertised competitive bidding processes or proposals;
- (d) **"Broad-Based Black Economic Empowerment Act"** means the Broad-Based Black Economic Empowerment Act, 2003 (Act No. 53 of 2003);
- (e) **"EME"** means an Exempted Micro Enterprise in terms of a code of good practice on black economic empowerment issued in terms of section 9 (1) of the Broad-Based Black Economic Empowerment Act;
- (f) **"functionality"** means the ability of a tenderer to provide goods or services in accordance with specifications as set out in the tender documents.
- (g) **"prices"** includes all applicable taxes less all unconditional discounts;
- (h) **"proof of B-BBEE status level of contributor"** means:
 - 1) B-BBEE Status level certificate issued by an authorized body or person;
 - 2) A sworn affidavit as prescribed by the B-BBEE Codes of Good Practice;
 - 3) Any other requirement prescribed in terms of the B-BBEE Act;
- (i) **"QSE"** means a qualifying small business enterprise in terms of a code of good practice on black economic empowerment issued in terms of section 9 (1) of the Broad-Based Black Economic Empowerment Act;
- (j) **"rand value"** means the total estimated value of a contract in Rand, calculated at the time of bid invitation, and includes all applicable taxes;

3. POINTS AWARDED FOR PRICE

3.1 THE 80/20 PREFERENCE POINT SYSTEMS

A maximum of 80 points is allocated for price on the following basis:

$$P_s = 80 \left(1 - \frac{P_t - P_{\min}}{P_{\min}} \right) \text{ Where}$$

P_s = Points scored for price of bid under consideration
 P_t = Price of bid under consideration
 P_{\min} = Price of lowest acceptable bid

4. POINTS AWARDED FOR B-BBEE STATUS LEVEL OF CONTRIBUTOR

- 4.1 In terms of Regulation 6 (2) and 7 (2) of the Preferential Procurement Regulations, preference points must be awarded to a bidder for attaining the B-BBEE status level of contribution in accordance with the table below:

B-BBEE Status Level of Contributor	Number of points (80/20 system)
1	20
2	18
3	14
4	12
5	8
6	6
7	4
8	2
Non-compliant contributor	0

5. BID DECLARATION

- 5.1 Bidders who claim points in respect of B-BBEE Status Level of Contribution must complete the following:

6. B-BBEE STATUS LEVEL OF CONTRIBUTOR CLAIMED IN TERMS OF PARAGRAPHS 1.4 AND 4.1

- 6.1 B-BBEE Status Level of Contributor: =(maximum of 20 points)

(Points claimed in respect of paragraph 7.1 must be in accordance with the table reflected in paragraph 4.1 and must be substantiated by relevant proof of B-BBEE status level of contributor.

7. SUB-CONTRACTING

(Tick applicable box)

- 7.1 Will any portion of the contract be sub-contracted?

YES		NO	
-----	--	----	--

- 7.1.1 If yes, indicate:

- i) What percentage of the contract will be subcontracted.....%
 ii) The name of the sub-contractor.....
 iii) The B-BBEE status level of the sub-contractor.....

8. Whether the sub-contractor is an EME or QSE

(Tick applicable box)

- iv) Specify, by ticking the appropriate box, if subcontracting with an enterprise in terms of Preferential Procurement Regulations, 2017:

YES		NO	
-----	--	----	--

Designated Group: An EME or QSE which is at least 51% owned by:	EME ✓	QSE ✓
Black people		
Black people who are youth		
Black people who are women		
Black people with disabilities		
Black people living in rural or underdeveloped areas or townships		
Cooperative owned by black people		
Black people who are military veterans		
OR		
Any EME		
Any QSE		

9. **DECLARATION WITH REGARD TO COMPANY/FIRM**

9.1 Name of company/firm:.....

9.2 VAT registration number:.....

9.3 Company registration number:.....

9.4 **TYPE OF COMPANY/ FIRM [TICK APPLICABLE BOX]**

- ☐ Partnership/Joint Venture / Consortium
- ☐ One person business/sole propriety
- ☐ Close corporation
- ☐ Company
- ☐ (Pty) Limited

9.5 **DESCRIBE PRINCIPAL BUSINESS ACTIVITIES**

.....
.....

9.6 **COMPANY CLASSIFICATION [TICK APPLICABLE BOX]**

- ☐ Manufacturer
- ☐ Supplier
- ☐ Professional service provider
- ☐ Other service providers, e.g. transporter, etc.

9.7 Total number of years the company/firm has been in business:.....

9.8 I/we, the undersigned, who is / are duly authorised to do so on behalf of the company/firm, certify that the points claimed, based on the B-BBE status level of contributor indicated in paragraphs 1.4 and 6.1 of the foregoing certificate, qualifies the company/ firm for the preference(s) shown and I / we acknowledge that:

- i) The information furnished is true and correct;
- ii) The preference points claimed are in accordance with the General Conditions as indicated in paragraph 1 of this form;
- iii) In the event of a contract being awarded as a result of points claimed as shown in paragraphs 1.4 and 6.1, the contractor may be required to furnish documentary proof to the satisfaction of the purchaser that the claims are correct;
- iv) If the B-BBEE status level of contributor has been claimed or obtained on a fraudulent basis or any of the conditions of contract have not been fulfilled, the purchaser may, in addition to any other remedy it may have –
 - (a) disqualify the person from the bidding process;
 - (b) recover costs, losses or damages it has incurred or suffered as a result of that person's conduct;
 - (c) cancel the contract and claim any damages which it has suffered as a result of having to make less favourable arrangements due to such cancellation;
 - (d) recommend that the bidder or contractor, its shareholders and directors, or only the shareholders and directors who acted on a fraudulent basis, be restricted by the National Treasury from obtaining business from any organ of state for a period not exceeding 10 years, after the *audi alteram partem* (hear the other side) rule has been applied; and
 - (e) forward the matter for criminal prosecution.

WITNESSES

- 1.
- 2.

.....
SIGNATURE(S) OF BIDDERS(S)

DATE:

ADDRESS.....
.....
.....



KWAZULU-NATAL PROVINCE

HEALTH
REPUBLIC OF SOUTH AFRICA

FLU CLINIC STRUCTURES SPECIFICATION

FACILITY NAME: QUEEN NANDI REGIONAL HOSPITAL

**PROJECT DESCRIPTION: SUPPLY AND INSTALLATION OF FLU CLINIC STRUCTURES
AT KING CETSHWAYO DISTRICT**

Project Leader: Mr Masondo

Email: petros.masondo@kznhealth.gov.za

CONTENTS

	Page
1 DESCRIPTION OF TECHNICAL SPECIFICATION	4
1.1 Background	4
1.2 Acronyms/Abbreviations	4
1.3 Definitions	5
2 SCOPE OF WORK	6...8
2.1 Flu Clinic Complex Flooring	9
2.2 Flu Clinic Complex Structure	9
2.3 Flu Clinic Side Panels	10
2.4 Flu Clinic Roofing Sheeting	10
2.5 Lighting	11
2.6 Philosophy	11
4 CONDITIONS OF CONTRACT	12
4.1 Notice to Bidders	12
4.2 Execution Period	12
5 PARTICULAR SPECIFICATION	13
5.1 General Requirements	13
5.2 Electrical Installation Details	13
5.3 Safety and Risk Management	14
5.4 Quality Requirements	14
5.5 Testing and Commissioning	14
5.6 Maintenance Manuals	14
5.7 Maintenance and Servicing	15
5.8 Completion	15
6 THE SITE	15
7 PROGRAM OF WORKS	15

8	EVALUATION CRITERIA	16
9	SCHEDULE OF PRICE	17
10	BIIL OF QUANTITIES	18-20
10	COMPLIANCE WITH REGULATIONS AND STANDARD SPECIFICATIONS	21
11	REVISION HISTORY TABLE	21

1 DESCRIPTION OF TECHNICAL SPECIFICATION

The technical specification makes provision for the installation of a flu clinic complex or structure at **Queen Nandi Regional Hospital**. The flu clinic complex shall be supplied complete with the following:

- a) Roof sheeting
- b) Side panels
- c) Elevated flooring
- d) Lighting
- e) Electricity plug point
- f) Flush toilets and sinks, complete with plumbing and water supply
- g) Sink in consulting room, complete with plumbing and water supply
- h) Partition and windows where applicable

1.1 Background

Due to the COVID 19 pandemic it is necessary for flu clinics to be established on various facilities to ensure that patients are screened for COVID 19, tested and triaged accordingly prior to admission into the health facility in order to enhance the management and mitigation of the spread of COVID 19.

The purpose of this specification is to specify the details of the required flu clinics structures for the purposes of screening, testing and triaging of patients in health facilities in King Cetshwayo District.

1.2 Acronyms/Abbreviations

Abbreviation	Description
COC	Certificate of Compliance
COVID	Corona Virus Disease
OHS Act	Occupational Health and Safety Act 85 of 1993
SANS	South African National Standard

1.3 Definitions

1.3.1 Access

- a) Official contractual permission to a Contractor to proceed with construction of a plant or installation of equipment in a section of the plant constructed by other.

1.3.2 Installation

- b) Installing of equipment or parts of equipment or plant as per design.

1.3.3 Commissioning

- c) Energising of equipment for the purpose of testing and ensuring that the systems operate as designed.

1.3.4 Energising

- d) Applying electrical power to systems.

1.3.5 Operational

- e) Running systems as per design.

1.3.6 Storage

- f) Placing equipment in building or rooms for protection awaiting installation or energising.

1.3.7 Servicing

- g) Performing maintenance and/or repair work.

2 SCOPE OF WORK

The scope of work entails the supply, installation, commissioning of flu clinic complex as per the attached sketch below.

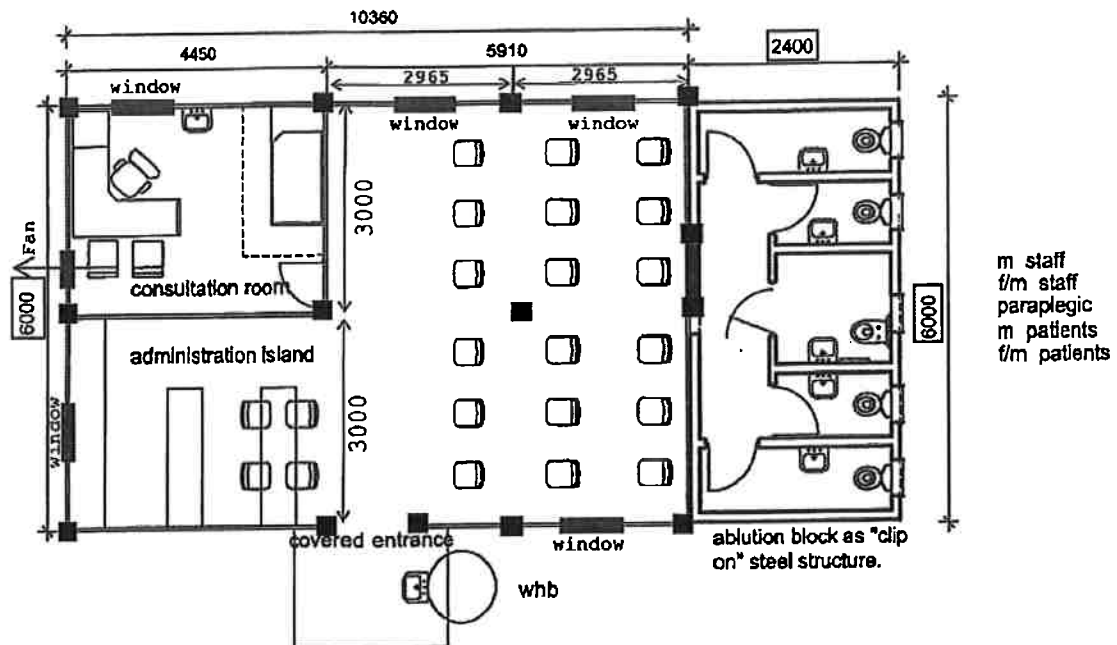

Figure 1: Flu Clinic Proposal

The flu clinic complex shall consist of the following:

- a) Consulting room complete with a sink, 1 x single phase electricity plug point
- b) Administration Island
- c) Covered Entrance
- d) Waiting area accommodating 20 people
- e) Ablution facilities for male and female staff, male and female patients as well as paraplegic toilet complete with sinks as show above in a container.
- f) Allow to remove all rubble from site and leave Queen Nandi Hospital site clean
- g) Allow the Ramped Entrance for wheelchairs
- h) 10 m x 6 m structure including frame and partitioning. The flu complex structure shall be constructed of 76 mm x 76 mm x 1.6 mm thick galvanised square tubes. Height of the structure shall be 3.0 m. Refer to specification and figure 1 for more details.
- i) Steel structure ablution block 6 m (length) x 2.4 m (width) x 2.5 m (height) complete with sanware, electrical fittings, etc. Refer to specification and figure 1 for more details.
- j) Allow for asphaltting including reducing levels, layers works, compaction, etc.
- k) A wooden board shall be laid over the elevated platform and vinyl sheeting shall be used to finish off the floor surface.

- l) Supply and install galvanised steel and painted lipped channels of 150 mm x 50 mm x 20 mm x 2 mm shall be used for creation of the roof structure.
- m) Allow for ablution block to be constructed from a standard 6000 mm x 2400 mm container and partitioned
- n) Supply and install galvanised IBR sheeting on the walls made from painted IBR sheets of minimum 0.47 mm thickness coloured IBR roof sheeting. The galvanised sheets shall be coated with a primer and a top colour coat. Preferred colour of the IBR sheeting is cream white.
- o) The flu clinic complex shall be roofed with minimum 0.47 mm thick coloured IBR roof sheeting. The galvanised sheets shall be coated with a primer and a top colour coat.
- p) Size of extraction fan: Based on 12 ACH = 480.6 m³/h = 133.5 l/s and based on 80 l/s/person = 576 m³/h = 160 l/s (based on two people). Selected size of extraction fan is 160 l/s = 576 m³/h at 55 Pa.
- q) Supply and install PVC gutters and down pipes to be installed to collect rain water from the roof.
- r) Supply and install PTT 1212) aluminium window (Width: 1190 mm x Height: 1190 mm). 1 x consulting room, 1 x Administration Island and 3 x waiting area.
- s) Allow to install 20mm PVC conduits, inspection box, compression glands, mounting screws
- t) Supply and install 4.5 kg DCP fire extinguisher in the waiting area
- u) Allow to put river sand before and after cable sleeve, water line and sewage line then G5 gravelling, compact and lay pavers back
- v) Supply and install 210 Litres 70% Alcohol Sanitation desk mounted on 0.6m x 0.6m x 0.5m high welded steel desk. The pump must be operated by foot
- w) Supply and install 36Watts Electronic ballast Dust proof fluorescent fitting double tube with tubes at waiting area, consulting room, administration island & covered entrance
- x) Supply and install 2PL9 light fittings with tubes
- y) Supply and install Vaal Wash Hand Basins complete with stainless steel waste and bottle traps refer to Fig. 1
- z) Supply and install clip on steel structure close couple toilet
- aa) Supply and install 3Toilet roll holder
- bb) Supply and install Liquid soap dispenser refillable
- cc) Supply and Install 285mm x 130mm x 370mm Stainless steel Kleenex dispenser
- dd) Supply & install 350mm x 260mm x 390mm Stainless steel clip on bin
- ee) Supply & install 15mm Cobra Elbow Action Taps on wash hand basin
- ff) Dig a trench 65m x 0.6m x 0.6m deep and maintain fall
- gg) Supply & install 50m x 10mm² 2Core ECC cable + gland
- hh) Supply and Install Stainless steel WHB waste fittings
- ii) Supply and Install PVC bottle trap
- jj) Supply and install 110mm Rodding eye
- kk) Supply and Install 110mm x 45° bend
- ll) Supply and Install 50mm x 90° PVC bend
- mm) Supply and Install 110mm x 50mm PVC Saddle
- nn) Supply and install 50mm PVC Tee
- oo) Supply and Install 50mm PVC socket
- pp) Supply and install 350mm braided connectors
- qq) Supply and Install 50mm PVC Y- Junction

- rr) Supply and Install 110mm Underground pipes
- ss) Supply and Install 110mm PVC Y-Junction
- tt) Supply and Install 110mm PVC Socket
- uu) Supply and Install 15A circuit breaker 5KA rating or bigger (Hega)
- vv) Supply and Install 20A circuit breaker 5KA rating or bigger (Hega)
- ww) Supply and Install 60A double pole isolator
- xx) Supply and Install 63A Earthleakage 5KA rating or bigger (Hega)
- yy) Supply and Install 63A Main switch 5KA ratings or bigger (Hega)
- zz) Supply and Install 12Way weather proof portable Kiosk lockable
- aaa) Supply and Install 1Lever switch Crabtree
- bbb) Supply and Install 16A double plug socket Crabtree
- ccc) Supply and Install 2 x 4 PVC Switch box
- ddd) Supply and Install 4 x 4 PVC plug socket box
- eee) Supply and Install 40 x 40mm cable black sleeve pipe
- fff) Supply and install light Masonite door
- ggg) Supply and install 3mm Brass door Hinges
- hhh) Supply and Install toilet Indicator bolt
- iii) Supply and Install Union Cylinder lock complete set
- jjj) Supply and Install 2.5mm² Surfex cable for plug socket
- kkk) Supply and Install 4 x 4 isolator box, 30A Isolator , 1 Extractor Fan, 30 A breaker Hega + cabling for Consulting room
- lll) Supply and install Extractor fan, 30A isolator + 4 x 4 box and cable in the waiting area
- mmm) Supply and install extractor fan in the toilets: Two options i) extractor fan in each toilet ii) one suitable fan extracting from all five toilets
- nnn) Supply and Install 4 x 4 Isolator box
- ooo) Supply and Install 4mm² Surfex cable for Extractor Fan
- ppp) Supply and Install 600 x 600mm Frosted glass Aluminium windows in the toilets
- qqq) Supply and Install Paraplegic toilet hand Rails
- rrr) Supply and Install 400 x 800mm Mirror above Wash Hand Basin in (male, female & paraplegic toilet)
- sss) Supply and Install Perspex engraved Signage (1 x Consultation Room, 1 x Administration, 1 x Waiting Area, 1 x Sanitise Here, 1 x Ablution Block, 1 x Male sign, 3 x Female sign & 1 x wheel chair sign) some must be hanged
- ttt) Allow the partitioning of the consultation room 4450 x 3500mm

Refer to sketch above for the sizes of the required spaces within the flu clinic complex.

2.1 Flu Clinic Complex Flooring

- The flu clinic complex shall be erected on a minimum 100 mm slab thickness where applicable.
- The construction of the slab shall be in such a way to prevent rain water from flowing into the flu clinic.
- In the case where the flu clinic is constructed in a parking lot, an elevated platform of minimum 150 mm high shall be constructed to ensure rain water can pass under the floor. Refer to below typical elevated floor platform. A wooden board shall be laid over the elevated platform and vinyl sheeting shall be used to finish off the floor surface.
- A suitable ramp shall be constructed to the entrance of the flu clinic complex.



Figure 2: Typical elevated floor platform.

- Typical wooden board is pine plywood grade B/C 12 mm thick or equally approved shall be laid on top of the elevated platform.

2.2 Flu Clinic Complex Structure

The flu complex structure shall be constructed of:

- 76 mm x 76 mm x 1.6 mm thick galvanised square tubes
- Height of the structure shall be 3.0 m.
- Refer to figure 1 for indicative positions of square tubes.
- The square tubes shall be adequately fixed to the ground to ensure the structure can endure of seismic events.
- Galvanised steel and painted lipped channels of 150 mm x 50 mm x 20 mm x 2 mm shall be used for creation of the roof structure.
- The ablution block is envisaged to be constructed from a standard 6000 mm x 2400 mm container and partitioned and accordingly and all necessary fitting and connections made as indicated in figure 1. The ablution block shall be connected to the hospital's main sewer lines and water supply to sinks.

2.3 Flu Clinic Side Panels

- The flu clinic complex shall have walls made from galvanised and painted IBR sheets of minimum 0.47 mm thick coloured IBR roof sheeting. The galvanised sheets shall be coated with a primer and a top colour coat. Preferred colour of the IBR sheeting is cream white.
- Aluminium framed windows shall be installed on the side panels to facilitate natural ventilation and natural lighting.
 - Consulting room floor area = 13.35 m²
 - 10% of office area = 1.335 m² (window size area)
 - Size of waiting area including administration island = 48.81 m²
 - 10% of waiting area = 4.881 m² (window size area)
- 1 off window is required in the consulting room (PTT 1212)
 - Width: 1190 mm
 - Height: 1190 mm
 - Glazing: 4 mm S = Safety Glass
 - Size of extraction fan:
 - Based on 12 ACH = 480.6 m³/h = 133.5 l/s and based on 80 l/s/person = 576 m³/h = 160 l/s (based on two people). Selected size of extraction fan is **160 l/s = 576 m³/h at 55 Pa**. The extraction fan shall be operated with an independent switch from the lights.
- 4 off windows are required in waiting area (PTT 1212)
 - Width: 1190 mm
 - Height: 1190 mm
 - Glazing: 4 mm S = Safety Glass

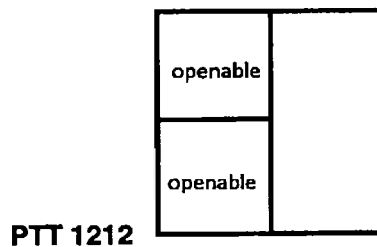

Figure 3: Typical window envisaged

2.4 Flu Clinic Roofing Sheeting

- The flu clinic complex shall have a flat roof with adequate slope for rain water as per approved standards.
- The flu clinic complex shall be roofed with minimum 0.47 mm thick coloured IBR roof sheeting. The galvanised sheets shall be coated with a primer and a top colour coat. Adequate screws shall be used for fixing the IBR sheets onto the lipped channels as per suppliers' recommendations.
- Appropriate gutters and down corner pipes shall be installed to collect rain water from the roof.

2.5 Lighting

- Adequate lighting at 20 W/m² shall be provided in the waiting area, consulting room and toilets.
- Separate light switches are to be installed in the three spaces i.e. waiting area, consulting room and toilets.
- Outside lighting affixed to the flu clinic complex shall be installed towards the entrance.

2.6 Philosophy

The philosophy of the flu clinic complex entails that:

- Windows in the waiting area and consulting room shall always be opened to facilitate air circulation.
- The extraction fan in the consulting room shall be run concurrent with an open window in the consulting room.
- The door to the consulting room shall always be closed to prevented sucking of air from the waiting area into the consulting room.
- Toilets shall have openable windows to facilitate air circulation for the removal of odours.
- 1 x 4.5 kg DCP fire extinguisher shall be installed in the waiting area.

4 CONDITIONS OF CONTRACT

4.1 Notice to Bidders

- a) The institutions will remain open and operational at all times therefore the Contractor shall make the necessary arrangements with the Institutional Management and maintenance staff for any power outages that are required. This may necessitate weekend work.
- b) The Administration reserves the right to negotiate prices in the Schedule of Prices.
- c) All redundant material and rubble shall be removed from the institution's property immediately.
- d) All equipment and materials used in this contract shall be that which is specified or other approved prior to submission and closure of the bid.
- e) The Contractor is advised to examine all the drawings (if any) and to visit the site prior to tendering to acquaint him/herself with the nature of the work to be done and access to the siting of the existing buildings etc., as no claim will be allowed on the grounds of ignorance of the conditions under which the work will be executed.
- f) Any discrepancies or omissions shall be brought to the attention of the Project Leader immediately.
- g) Preference will be given to Bidders who have registered offices / workshops within the borders of the Province of KwaZulu-Natal. This is in an effort to reduce response times to call outs for breakdowns in the more remote areas of the Province.
- h) The Contractor must be registered with CIDB and must have minimum grading of 1 GB/ EB.
- i) The Contractor must be competent with proven experience in working in a building industry with traceable references.

4.2 Execution Period

Four (4) weeks is the specified completion period for the construction stage from the date of award.

5 PARTICULAR SPECIFICATION

5.1 General Requirements

Tenderers are to make special note of the following:

- a) The whole installation shall be in accordance with the Occupational Health and Safety Act 85/1993 and all regulations framed therein shall be carried out to the satisfaction of the Department of Health.
- b) Competent workmen skilled in their trade shall carry out all work. Quality shall be of the best standard practice and all workmanship will be subject to the approval of the Department of Health.
- c) The work shall at all times, for the duration of the contract, be carried out under the supervision of a skilled and competent representative of the Contractor, who will be able and authorized to receive and carry out instructions on behalf of the Contractor. A sufficient number of workmen shall be employed at all times to ensure satisfactory progress of the work.
- d) All apparatus, component parts, fittings and materials employed in the execution of the Contract shall be new and unused and shall be the latest type or pattern of the particular manufacture employed. S.A.B.S. mark bearing items shall be used wherever possible.
- e) The complete installation shall be maintained for a period of twelve months (12) after acceptance in writing by the Department of Health and shall allow for routine inspections not less frequently than two times a year.
- f) The complete installation must be guaranteed against defective parts and workmanship for a period of twelve months (12) after the date of issue of the Completion Certificate. This period shall run concurrently with the maintenance period.
- g) Rates are to include for commissioning and testing of the complete installation and handing over in working order ready for use.
- h) Tenderers are advised to visit the site and acquaint themselves fully with the site conditions and nature and full extent of work involved prior to submitting their tender. Claims on the grounds of insufficient information in such respects or otherwise will not be entertained by the Administration.
- i) The Department of Health reserves the right to make emergency repairs to keep the equipment in operation without voiding the Contractor's Guarantee, nor relieving the Contractor of his responsibility during the guarantee period when, after proper notice, the Contractor fails to attend to such emergency repairs. All costs incurred by the Administration under these circumstances will be for the account of the Contractor.
- j) NOTE: All electrical equipment shall comply with NER Regulation of voltage.

5.2 Electrical Installation Details

Satisfactory Installation:

- a) All electrical work carried out will be neat and best class materials must be used. All wiring to conform to the SANS Code of Practice 10142 and will be subject to prior inspection and approval before acceptance.
- b) All necessary electrical power wiring and tubing between the distribution board and equipment installed by the Contractor shall be the responsibility of the Contractor.

- c) The Contractor shall submit the mandatory Certificate of Compliance. First delivery of this contract will not be taken until such time as this certificate is submitted to the Department of Health.

5.3 Safety and Risk Management

The Contractor shall observe all safety precautions during the installation and commissioning of all services as required by the OHS Act 85 of 1993 and supplier's installation manual.

5.4 Quality Requirements

- a) The installations shall be conducted by fully trained and certificated technicians. Certificates of technicians performing the works to be supplied.
- b) The client engineer or representative shall conduct inspections of the installations on completion. Quality documents shall be signed after a successful inspection.
- c) The supplier's or OEM's installation and test procedures shall be strictly adhered to.

5.5 Testing and Commissioning

All new equipment shall be tested, commissioned, ready for use and be maintained and guaranteed for a period of twelve (12) months.

Commissioning certificates shall be supplied before First Delivery of this contract is taken. All equipment to be supplied with nameplates showing the Technical Information as well as all the information as contemplated by the Occupational Health and Safety Act, 85 of 1993, as amended and its regulations, showing particularly the following information

- i. Manufacturer's name
- ii. Country of origin
- iii. Year of manufacture
- iv. Serial number
- v. Model number
- vi. Capacity

5.6 Maintenance Manuals

Two (2) sets of hard copy maintenance and operating manuals and electronic copy are required which shall include all circuit diagrams, spare parts lists, operating instructions, etc. one set of laminated wiring diagrams shall be fixed to the wall in the plant room. These sets of drawings shall be provided at the practical completion date and the Practical Completion Certificate will NOT be issued without these documents.

5.7 Maintenance and Servicing

The entire installation including all new equipment manufactured or bought is subject to an unrestricted 12-month free maintenance and guarantee period, after the date of issue of the Completion Certificate.

5.8 Completion

On completion of the works the Contractor shall submit all documentation of installed structure including however not limited to:

- a) Quality Control Plan, Contractor's Checklist, Punch List or Snag List
- b) All quality documentation shall be signed off by the client engineer or representative.

The Contractor shall in addition supply the following upon completion

- Electrical CoC, where applicable
- Plumbing CoC, where applicable
- Declaration of the structure being safe or sound based on construction.

6 THE SITE

The site is at Hospital, KwaZulu-Natal. Tenderers are encouraged to visit the site to ensure successful installation of the work required. Arrangements in this regard can be made with Maintenance Chief Artisan. Electrical Supply:

- 220V \pm 10%, Single Phase, 50 Hz
- 400V \pm 10%, Three phase, 50 Hz

7 PROGRAM OF WORKS

It is imperative that the installation be achieved with minimum interruption to the existing facility. The Contractor shall notify the institution seven (7) days prior to carrying out any site work. As the institution is to remain in full operation for the duration of the works, the works are to be planned and executed so as to cause minimum inconvenience to staff and visitors.

A program shall be submitted within 7 days prior to the commencement of any work for the approval by the Project Leader. No work will commence without the program of works having been approved by the Project Leader. The lists of documents that ARE returnable with the Quotation Documentation are:

Document Received	Yes/No
Program of Works	
Project Specific Health and Safety Plan	
Project Organogram	
Corrosion protection plan/certificate	

8 EVALUATION CRITERIA

The Bidder is to submit the following for evaluation purpose:

DOCUMENT	Note	Yes/No
Proof of CIDB Grading specified or higher.	Mandatory	
Financial Capability to start the project i.e. Letter from the bank confirming a working capital of at least 100 % of the project value.	Mandatory	
Certificates of qualified personnel (Plumber – Trade Tested).	Mandatory	
Certificates of qualified personnel (Electrician – Trade Tested).	Mandatory	
Certificates of qualified personnel (Builder – Trade Tested) or Welder for the construction of the structure.	Mandatory	
Bidder Organogram Specific to the project (Flu Clinic)	Mandatory	
Certificate of Conformity as per the Pressure Regulations	Mandatory	

Failure to submit any of the mandatory documents shall result in automatic disqualification.

9 SCHEDULE OF PRICES**PREAMBLE TO THE SCHEDULE OF PRICES**

- a) All prices shall be quoted in the currency of the Republic of South Africa and will be fixed. Only where exchange rates have been stated in the quotation document, as at two weeks (14 days) prior to closing date of this quotation, will such exchange rate fluctuation be taken into account in the variation of the cost of the imported items/equipment.
- b) The Tenderer shall enter a price against each item in the schedule of prices. If the Tenderer fails to enter a price against any item in the schedule of prices the relevant cost of such item shall be regarded as being covered by other prices in the schedule of prices.
- c) The prices quoted against each item of these schedules shall cover the full inclusive cost of everything required for the execution of the work under the item plus an apportionment of any cost involved in meeting the obligations and liabilities imposed by the conditions of contract and in complying with the specifications.
- d) The prices quoted for the supply of plant and equipment shall include for all handling, loading, transporting and off-loading required for the delivery of the plant and equipment to the site, including in the case of off-site storage for double handling at the store.
- e) The prices quoted for erection and installation shall include for all handling, loading, transporting and off-loading, to take plant and equipment to place on site where required, erection, installation, painting, commissioning, operating, testing, adjusting, handing over in proper working order and guarantee for a period of 12 months, all as specified.
- f) The tendered rates and amounts must exclude Value Added Tax (VAT) but must include all levies, other taxes and duties on items to which they apply. Separate provision has been made in the Summary of Schedule of Prices for the purpose of VAT.
- g) Amounts allowed for contingencies will be spent in part or as a whole at the sole discretion of the Department of Health's "Representative".
- h) The Schedule of Prices shall be completed and signed in black ink. Corrections must be done by deleting, re-writing and initialling next to the amendment.
- i) Electrical and Mechanical work is not measured according to the Standard Procedures of Building Work.

WORK TO BE DONE AND SCHEDULE OF RATES

Item	DESCRIPTION	UNIT	QTY	RATE/ UNIT		TOTAL	
				R	c	R	c
	NOTE: All rates for items contained in this Schedule of Prices must be computed excluding the applicable Sales Tax (Vat). The Administration reserves the right to Negotiate prices in the Bill of Quantities.						
	INSTITUTION: QUEEN NANDI REGIONAL HOSPITAL (EMPANGENI) SERVICE : SUPPLY AND INSTALLATION OF FLU CLINIC STRUCTURES						
	<u>ALL PREPARATIONS SHALL BE DONE ACCORDING TO THE STANDARD PREAMBLES</u>						
1)	Allow to remove all rubble from site and leave Queen Nandi Hospital site clean	item					
2)	Allow the Ramped Entrance for wheelchairs	item					
3)	10 m x 6 m structure including frame and partitioning. The flu complex structure shall be constructed of 76 mm x 76 mm x 1.6 mm thick galvanised square tubes. Height of the structure shall be 3.0 m. Refer to specification and figure 1 for more details.	Item					
4)	Steel structure ablution block 6 m (length) x 2.4 m (width) x 2.5 m (height) complete with sanware, electrical fittings, etc. Refer to specification and figure 1 for more details.	Item					
5)	Allow for asphaltting including reducing levels, layers works, compaction, etc.	m ²	94				
6)	Supply and install 77.7m ² A wooden board shall be laid over the elevated platform and vinyl sheeting shall be used to finish off the floor surface.	m ²	77.7				
7)	Supply and install galvanised steel and painted lipped channels of 150 mm x 50 mm x 20 mm x 2 mm shall be used for creation of the roof structure.	Item					
8)	Allow for ablution block to be constructed from a standard 6000 mm x 2400 mm container and partitioned	Item					
9)	Supply and install galvanised IBR sheeting on the walls made from painted IBR sheets of minimum 0.47 mm thickness coloured IBR roof sheeting. The galvanised sheets shall be coated with a primer and a top colour coat. Preferred colour of the IBR sheeting is cream white.	Item					
10)	The flu clinic complex shall be roofed with minimum 0.47 mm thick coloured IBR roof sheeting. The galvanised sheets shall be coated with a primer and a top colour coat.						
11)	Supply and install of 150 extraction fan window mounted: Based on 12 ACH = 480.6 m ³ /h = 133.5 l/s and based on 80 l/s/person = 576 m ³ /h = 160 l/s (based on two people). Selected size of extraction fan is 160 l/s = 576 m ³ /h at 55 Pa.	No	5				
12)	Supply and install PVC gutters and down corner pipes shall be installed to collect rain water from the roof.						
Carried To Collection Summary		PS 1				R	

Item	DESCRIPTION	UNIT	QTY	RATE/ UNIT		TOTAL	
				R	c	R	c
	Supply and install PTT 1212) aluminium window (Width: 1190 mm x Height: 1190 mm). 1 x consulting room, 1 x administration island and 3 x waiting area.	No	5				
	Allow to install 20mm PVC conduits, inspection box, compression glands, mounting screws	item					
	Supply and install 4.5 kg DCP fire extinguisher in the waiting area	No	1				
	Allow to put river sand before and after cable sleeve, water line and sewage line then G5 gravelling, compact and lay pavers back	item					
	Supply and install 210 Litres 70% Alcohol Sanitation desk mounted on 0.6m x 0.6m x 0.5m high welded steel desk. The pump must be operated by foot	m	1				
	Supply and install 36Watts Electronic ballast Dust proof fluorescent fitting double tube with tubes at waiting area, consulting room, administration island & covered entrance	No	7				
	Supply and install 2PL9 light fittings with tubes	No	7				
	Supply and install Vaal Wash Hand Basins complete with stainless steel waste and bottle traps refer to Fig. 1	No	7				
	Supply and install clip on steel structure close couple toilet	No	5				
	Supply and install 3Toilet roll holder	No	5				
	Supply and install Liquid soap dispenser refillable	No	7				
	Supply and Install 285mm x 130mm x 370mm Stainless steel Kleenex dispenser	No	7				
	Supply & install 350mm x 260mm x 390mm Stainless steel clip on bin	No	7				
	Supply & install 15mm Cobra Elbow Action Taps on wash hand basin	No	7				
	Dig a trench 65m x 0.6m x 0.6m deep and maintain fall	m	65				
	Supply & install 50m x 10mm ² 2Core ECC cable + glands	m	50				
	Supply and Install Stainless steel WHB waste fittings	No	7				
	Supply and Install PVC bottle trap	No	7				
	Supply and install 110mm Rodding eye	No	1				
	Supply and Install 110mm x 45° bend	No	1				
	Supply and Install 50mm x 90° PVC bend	No	15				
	Supply and Install 110mm x 50mm PVC Saddle	No	5				
Carried To Collection Summary PS 2						R	

Item	DESCRIPTION	UNIT	QTY	RATE/ UNIT		TOTAL	
				R	c	R	c
	Supply and install 50mm PVC Tee	No	5				
	Supply and Install 50mm PVC socket	No	4				
	Supply and Install 350mm braided connectors	No	12				
	Supply and Install 50mm PVC Y- Junction	No	5				
	Supply and Install 110mm Underground pipes	No	9				
	Supply and Install 110mm PVC Y-Junction	No	6				
	Supply and Install 110mm PVC Socket	No	6				
	Supply and Install 15A circuit breaker 5KA rating or bigger (Hega)	No	1				
	Supply and Install 20A circuit breaker 5KA rating or bigger (Hega)	No	1				
	Supply and Install 60A double pole isolator	No	1				
	Supply and Install 63A Earthleakage 5KA rating or bigger (Hega)	No	1				
	Supply and Install 63A Main switch 5KA ratings or bigger (Hega)	No	1				
	Supply and Install 12Way weather proof portable Kiosk lockable	No	1				
	Supply and Install 1Lever switch Crabtree	No	3				
	Supply and Install 16A double plug socket Crabtree	No	2				
	Supply and Install 2 x 4 PVC Switch box	No	3				
	Supply and Install 4 x 4 PVC plug socket box	No	2				
	Supply and Install 40 x 40mm cable black sleeve pipe	M	50				
	Supply and install light Masonite door	No	6				
	Supply and install 3mm Brass door Hinges	No	12				
	Supply and Install toilet Indicator bolt	No	5				
	Supply and Install Union Cylinder lock complete set	No	1				
	Supply and Install 2.5mm² Surfex cable for plug socket	M	30				
	Supply and Install 4 x 4 isolator box, 30A Isolator , 1 Extractor Fan, 30 A breaker Hega + cabling for Consulting room	item					
	Supply and install Extractor fan, 30A isolator + 4 x 4 box and cable in the waiting area	No	1				
	Supply and install extractor fan in the toilets: Two options i) extractor fan in each toilet ii) one suitable fan extracting from all five toilets	item .					
	Supply and Install 4 x 4 Isolator box	No	6				
	Supply and Install 4mm² Surfex cable for Extractor Fan	M	30				
	Supply and Install 600 x 600mm Frosted glass Aluminium windows in the toilets	No	5				
	Supply and Install Paraplegic toilet hand Rails	No	2				
	Supply and Install 400 x 800mm Mirror above Wash Hand Basin in (male, female & paraplegic toilet)	No	5				
	Supply and Install Perspex engraved Signage (1 x Consultation Room, 1 x Administration, 1 x Waiting Area, 1 x Sanitise Here, 1 x Ablution Block, 1 x Male sign, 3 x Female sign & 1 x wheel chair sign) some must be hanged	No	10				
	Allow the partitioning of the consultation room 4450 x 3500mm	No	1				
Carried To Collection Summary PS 3						R	

10 COMPLIANCE WITH REGULATIONS AND STANDARD SPECIFICATIONS

The operation, construction, material and components of the equipment, as specified, shall comply with the latest requirements of: The Occupational Health and Safety Act (Act 85, 1993) as amended.

- a) KwaZulu Natal Department of Health Policy Document of the Design of Mechanical Installations, Revision 7, January 2013.
- b) KwaZulu Natal Department of Health Policy Document of the Design of Electrical Installations, Revision 7, January 2013.
- c) KwaZulu Natal Provincial Administration Health Services General Electrical Specification, Revision 4, September 2003.
- d) KwaZulu Natal Department of Health Policy Document of the Design of Structural Installations, Revision 7, January 2013.
- e) KwaZulu Natal Department of Health Standard Preambles to All Trades, Revision 3, January 2009.
- f) SANS 10400: The application of the National Building Regulations
- g) SANS 10142: Code of Practice for Wiring of Premises
- h) Local Fire Regulations.
- i) The Municipal By-laws and any special requirements of the Supply Authorities of the area or district concerned.
- j) An Electrical Certificate of Compliance, in accordance with the OHS Act as amended, will be required for all Electrical Works.
- k) The Machinery and Occupational Safety Act - Act 6/1983
- l) All building works shall be in accordance with the Standard Preambles to All Trades.

The Contractor shall fully familiarise himself with these documents prior to quoting.

11 REVISION HISTORY TABLE

Table 1: Revision History Table

Date	Rev.	Compiler	Remarks
September 2020	0	B.N. Mathe	Final Specification