

SharePoint

Myoli Nolusizo ▾ ?



KWAZULU-NATAL PROVINCE
HEALTH
REPUBLIC OF SOUTH AFRICA

KZN HEALTH

KZN Health Intranet

Search this site



HOME CORPORATE INFORMATION COMPONENTS DIRECTORY DISTRICT OFFICES HEALTH FACILITIES

KZN Health > Components > Supply Chain Management

AdvertQuote



KWAZULU-NATAL PROVINCE
HEALTH
REPUBLIC OF SOUTH AFRICA

Quotation Advert

Opening Date: 2021-11-03

Closing Date: 2021-11-10

Closing Time: 11:00

INSTITUTION DETAILS

Institution Name: Harry Gwala EMS

Province: KwaZulu-Natal

Department or Entity: Department of Health

Division or section: Central Supply Chain Management

Place where goods / services is required Harry Gwala Health EMS Bases

Date Submitted 2021-11-02

ITEM CATEGORY AND DETAILS

Quotation Number: ZNQ:
HGD64/2021-22

Item Category: Goods

Item Description: Supply, delivery and install information board at Ixopo, Creighton and Underberg EMS Bases

Quantity (if supplies)

COMPULSORY BRIEFING SESSION / SITE VISIT

Select Type: Compulsory Briefing Session

Date : 2021-11-08

Time: 10:00

Venue: 111 Main Street, Ixopo, 3276

QUOTES CAN BE COLLECTED FROM:

QUOTES SHOULD BE DELIVERED TO: 111 Main Street, Ixopo, 3276/HarryGwalaDO.scm@kznhealth.gov.za

ENQUIRIES REGARDING THE ADVERT MAY BE DIRECTED TO:

Name: Miss N.M Myoli

Email: nolusizo.myoli@kznhealth.gov.za

Contact Number: 039 834 8291/8290

Finance Manager Name:

Miss N.G Phakathi

Finance Manager Signature:



No late quotes will be considered

OFFICIAL PRICE PAGE FOR QUOTATIONS

QUOTE NUMBER: HGD64/2021-22

DESCRIPTION: Supply, delivery and install information board at Ixopo, Creighton and Underberg EMS bases

SIGNATURE OF BIDDER DATE.....
 [By signing this document, I hereby agree to all terms and conditions]

CAPACITY UNDER WHICH THIS QUOTE IS SIGNED.....

Item No	Quantity	Description	Brand & model	Country of manufacture	Price	
					R	c
01	item	Supply, delivery and install information board at Ixopo, Creighton and Underberg EMS bases				
		compulsory site briefing:				
		Date: 08/11/2021				
		Venue: 111 Main Street, Ixopo, 3276				
		Harry Gwala Health District Office				
		Time: 10:00				
		Detailed specification attached				
		PLEASE SUBMIT THE FOLLOWING DOCUMENTS:				
		1.Declaration of interest SBD4				
		2.Certificate of independent Bid Determination SBD9				
		3.Proof of registration on the central suppliers database (CSD registration number and unique registration reference)				
		CIDB Grading: 1GB and above				
VALUE ADDED TAX @ 15% (Only if VAT Vendor)						
TOTAL QUOTATION PRICE (VALIDITY PERIOD 60 Days)						

Does This Offer Comply With The Specification?	Does The Article Conform To The S.A.N.S. / S.A.B.S. Specification?
Is The Price Firm?	State Delivery Period, e.g., 1day, 1week

<p>Enquiries regarding the <u>quote</u> may be directed to:</p> <p>Contact Person: <u>N.M Myoli</u> Tel: <u>0398348290/91</u></p> <p>E-Mail Address: <u>nolusizo.myoli@kznhealth.gov.za</u></p>	<p>Enquiries regarding <u>technical information</u> may be directed to:</p> <p>Contact Person: <u>C.B Ngcobo</u> Tel: <u>0398348275</u></p>
--	--

DECLARATION OF INTEREST

1. Any legal person, including persons employed by the state¹, or persons having a kinship with persons employed by the state, including a blood relationship, may make an offer or offers in terms of this invitation to quote (includes a price quotation, advertised competitive quote, limited quote or proposal). In view of possible allegations of favouritism, should the resulting quote, or part thereof, be awarded to persons employed by the state or to persons connected with or related to them, it is required that the bidder or his/her authorised representative declare his/her position in relation to the evaluating/adjudicating authority where-
 - the bidder is employed by the state; and/or
 - the legal person on whose behalf the bidding document is signed, has a relationship with persons/a person who are/is involved in the evaluation and or adjudication of the quote(s), or where it is known that such a relationship exists between the person or persons for or on whose behalf the declarant acts and persons who are involved with the evaluation and or adjudication of the quote.
2. In order to give effect to the above, the following questionnaire must be completed and submitted with the quote.

- 2.1. Full Name of bidder/representative.....
- 2.2. Identity Number:.....
- 2.3. Position occupied in the Company (director, trustee, shareholder²):.....
- 2.4. Company Registration Number:.....
- 2.5. Tax Reference Number:.....
- 2.6. VAT Registration Number:.....

2.7. The names of all directors / trustees / shareholders / members, their individual identity numbers, tax reference numbers and, if applicable, employee / persal numbers must be indicated in paragraph 3 below. [TICK APPLICABLE]

2.8. Are you or any person connected with the bidder presently employed by the state? YES NO

2.8.1. If so, furnish the following particulars:
 Name of person / director / trustee / shareholder/ member:
 Name of state institution at which you or the person connected to the bidder is employed:.....
 Position occupied in the state institution: Any other particulars:.....

2.8.2. If you are presently employed by the state, did you obtain the appropriate authority to undertake remunerative work outside employment in the public sector? YES NO

2.8.2.1. If yes, did you attach proof of such authority to the quote document?

(Note: Failure to submit proof of such authority, where applicable, may result in the disqualification of the quote.)

2.8.2.2. If no, furnish reasons for non-submission of such proof:

2.9. Did you or your spouse, or any of the company's directors / trustees / shareholders / members or their spouses conduct business with the state in the previous twelve months? YES NO

2.9.1. If so, furnish particulars:.....

2.10. Do you, or any person connected with the bidder, have any relationship (family, friend, other) with a person employed by the state and who may be involved with the evaluation and or adjudication of this quote? YES NO

2.10.1. If so, furnish particulars:.....

2.11. Are you, or any person connected with the bidder, aware of any relationship (family, friend, other) between any other bidder and any person employed by the state who may be involved with the evaluation and or adjudication of this quote? YES NO

2.11.1. If so, furnish particulars:.....

2.12. Do you or any of the directors / trustees / shareholders / members of the company have any interest in any other related companies whether or not they are bidding for this contract? YES NO

2.12.1. If so, furnish particulars:.....

3. Full details of directors / trustees / members / shareholders.

NB: The Department Of Health will validate details of directors / trustees / members / shareholders on CSD. It is the suppliers' responsibility to ensure that their details are up-to-date and verified on CSD. If the Department cannot validate the information on CSD, the quote will not be considered and passed over as non-compliant according to National Treasury Instruction Note 4 (a) 2016/17.

4 DECLARATION

I, THE UNDERSIGNED (NAME).....CERTIFY THAT THE INFORMATION FURNISHED IN PARAGRAPHS 2.

I ACCEPT THAT THE STATE MAY REJECT THE QUOTE OR ACT AGAINST ME SHOULD THIS DECLARATION PROVE TO BE FALSE.

..... Name of bidder Signature Position Date
-------------------------	--------------------	-------------------	---------------

"State" means –

- | | |
|---|---|
| a) any national or provincial department, national or provincial public entity or constitutional institution within the meaning of the Public Finance Management Act, 1999 (Act No. 1 of 1999); | c) provincial legislature; |
| b) any municipality or municipal entity; | d) national Assembly or the national Council of provinces; or |
| | e) Parliament. |

"Shareholder" means a person who owns shares in the company and is actively involved in the management of the enterprise or business and exercises control over the enterprise.

SPECIAL CONTRACT CONDITIONS OF QUOTATIONS

1. AMENDMENT OF CONTRACT

- 1.1. Any amendment to or renunciation of the provisions of the contract shall at all times be done in writing and shall be signed by both parties.

2. CHANGE OF ADDRESS

- 2.1. Bidders must advise the Department of Health (institution where the offer was submitted) should their address (*domicilium citandi et executandi*) details change from the time of bidding to the expiry of the contract.

3. GENERAL CONDITIONS ATTACHED TO THIS QUOTATION

- 3.1. The Department is under no obligation to accept the lowest or any quote.
- 3.2. The Department reserves the right to communicate in writing with vendors in cases where information is incomplete or where there are obscurities regarding technical aspects of the offer, to obtain confirmation of prices or preference claims in cases where it is evident that a typing, written, transfer or unit error has been made, to investigate the vendor's standing and ability to complete the supply/service satisfactorily.
- 3.3. **ALL DECISIONS TAKEN BY THE DEPARTMENT ARE FINAL, INCLUDING THE AWARD OF THIS QUOTATION.**
- 3.4. The price quoted must include VAT (if VAT vendor). However, it must be noted that the Department reserves the right to evaluate all quotations excluding VAT as some bidders may not be VAT vendors.
- 3.5. The bidder must ensure the correctness & validity of the quotation:
- (i) *that the price(s), rate(s) & preference quoted cover all for the work/item (s) & accept that any mistakes regarding the price (s) & calculations will be at the bidder's risk*
 - (ii) *it is the responsibility of the bidder to confirm receipt of their quotation and to keep proof thereof.*
- 3.6. The bidder must accept full responsibility for the proper execution & fulfilment of all obligations conditions devolving on under this agreement, as the Principal (s) liable for the due fulfilment of this contract.
- 3.7. This quotation will be evaluated based on the 80/20 points system, specification, correctness of information and/or functionality criteria. All required documentation must be completed in full and submitted.
- 3.8. Offers must comply strictly with the specification.
- 3.9. Only offers that meet or are greater than the specification will be considered.
- 3.10. Late offers will not be considered.
- 3.11. Expired product/s will not be accepted. All products supplied must be valid for a minimum period of six months.
- 3.12. Used/ second-hand products will not be accepted.
- 3.13. A bidder not registered on the Central Suppliers Database or whose verification has failed will not be considered.
- 3.14. All delivery costs must be included in the quoted price for delivery at the prescribed destination.
- 3.15. Only firm prices will be accepted. Such prices must remain firm for the contract period. Non-firm prices (including rates of exchange variations) will not be considered.
- 3.16. In cases where different delivery points influence the pricing, a separate pricing schedule must be submitted for each delivery point.
- 3.17. In the event of a bidder having multiple quotes, only the cheapest according to specification will be considered.
- 3.18. Verification will be conducted to identify if bidders have multiple companies and are cover-quoting for this bid.
- 3.19. In such instances, the Department reserves the right to immediately disqualify such bidders as cover-quoting is an offence that represents both corruption and acquisition fraud.

4. SPECIAL INSTRUCTIONS AND NOTICES TO BIDDERS REGARDING THE COMPLETION OF THIS QUOTATION.

- 4.1. Unless inconsistent with or expressly indicated otherwise by the context, the singular shall include the plural and vice versa and with words importing the masculine gender shall include the feminine and the neuter.
- 4.2. Under no circumstances whatsoever may the quotation/bid forms be retyped or redrafted. Photocopies of the original bid documentation may be used, but an original signature must appear on such photocopies.
- 4.3. The bidder is advised to check the number of pages and to satisfy himself that none are missing or duplicated.
- 4.4. Quotations submitted must be complete in all respects. However, where it is identified that information in a bidder's response is incomplete in any respect, the said supplier meets all specification requirements and is lowest to quote, the Department reserves the right to request the bidder to complete/submit such information.
- 4.5. Any alteration made by the bidder must be initialled; failure to do so may render the response invalid.
- 4.6. Use of correcting fluid is prohibited and may render the response invalid.
- 4.7. Quotations will be opened in public as soon as practicable after the closing time of quotation.
- 4.8. Where practical, prices are made public at the time of opening quotations.
- 4.9. If it is desired to make more than one offer against any individual item, such offers should be given on a photocopy of the page in question. Clear indication thereof must be stated on the schedules attached.
- 4.10. The Department is under no obligation to pay suppliers in part for work done if the supplier can no longer for fulfil their obligation.

5. SPECIAL INSTRUCTIONS REGARDING HAND DELIVERED QUOTATIONS

- 5.1. Quotation shall be lodged at the address indicated not later than the closing time specified for their receipt, and in accordance with the directives in the quotation documents.
- 5.2. Each quotation shall be addressed in accordance with the directives in the quotation documents and shall be lodged in a separate sealed envelope, with the name and address of the bidder, the quotation number and closing date indicated on the envelope. The envelope shall not contain documents relating to any quotation other than that shown on the envelope. If this provision is not complied with, such quotations/bids may be rejected as being invalid.
- 5.3. All quotations received in sealed envelopes with the relevant quotation numbers on the envelopes are kept unopened in safe custody until the closing time of the quotation/bids. Where, however, a quotation is received open, it shall be sealed. If it is received without a quotation/bid number on the envelope, it shall be opened, the quotation number ascertained, the envelope sealed and the quotation number written on the envelope.
- 5.4. A specific box is provided for the receipt of quotations, and no quotation found in any other box or elsewhere subsequent to the closing date and time of quotation will be considered.
- 5.5. No quotation/bid sent through the post will be considered if it is received after the closing date and time stipulated in the quotation documentation, and proof of posting will not be accepted as proof of delivery.
- 5.6. Quotation documents must not be included in packages containing samples. Such quotations may be rejected as being invalid.

6. SAMPLES

- 6.1. In the case of the quote document stipulating that samples are required, the supplier will be informed in due course when samples should be provided to the institution. (This decreases the time of safety and storage risk that may be incurred by the respective institution). The bidders sample will be retained if such bidder wins the contract.
 - (i) If a company/s who has not won the quote requires their samples, they must advise the institution in writing of such.
 - (ii) If samples are not collected within three months of close of quote the institution reserves the right to dispose of them at their discretion.
- 6.2. **Samples must be made available when requested in writing or if stipulated on the document.**
 - (i) If a Bidder fails to provide a sample of their product on offer for scrutiny against the set specification when requested, their offer will be rejected. All testing will be for the account of the bidder.

7. COMPULSORY SITE INSPECTION / BRIEFING SESSION

7.1. Bidders who fail to attend the compulsory meeting will be disqualified from the evaluation process.

- (i) The institution has determined that a compulsory site meeting take place
- (ii) Date 08 / 11 / 2021 Time 10 : 00 Place 111 Main Street, Ixopo, 3276

Institution Stamp:	Institution Site Inspection / briefing session Official Full Name: Signature: Date:
--------------------	--

8. STATEMENT OF SUPPLIES AND SERVICES

8.1. The contractor shall, when requested to do so, furnish particulars of supplies delivered or services executed. If he/she fails to do so, the Department may, without prejudice to any other rights which it may have, institute inquiries at the expense of the contractor to obtain the required particulars.

9. SUBMISSION AND COMPLETION OF SBD 6.1

9.1. Should a bidder wish to qualify for preference points they must complete a SBD 6.1 document. Failure by a bidder to provide all relevant information required, will result in such a bidder not being considered for preference point's allocation. The preferences applicable on the closing date will be utilized. Any changes after the closing date will not be considered for that particular quote.

10. TAX COMPLIANCE REQUIREMENTS

- 10.1. In the event that the tax compliance status has failed on CSD, **it is the suppliers' responsibility to provide a SARS pin in order for the institution to validate the tax compliance status of the supplier.**
- 10.2. In the event that the institution cannot validate the suppliers' tax clearance on SARS as well as the Central Suppliers Database, **the quote will not be considered and passed over as non-compliant according to National Treasury Instruction Note 4 (a) 2016/17.**

11. TAX INVOICE

11.1. A tax invoice shall be in the currency of the Republic of South Africa and shall contain the following particulars:

- | | |
|--|--|
| (i) the name, address and registration number of the supplier; | (iv) a description and quantity or volume of the goods or services supplied; |
| (ii) the name and address of the recipient; | (v) the official department order number issued to the supplier; |
| (iii) an individual serialized number and the date upon which the tax invoice is issued; | (vi) the value of the supply, the amount of tax charged; |
| | (vii) the words tax invoice in a prominent place. |

12. PATENT RIGHTS

The supplier shall indemnify the **KZN Department of Health** (hereafter known as the purchaser) against all third-party claims of infringement of patent, trademark, or industrial design rights arising from use of the goods or any part thereof by the purchaser.

13. PENALTIES

- 13.1. If at any time during the contract period, the service provider is unable to perform in a timely manner, the service provider must notify the institution in writing/email of the cause of and the duration of the delay. Upon receipt of the notification, the institution should evaluate the circumstances and, if deemed necessary, the institution may extend the service provider's time for performance.
- 13.2. In the event of delayed performance that extends beyond the delivery period, the institution is entitled to purchase commodities of a similar quantity and quality as a substitution for the outstanding commodities, without terminating the contract, as well as return commodities delivered at a later stage at the service provider's expense.
- 13.3. Alternatively, the institution may elect to terminate the contract and procure the necessary commodities in order to complete the contract. In the event that the contract is terminated the institution may claim damages from the service provider in the form of a penalty. The service provider's performance should be captured on the service provider database in order to determine whether or not the service provider should be awarded any contracts in the future.
- 13.4. If the supplier fails to deliver any or all of the goods or to perform the services within the period(s) specified in the contract, the purchaser shall, without prejudice to its other remedies under the contract, deduct from the contract price, as a penalty, a sum calculated on the delivered price of the delayed goods or unperformed services using the current prime interest rate calculated for each day of the delay until actual delivery or performance.

14. TERMINATION FOR DEFAULT

- 14.1. The purchaser, without prejudice to any other remedy for breach of contract, by written notice of default sent to the supplier, may terminate this contract in whole or in part:
- (i) if the supplier fails to deliver any or all of the goods within the period(s) specified in the contract,
 - (ii) if the supplier fails to perform any other obligation(s) under the contract; or
 - (iii) if the supplier, in the judgment of the purchaser, has engaged in corrupt or fraudulent practices in competing for or in executing the contract.
- 14.2. In the event the purchaser terminates the contract in whole or in part, the purchaser may procure, upon such terms and in such manner as it deems appropriate, goods, works or services similar to those undelivered, and the supplier shall be liable to the purchaser for any excess costs for such similar goods, works or services.
- 14.3. Where the purchaser terminates the contract in whole or in part, the purchaser may decide to impose a restriction penalty on the supplier by prohibiting such supplier from doing business with the public sector for a period not exceeding 10 years.

15. FAILURE TO COMPLY WITH ABOVE WILL RESULT IN YOUR QUOTE BEING PASSED OVER.

PREFERENCE POINTS CLAIM FORM IN TERMS OF THE PREFERENTIAL PROCUREMENT REGULATIONS 2017

This preference form must form part of all quotes invited. It contains general information and serves as a claim form for preference points for Broad-Based Black Economic Empowerment (B-BBEE) Status Level of Contribution

NB: BEFORE COMPLETING THIS FORM, BIDDERS MUST STUDY THE GENERAL CONDITIONS, DEFINITIONS AND DIRECTIVES APPLICABLE IN RESPECT OF B-BBEE, AS PRESCRIBED IN THE PREFERENTIAL PROCUREMENT REGULATIONS, 2017.

1. GENERAL CONDITIONS

1.1 The following preference point systems are applicable to all quotes:

- the 80/20 system for requirements with a Rand value of up to R50 000 000 (all applicable taxes included); and

1.2 The value of this quote is estimated to not exceed R50 000 000 (all applicable taxes included) and therefore the 80/20 preference point system shall be applicable.

1.3 Points for this quote shall be awarded for:

- (a) Price; and
- (b) B-BBEE Status Level of Contributor.

1.4 The maximum points for this quote is allocated as follows:

	POINTS
PRICE	80
B-BBEE STATUS LEVEL OF CONTRIBUTOR	20
Total points for Price and B-BBEE must not exceed	100

1.5 Failure on the part of a bidder to submit proof of B-BBEE Status level of contributor together with the quote, will be interpreted to mean that preference points for B-BBEE status level of contribution are not claimed.

1.6 The purchaser reserves the right to require of a bidder, either before a quote is adjudicated or at any time subsequently, to substantiate any claim in regard to preferences, in any manner required by the purchaser.

2. DEFINITIONS

- (a) **"B-BBEE"** means broad-based black economic empowerment as defined in section 1 of the Broad-Based Black Economic Empowerment Act;
- (b) **"B-BBEE status level of contributor"** means the B-BBEE status of an entity in terms of a code of good practice on black economic empowerment, issued in terms of section 9(1) of the Broad-Based Black Economic Empowerment Act;
- (c) **"bid"** means a written offer in a prescribed or stipulated form in response to an invitation by an organ of state for the provision of goods or services, through price quotations, advertised competitive bidding processes or proposals;
- (d) **"Broad-Based Black Economic Empowerment Act"** means the Broad-Based Black Economic Empowerment Act, 2003 (Act No. 53 of 2003);
- (e) **"EME"** means an Exempted Micro Enterprise in terms of a code of good practice on black economic empowerment issued in terms of section 9 (1) of the Broad-Based Black Economic Empowerment Act;
- (f) **"functionality"** means the ability of a tenderer to provide goods or services in accordance with specifications as set out in the tender documents.
- (g) **"prices"** includes all applicable taxes less all unconditional discounts;
- (h) **"proof of B-BBEE status level of contributor"** means:
 - 1) B-BBEE Status level certificate issued by an authorized body or person;
 - 2) A sworn affidavit as prescribed by the B-BBEE Codes of Good Practice;
 - 3) Any other requirement prescribed in terms of the B-BBEE Act;
- (i) **"QSE"** means a qualifying small business enterprise in terms of a code of good practice on black economic empowerment issued in terms of section 9 (1) of the Broad-Based Black Economic Empowerment Act;
- (j) **"rand value"** means the total estimated value of a contract in Rand, calculated at the time of bid invitation, and includes all applicable taxes;

3. POINTS AWARDED FOR PRICE

3.1 THE 80/20 PREFERENCE POINT SYSTEMS

A maximum of 80 points is allocated for price on the following basis:

$$P_s = 80 \left(1 - \frac{P_t - P_{\min}}{P_{\min}} \right) \text{ Where}$$

- P_s = Points scored for price of bid under consideration
- P_t = Price of bid under consideration
- P_{min} = price of lowest acceptable bid

4. POINTS AWARDED FOR B-BBEE STATUS LEVEL OF CONTRIBUTOR

4.1 In terms of Regulation 6 (2) and 7 (2) of the Preferential Procurement Regulations, preference points must be awarded to a bidder for attaining the B-BBEE status level of contribution in accordance with the table below:

B-BBEE Status Level of Contributor	Number of points (80/20 system)
1	20
2	18
3	14
4	12
5	8
6	6
7	4
8	2
Non-compliant contributor	0

5. BID DECLARATION

5.1 Bidders who claim points in respect of B-BBEE Status Level of Contribution must complete the following:

6. B-BBEE STATUS LEVEL OF CONTRIBUTOR CLAIMED IN TERMS OF PARAGRAPHS 1.4 AND 4.1

6.1 B-BBEE Status Level of Contributor: =(maximum of 20 points)

(Points claimed in respect of paragraph 7.1 must be in accordance with the table reflected in paragraph 4.1 and must be substantiated by relevant proof of B-BBEE status level of contributor.

7. SUB-CONTRACTING applicable box

(Tick

YES		NO	
-----	--	----	--

7.1 Will any portion of the contract be sub-contracted?

7.1.1 If yes, indicate:

- i) What percentage of the contract will be subcontracted.....%
- ii) The name of the sub-contractor.....
- iii) The B-BBEE status level of the sub-contractor.....

8. Whether the sub-contractor is an EME or QSE

(Tick applicable box)

iv) Specify, by ticking the appropriate box, if subcontracting with an enterprise in terms of Preferential Procurement Regulations,2017:

YES		NO	
-----	--	----	--

Designated Group: An EME or QSE which is at last 51% owned by:	EME	QSE
Black people	√	√
Black people who are youth		
Black people who are women		
Black people with disabilities		
Black people living in rural or underdeveloped areas or townships		
Cooperative owned by black people		
Black people who are military veterans		
OR		
Any EME		

Any QSE		
---------	--	--

9. **DECLARATION WITH REGARD TO COMPANY/FIRM**

9.1 Name of company/firm:.....

9.2 VAT registration number:.....

9.3 Company registration number:.....

9.4 **TYPE OF COMPANY/ FIRM [TICK APPLICABLE BOX]**

- Partnership/Joint Venture / Consortium
- One person business/sole propriety
- Close corporation
- Company
- (Pty) Limited

9.5 **DESCRIBE PRINCIPAL BUSINESS ACTIVITIES**

.....

9.6 **COMPANY CLASSIFICATION [TICK APPLICABLE BOX]**

- Manufacturer
- Supplier
- Professional service provider
- Other service providers, e.g. transporter, etc.

9.7 Total number of years the company/firm has been in business:.....

9.8 I/we, the undersigned, who is / are duly authorised to do so on behalf of the company/firm, certify that the points claimed, based on the B-BBE status level of contributor indicated in paragraphs 1.4 and 6.1 of the foregoing certificate, qualifies the company/ firm for the preference(s) shown and I / we acknowledge that:

- i) The information furnished is true and correct;
- ii) The preference points claimed are in accordance with the General Conditions as indicated in paragraph 1 of this form;
- iii) In the event of a contract being awarded as a result of points claimed as shown in paragraphs 1.4 and 6.1, the contractor may be required to furnish documentary proof to the satisfaction of the purchaser that the claims are correct;
- iv) If the B-BBEE status level of contributor has been claimed or obtained on a fraudulent basis or any of the conditions of contract have not been fulfilled, the purchaser may, in addition to any other remedy it may have –
 - (a) disqualify the person from the bidding process;
 - (b) recover costs, losses or damages it has incurred or suffered as a result of that person's conduct;
 - (c) cancel the contract and claim any damages which it has suffered as a result of having to make less favourable arrangements due to such cancellation;
 - (d) recommend that the bidder or contractor, its shareholders and directors, or only the shareholders and directors who acted on a fraudulent basis, be restricted by the National Treasury from obtaining business from any organ of state for a period not exceeding 10 years, after the *audi alteram partem* (hear the other side) rule has been applied; and
 - (e) forward the matter for criminal prosecution.

<p>WITNESSES</p> <p>1.</p> <p>2.</p>

<p>.....</p> <p>SIGNATURE(S) OF BIDDERS(S)</p> <p>DATE:</p> <p>ADDRESS:.....</p> <p>.....</p> <p>.....</p>

**KWAZULU-NATAL PROVINCE**HEALTH
REPUBLIC OF SOUTH AFRICAPrivate Bag X 502, Ixopo, 3276
Tel.: 039 834 8291 /, Fax.: 039 834 1332
Email.: nolusizo.myoli@kznhealth.gov.za
www.kznhealth.gov.zaSUPPLY CHAIN
MANAGEMENTDate : 03/11/2021
ZNQ Number: HGD64/2021-22**ITEM SPECIFICATION AND TERMS OF REFERENCE**

ZNQ NUMBER	DESCRIPTION OF ITEM	DETAILED SPECIFICATION	QUANTITY REQUIRED
HGD64/2021-22	Supply, delivery and install information board at Ixopo, Creighton and Underberg EMS bases	detailed specification attached	item

SPECIAL TERMS AND CONDITIONS

1. Only bidders that fully meet the specification shall be considered.
2. The institution is under no obligation to accept the lowest or any quote.
3. The quality of products must be SABS/SANS/CKS approved and a certificate of compliance must be submitted when required
4. The bidder must ensure the correctness and validity of the quote: the prices, rates & preference quoted cover all of the work and accept that any mistakes regarding with the price calculations will be at the bidder's risk.
5. If the information supplied is found to be incorrect or false then the KZN Department of Health, in addition to any remedies it may have, may recover from the contractor all cost, losses and damages incurred by Department as a result of the award of the contract, and /or cancel the contract and claim any damages .
6. Defaulting suppliers in terms of delivering, will be dealt with and will be reported at Treasury
7. The evaluation criteria for the quotation above R30000 will be 80/20 for price and points, certified BBEEE certificates and original tax clearance.
8. Incomplete declaration of interest and quotation form will not be considered
9. Orders will be cancelled if the supplier fail to meet the set standards and lead time
10. **NB Suppliers must submit the central suppliers data base copies for the easy reference**

DECLARATION OF INTEREST

1. Any legal person, including persons employed by the state¹, or persons having a kinship with persons employed by the state, including a blood relationship, may make an offer or offers in terms of this invitation to bid (includes a price quotation, advertised competitive bid, limited bid or proposal). In view of possible allegations of favouritism, should the resulting bid, or part thereof, be awarded to persons employed by the state, or to persons connected with or related to them, it is required that the bidder or his/her authorised representative declare his/her position in relation to the evaluating/adjudicating authority where-
 - the bidder is employed by the state; and/or
 - the legal person on whose behalf the bidding document is signed, has a relationship with persons/a person who are/is involved in the evaluation and or adjudication of the bid(s), or where it is known that such a relationship exists between the person or persons for or on whose behalf the declarant acts and persons who are involved with the evaluation and or adjudication of the bid.

2. **In order to give effect to the above, the following questionnaire must be completed and submitted with the bid.**
 - 2.1 Full Name of bidder or his or her representative:
 - 2.2 Identity Number:
 - 2.3 Position occupied in the Company (director, trustee, shareholder²):
 - 2.4 Company Registration Number:
 - 2.5 Tax Reference Number:
 - 2.6 VAT Registration Number:
 - 2.6.1 The names of all directors / trustees / shareholders / members, their individual identity numbers, tax reference numbers and, if applicable, employee / persal numbers must be indicated in paragraph 3 below.

¹"State" means –

- (a) any national or provincial department, national or provincial public entity or constitutional institution within the meaning of the Public Finance Management Act, 1999 (Act No. 1 of 1999);
- (b) any municipality or municipal entity;
- (c) provincial legislature;
- (d) national Assembly or the national Council of provinces; or
- (e) Parliament.

²"Shareholder" means a person who owns shares in the company and is actively involved in the management of the enterprise or business and exercises control over the enterprise.

2.7 Are you or any person connected with the bidder presently employed by the state? **YES / NO**

2.7.1 If so, furnish the following particulars:

Name of person / director / trustee / shareholder/ member:
Name of state institution at which you or the person connected to the bidder is employed :
Position occupied in the state institution:

Any other particulars:
.....
.....
.....

2.7.2 If you are presently employed by the state, did you obtain the appropriate authority to undertake remunerative work outside employment in the public sector? **YES / NO**

2.7.2.1 If yes, did you attached proof of such authority to the bid document? **YES / NO**

(Note: Failure to submit proof of such authority, where applicable, may result in the disqualification of the bid.

2.7.2.2 If no, furnish reasons for non-submission of such proof:
.....
.....
.....

2.8 Did you or your spouse, or any of the company's directors / trustees / shareholders / members or their spouses conduct business with the state in the previous twelve months? **YES / NO**

2.8.1 If so, furnish particulars:
.....
.....
.....

2.9 Do you, or any person connected with the bidder, have any relationship (family, friend, other) with a person employed by the state and who may be involved with the evaluation and or adjudication of this bid? **YES / NO**

2.9.1 If so, furnish particulars.

4 DECLARATION

I, THE UNDERSIGNED (NAME).....

CERTIFY THAT THE INFORMATION FURNISHED IN PARAGRAPHS 2 and 3 ABOVE IS CORRECT. I ACCEPT THAT THE STATE MAY REJECT THE BID OR ACT AGAINST ME IN TERMS OF PARAGRAPH 23 OF THE GENERAL CONDITIONS OF CONTRACT SHOULD THIS DECLARATION PROVE TO BE FALSE.

.....
Signature

.....
Date

.....
Position

.....
Name of bidder

SECTION M

CERTIFICATE OF INDEPENDENT BID DETERMINATION

- 1 This Standard Bidding Document (SBD) must form part of all bids¹ invited.
- 2 Section 4 (1) (b) (iii) of the Competition Act No. 89 of 1998, as amended, prohibits an agreement between, or concerted practice by, firms, or a decision by an association of firms, if it is between parties in a horizontal relationship and if it involves collusive bidding (or bid rigging).² Collusive bidding is a *pe se* prohibition meaning that it cannot be justified under any grounds.
- 3 Treasury Regulation 16A9 prescribes that accounting officers and accounting authorities must take all reasonable steps to prevent abuse of the supply chain management system and authorizes accounting officers and accounting authorities to:
 - a. disregard the bid of any bidder if that bidder, or any of its directors have abused the institution's supply chain management system and or committed fraud or any other improper conduct in relation to such system.
 - b. cancel a contract awarded to a supplier of goods and services if the supplier committed any corrupt or fraudulent act during the bidding process or the execution of that contract.
- 4 This SBD serves as a certificate of declaration that would be used by institutions to ensure that, when bids are considered, reasonable steps are taken to prevent any form of bid-rigging.
- 5 In order to give effect to the above, the attached Certificate of Bid Determination (SBD 9) must be completed and submitted with the bid:

¹ Includes price quotations, advertised competitive bids, limited bids and proposals.

² Bid rigging (or collusive bidding) occurs when businesses, that would otherwise be expected to compete, secretly conspire to raise prices or lower the quality of goods and / or services for purchasers who wish to acquire goods and / or services through a bidding process. Bid rigging is, therefore, an agreement between competitors not to compete.

CERTIFICATE OF INDEPENDENT BID DETERMINATION

I, the undersigned, in submitting the accompanying bid:

(Bid Number and Description)

in response to the invitation for the bid made by:

(Name of Institution)

do hereby make the following statements that I certify to be true and complete in every respect:

I certify, on behalf of: _____ that:

(Name of Bidder)

1. I have read and I understand the contents of this Certificate;
2. I understand that the accompanying bid will be disqualified if this Certificate is found not to be true and complete in every respect;
3. I am authorized by the bidder to sign this Certificate, and to submit the accompanying bid, on behalf of the bidder;
4. Each person whose signature appears on the accompanying bid has been authorized by the bidder to determine the terms of, and to sign the bid, on behalf of the bidder;
5. For the purposes of this Certificate and the accompanying bid, I understand that the word "competitor" shall include any individual or organization, other than the bidder, whether or not affiliated with the bidder, who:
 - (a) has been requested to submit a bid in response to this bid invitation;
 - (b) could potentially submit a bid in response to this bid invitation, based on their qualifications, abilities or experience; and
 - (c) provides the same goods and services as the bidder and/or is in the same line of business as the bidder

6. The bidder has arrived at the accompanying bid independently from, and without consultation, communication, agreement or arrangement with any competitor. However communication between partners in a joint venture or consortium³ will not be construed as collusive bidding.
7. In particular, without limiting the generality of paragraphs 6 above, there has been no consultation, communication, agreement or arrangement with any competitor regarding:
 - (a) prices;
 - (b) geographical area where product or service will be rendered (market allocation)
 - (c) methods, factors or formulas used to calculate prices;
 - (d) the intention or decision to submit or not to submit, a bid;
 - (e) the submission of a bid which does not meet the specifications and conditions of the bid; or
 - (f) bidding with the intention not to win the bid.
8. In addition, there have been no consultations, communications, agreements or arrangements with any competitor regarding the quality, quantity, specifications and conditions or delivery particulars of the products or services to which this bid invitation relates.
9. The terms of the accompanying bid have not been, and will not be, disclosed by the bidder, directly or indirectly, to any competitor, prior to the date and time of the official bid opening or of the awarding of the contract.

³ Joint venture or Consortium means an association of persons for the purpose of combining their expertise, property, capital, efforts, skill and knowledge in an activity for the execution of a contract.

10. I am aware that, in addition and without prejudice to any other remedy provided to combat any restrictive practices related to bids and contracts, bids that are suspicious will be reported to the Competition Commission for investigation and possible imposition of administrative penalties in terms of section 59 of the Competition Act No 89 of 1998 and or may be reported to the National Prosecuting Authority (NPA) for criminal investigation and or may be restricted from conducting business with the public sector for a period not exceeding ten (10) years in terms of the Prevention and Combating of Corrupt Activities Act No 12 of 2004 or any other applicable legislation.

.....
Signature

.....
Date

.....
Position

.....
Name of Bidder

**PROVINCE OF KWAZULU-NATAL
DEPARTMENT OF HEALTH**

ZNQ –

**EMS BASE CREIGHTON – SUPPLY, DELIVER AND INSTALL INFORMATION
BOARD AT EMS BASE CREIGHTON.**

1.1 SCOPE OF CONTRACT

This Contract is for the execution of the project indicated above.

1.2 CONTRACT DRAWINGS

These specifications and bill of quantities must be read in conjunction with drawings attached

1.3 CONDITIONS OF CONTRACT AND PRELIMINARIES

1.3.1 PERIOD OF CONTRACT

Six weeks (06) *Weeks* as the Contract Period for the completion of the Work from date of Site handover.

1.3.2 CONTRACT GUARANTEE:

The Successful Bidder will **NOT** be required to submit a contract guarantee.

1.3.3 GUARANTEE PERIOD

The guarantee period for the completion of the Structural work and all materials must be a minimum of Three (3) Calendar Months from the date of first delivery.

1.3.4 SITE AND MODE OF PROCEDURE

The work contained in this contract will be carried out on the site of the existing **EMS Base Creighton**.

The Bidder is advised that the existing premises will be occupied throughout the period of the contract, and that the minimum amount of disruption to services is of the utmost importance.

Damage to the existing buildings - Bidders to note that any damages done or occurring to any of the buildings will be repaired at the expense of the contractor/ Bidder.

The repairs must be to the satisfaction of the Kwazulu- Natal Department of Health.

Bidders are advised to visit the site prior to tendering and to acquaint themselves with the nature of the work to be done and access to the siting of the existing buildings etc., as no claim whatsoever will be allowed on the grounds of ignorance of the conditions under which the work will executed.

1.3.5 SATISFACTORY INSTALLATION

The whole of the installation shall be carried out in accordance with the South African Bureau of Standards Code of Practice for the application of National Building Regulations, the KZNPA Standard Preambles to all Trades, the KZNPA General Electrical Specification, ICASA, Telecommunications regulations, the South African Bureau of Standards Code of Practice for the Wiring of Premises SABS 0142 and the Occupational Health and Safety Act and Regulations 85/1993 as amended.

Copies of the KZNPA Standard Preambles to all Trades and the KZNPA General Electrical Specification are available at the office of the Secretary for Health – KwaZulu-Natal and can be obtained on request.

1.3.6 CERTIFICATE OF COMPLIANCE

On completion of the service, a copy of the "Certificate of Compliance for Electrical Installation" must be submitted to the office of the Secretary for Health: KwaZulu Natal.

1.3.7 GENERAL

The Bidder's / Contractors will be responsible for all masonry work associated with the electrical installation and making good of all work related to the electrical installation. The patching and painting must be to the satisfaction of the KwaZulu-Natal Department of Health.

1.3.8 EARTHWORKS

SITE CLEARANCE: —The item given in the Bills of Quantities for site clearance shall be deemed to include the removal from the site, or burning if permitted by the Local Authority, of shrubs and trees with trunks under 200mm girth measured at 1m above ground level, hedges, bushes, other vegetation, rubbish and debris. Holes left by roots are to be backfilled with earth and rammed.

EXCAVATIONS: — Rates for excavations are to include for forming and trimming to the correct levels, falls, slopes, curves, etc. for trimming sides, stepping, levelling and ramming bottoms, staging and disposing of the excavated material as described in the items. Rates for excavations to reduce levels over site are also to include for forming and trimming banks to the required batter. The Contractor is to allow in his rates for the bulking of excavated material.

1.3.9 CONCRETE

Concrete test cubes:

Allow for all necessary concrete test cubes size 150 x 150 x 150mm cast from batches of concrete required for the entire contract as specified, made, stored, cured and tested in accordance with SABS Methods 861 and 863, including use and waste of approved cube moulds, transporting to an approved testing laboratory for testing, paying all charges and submitting reports to the Principal Agent.

1.3.10 Curing

All concrete is to be effectively cured. slabs are to be kept wet for 7 days to be covered with plastic for 7 days.

Cost of tests

The costs of making, storing and testing of concrete test cubes as required under clause 7 "Tests" of SABS 1200 G shall include the cost of providing cube moulds necessary for the purpose, for testing costs and for submitting reports on the tests to the principal agent. The testing shall be undertaken by an independent firm or institution nominated by the contractor to the approval of the principal agent. (Test cubes are measured separately)

EARTHWORKS SITE CLEARANCE:

The item given in the Bills of Quantities for site clearance shall be deemed to include the removal from the site, or burning if permitted by the Local Authority, of shrubs and trees with trunks under 200mm girth measured at 1m above ground level, STANDARD PREAMBLES TO ALL TRADES 3 Rev 3 January 2009 hedges, bushes, other vegetation, rubbish and debris. Holes left by roots are to be backfilled with earth and rammed. EXCAVATIONS: — Rates for excavations are to include for forming and trimming to the correct levels, falls, slopes, curves, etc. for trimming sides, stepping, levelling and ramming bottoms, staging and disposing of the excavated material as described in the items. Rates for excavations to reduce levels over site are also to include for forming and trimming banks to the required batter. The Contractor is to allow in his rates for the bulking of excavated material. The term "excavate", unless otherwise stated, shall mean excavate in "soft excavation" as defined below and for the purpose of classifying excavations the following will apply: — a) Soft excavation: — shall be excavation in material that can be efficiently removed by a back-acting excavator of flywheel power approximately 0, 10 kW per millimetre of tined-bucket width without the assistance of pneumatic tools such as paving breakers, or that can be efficiently loaded without prior ripping or stockpiling by a rubber tired front-end loader of approximately 15t mass and a flywheel power of approximately 100 kW. b) Intermediate excavation: — shall be excavation in material that requires a backacting excavator of flywheel power exceeding 0,10kW per millimetre of tined-bucket width and the assistance of pneumatic tools prior to removal by equipment equivalent to that specified in (a) above. c) Hard rock excavation: — shall be excavation in material that cannot be efficiently removed without blasting or without wedging and splitting prior to removal. d) Class A Boulder excavation: — shall be excavation in material containing more than 40% by volume of boulders of size between 0.03m³ and 20m³ in a matrix of softer material or smaller boulders. Note: — Excavation of solid boulders or lumps of size exceeding 20m³ will be classed as hard rock excavation. (2) Excavation of fissured or fractured rock will not be classed as boulder excavation but as hard rock or intermediate excavation according to the nature of the material. e) Class B Boulder excavation: — shall be excavation of boulders only in a material containing 40% or less by volume of boulders of size between 0.03m³ and 20m³ in a matrix of softer material or smaller boulders. Note: — Those boulders requiring individual drilling and blasting in order to be loaded by a back-acting excavator as specified in (a) above, or by a track type frontend loader, will each be separately measured as Class B boulder excavation. The

excavation of the rest of the material will be classed as soft or intermediate excavation according to the nature of the material. Method of Classifying: — The Contractor may use any method he chooses to excavate any class of material but his chosen method of excavation shall not determine the classification of the excavation. The Department will decide on the classification of the materials. The classification will be based on inspection of the material to be excavated and the criteria given in (a) to (e) above, as applicable. The decision of the Department shall be, subject to the relevant provisions of the contract, final and binding. Should the Contractor consider that the excavation is other than "soft excavation" he must notify the Department immediately in order that an inspection be made and a decision arrived at by the Department as to the category of such excavation. Should the Contractor fail to give such notification, the excavation shall be deemed to be "soft excavation" and shall be measured and valued accordingly. Blasting will only be permitted with the written authority of the Department, if and when permission is granted, it is to be executed only by persons holding the necessary Government Blasting Certificate and subject to all regulations imposed by the Department and/or Local Authority. In addition, the Contractor is to indemnify the Provincial Administration against all claims in respect of damage to persons and property resulting from such blasting operations. STANDARD PREAMBLES TO ALL TRADES 4 Rev 3 January 2009 Before commencing any excavations, the Contractor must satisfy himself as to the accuracy of any levels indicated on the drawings, as no claim will be entertained at a later date for any alleged inaccuracy in such levels. Excavation shall be carried down to such depths as are necessary to obtain firm foundations, but before proceeding to greater depths than are shown on the drawings, the Department's approval must be obtained. The Contractor will be responsible if he excavates wider or deeper than shown or required. If the excavations are deeper than shown or required such extra excavations are to be filled in with mass concrete at the Contractor's expense. If the excavations are wider than shown or required, any form-work or mass concrete filling required to the side of the concrete foundations is to be executed at the Contractor's expense and to the approval of the Department. Depths of excavations as approved shall be checked and recorded by the a Departmental Official and the Contractor's Foreman before any concrete is laid or the excavations are otherwise covered or filled in. Notwithstanding such approval, any excavations which become waterlogged or otherwise spoilt after approval, shall be cleaned out and reformed, at the Contractor's expense and to the satisfaction of the Department, before any concrete, etc. is laid. WATER: — The Contractor shall keep all excavations free from water or mud by pumping, baling or otherwise. WORKING SPACE: — The Contractor is to allow against the items of "excavate to provide working space" for excavating beyond the extent of the net excavations measured to provide the necessary working space for the carrying out of such work as is described in the items. Rates are to include, in addition to the extra excavation, for any additional risk of collapse so incurred and for filling back and compacting the excavated material. No separate item for working space is provided or will be considered where the face of the measured excavation is 750mm or more away from the finished face of the structure. Separate items for working space for the building of brick foundation walls on ordinary concrete wall footings will not be considered. In the case of column base and pile cap excavations, where the dimensions between the column face and the excavation face is less than 500mm, working space has been measured for

the width of the column face from the commencing level of excavation to the top of the column base or pile cap only where the top of the column base or pile cap exceeds 1.5m below the commencing level of excavation. RISK OF COLLAPSE: — The Contractor shall maintain all excavated faces affecting the safety of the works and workmen. He must either provide all necessary temporary planking, strutting or shoring to all vertical excavated faces or carry the risk of collapse of these faces with all its implications. He must assume full responsibility in this connection and must allow in his rates accordingly. In addition, all excavated faces exceeding 1.5m deep are to be maintained in accordance with Government Regulations. Quantities reflect the total superficial areas of the vertical excavated faces and will be subject to variation only in so far as these areas may vary, notwithstanding whether any temporary supports are used or not. FILLING, ETC.: — All backfilling and filling under floors and paving must be of selected material from the excavations, unless otherwise stated, returned and compacted in layers as later described and with the top surface dressed to the correct levels and grades, all to the approval of the Department. Under no circumstances will the Contractor be allowed to use clay, peat or other unsuitable material for filling. STANDARD PREAMBLES TO ALL TRADES 5 Rev 3 January 2009 Rates for all items of filling with material from the excavations are to include haulage not exceeding 100m from the perimeter of the excavations. Any filling supplied by the Contractor is to be of suitable material approved by the Department. COMPACTION OF FILLING ETC.: — All filling and backfilling is to be done in layers not exceeding 200mm thick before compaction, with the layers level to ensure uniform compaction. Each layer is to be thoroughly compacted over the whole of the area to a dry density not less than 90% of Mod. A.A.S.H.O. density. The surface of each compacted layer shall be uniform and tightly bonded. Care is to be taken that no damage is done to foundation walls, drains and other services. The densities of compaction referred to are to be determined by tests carried out in accordance with A.S.T.M. Designation D 1557-58 and at an optimum moisture content of not more or less than 5% of the required Mod. A.A.S.H.O. The Contractor shall be responsible for having sufficient tests taken of the density of the compacted filling to ensure that the required compaction is being attained to the satisfaction of the Department. These tests are to be undertaken by an independent testing authority nominated by the Contractor to the approval of the Department. The costs of all tests in this connection shall be borne by the Contractor and shall be allowed for in his rates. PROTECTION AGAINST SUBTERRANEAN WOOD-DESTROYING TERMITES: — Where protection against termites is to be provided: — a) Remove vegetable matter All dead roots and other vegetable matter likely to encourage termites must be removed from the ground under, against the building and from all filling material. b) Treating the ground The ground under surface beds, and below suspended wood floors, must be treated by the application of Soil Insecticides of Chlordane or Aldrin types complying with SANS Specifications 1165 and 1164 respectively, mixed with water and applied at the rate of not less than 5 litres of solution per square metre uniformly over the whole surface. The concentration of the solution must be strictly in accordance with the manufacturer's instructions and to the approval of the Department. The Department reserves the right to take samples of the diluted solution, at any time, in order to test the concentration of the chemicals used. Where the ground to be treated is of earth filling, the upper 50mm layer of filling must be levelled by raking, but must not be rammed until after the solution has been applied, and where of natural ground, it must

be loosened to a depth of not less than 50mm and similarly levelled, in order to enable the solution to penetrate into the soil. After the solution has been applied and allowed to penetrate the surface, the soil must be well rammed and consolidated. Before applying the solution to the ground under the floors, splay back earth for a depth and width of 75mm from the internal faces of walls enclosing the floors, against internal walls, sleeper piers, etc. and thoroughly saturate with the solution. After the solution has soaked into the earth, the splayed grooves must be filled with earth and consolidated. The treated layer of soil under suspended wood floors must be protected with a 75mm thick layer of approved clean gravel, finished to an even surface. The treated layer of soil under concrete surface beds must be protected with a 25mm thick layer of well-consolidated approved grit prior to laying the waterproofing membrane. Great care must be taken when laying concrete surface beds, protective layers, etc. in order to avoid rupturing the treated layer of soil. Should the treated layer be ruptured at any STANDARD PREAMBLES TO ALL TRADES 6 Rev 3 January 2009 point it must be made good and the area affected re-treated with the soil insecticide. Contractors are advised that: a. Special precautions must be taken to protect the workmen whilst using the soil insecticide. b. The treatment of filling or ground under floors shall be done as soon as practicable, so that treatment may dry out before the floors are laid. c. The treatment of the ground must be carried out under the supervision of the Department. d. The soil insecticide to be delivered to the site in sealed drums clearly labelled or stamped with the name of the product. e. In addition to the foregoing the application of the soil insecticide to be carried out in accordance with SANS Code of Practice 0124 — the application of Certain Soil Insecticides for the Protection of Buildings. f. The protective layers of gravel or grit have been measured separately. RE-USE OF EXCAVATED MATERIAL: — Material of any kind that may be discovered on the site during the excavation shall remain the property of the Administration. Such material may, if approved, be used for aggregate. Material so used shall be valued and the value deducted from the Contract Sum. DEMOLITIONS: — The Contractor is referred to the preambles for "Alterations" insofar as they apply and the following: — The demolition of existing buildings is to be done in a practical and safe manner, under the continuous supervision of a competent Foreman. Rates for the demolition of existing buildings are to include for breaking up and removing all external screen walls, steps and ramps, surface water channels, rainwater sumps, gulleys, etc. and grubbing up and removing all foundation walls and footings, disconnecting and removing all services to a point not less than 1m beyond the perimeter of the buildings, plugging off ends of all remaining pipes, and for filling in all holes with clean earth and ramming up to ground level. All movable fittings and furniture, fire extinguishers and electrical and other equipment in the buildings to be demolished are to remain the property of and will be removed by the Administration prior to the commencement of the demolition. Before commencing the demolitions, the Contractor shall comply with any Local Authority regulations in force in respect of rodent extermination, etc. and he shall obtain the required Clearance Certificate. Items to cover the cost of obtaining the certificate and the fumigation, etc. of the buildings to be demolished have been provided elsewhere in the Bills of Quantities, and the fumigation is to be carried out by a firm specialising in this type of work. The fumigation of the buildings to be demolished shall only be carried out if called for by the Local Authorities and if not required the value of the relevant items in the Bills of Quantities will be deducted from the Contract Sum. After handing

over the site to the Contractor, the risk of any loss or damage to the buildings to be demolished and the materials therein, caused by theft, vandalism, etc. shall be the responsibility of the Contractor and he shall take such precautions as he deems necessary against such loss or damage.

GRASS PLANTING AND TURFING: — Is to be "Cape Kweek" or "Umgeni" grass scientifically known as *Cynodon dactylon* or other local fine grass approved by the Department. In areas where fine grass does not grow readily, Kikuyu grass *Pennisetum clandestinum* may be substituted. The areas must be identified and the approval of the Department obtained before Kikuyu grass is to be planted.

Grass Planting To Level Areas: — The areas to receive grass are to be weeded and raked free of stones and other superfluous matter and all depressions left by the earthworks plant are to be filled in with approved topsoil. The planting of grass is to be carried out in continuous root planting in rows 200mm apart. The method of planting called "sprigging" may be used as an alternative.

STANDARD PREAMBLES TO ALL TRADES 7 Rev 3 January 2009 Immediately after completion of each strip or square, the area thus grassed is to be thoroughly watered and lightly rolled. Any drifting or piling up of the top soil due to wind or any other cause must be prevented as far as possible and should such piling up of soil against newly planted grass occur the soil must immediately be raked level and lightly rolled.

Turfing: — Banks are to be carefully trimmed to an even surface and weeded and raked free of stones, etc. and all depressions filled in with approved topsoil as before described. Turfing of banks is to be carried out with 25mm thick maximum 500mm x 1000mm weedfree grass sods, of grass as before described, and as approved by the Department. The grass sods are to be set in position in horizontal rows to broken bond and closely fitted together and tamped flat with a timber pummel, a maximum of two sods in every square metre of area covered being staked to the bank to maintain position, with and including one sharpened wood or bamboo skewer 250mm long and with all cavities between sods filled in with approved top soil and the whole area lightly top soil dressed on completion.

Established Lawn: — The use of established lawn in pieces size approximately 500mm x 1000mm x 25mm thick in lieu of grass sods on banks will be permitted provided that the established lawn is supplied and laid by a firm experienced in this type of work and to the approval of the Department. The fitting, tamping, staking and top dressing must all be as described for turfing, except that one piece per square metre is required to be staked as described.

Fertilizer: — An approved fertilizer of the following types— Type 2:3:2 for grass planted levelled areas and Type 3:2:1 for turfed or established lawn covered banks is to be supplied and applied by the Contractor at the rate of 400 kg per hectare. In the case of grass planted levelled areas the fertilizer is to be applied either before or after grass planting and in the case of turfed or established lawn covered banks the fertilizer is to be applied after the sods or pieces have been laid. The fertilizer above described is to in addition to any fertilizer which may have been specified to be applied during either the operation of scarifying and grading the area to be grassed or the re-spreading of top soil. A sample of the existing topsoil or the topsoil to be re-spread is to be sent to an approved fertilizer manufacturer for testing and advice on the acid or alkaline content of the soil. The cost of this test is to be borne by the Contractor if this is not provided free by the fertilizer manufacturer. The requisite quantities of limestone ammonium nitrate for acidic soil or ammonium sulphate for alkaline soil as determined by the soil test will be supplied to the Contractor by the Department and the cost thereof is to be included in a Provisional Sum

elsewhere in the Bills of Quantities. The application of this treatment is to be undertaken by the Contractor and his rates for grassing, etc. must include for same. Weed killer: — "Weed Master or Turf Master" or other approved weed killer is to be applied to the entire grassed or turfed areas at a rate of 4 litres mixed with 200 litres of water per hectare, this being equivalent to 40-45 millilitres mixed with 5 litres of water per fifty square metres. The solution is to be sprayed on with a suitable spraying apparatus to achieve an even distribution. Six to eight weeks later, the operation is to be repeated. The application of weed killer is not to take place during wet weather. Weather conditions should be such as to allow a minimum of two hours or absorption before the likelihood of rain. Watering and Rolling: — The entire turfed area is to be kept clear of weeds, lightly rolled and thoroughly watered throughout the period of the Contract and or at least three months from the time of acceptance of the grounds or until the grassing or turfing is well established if that is sooner, all to the satisfaction of the Department. In the absence of rain, the initial watering of grassed or turfed areas is to be carried out as follows: — STANDARD PREAMBLES TO ALL TRADES 8 Rev 3 January 2009 Grass planted levelled areas: - at least twice a week. Established lawn areas: - at least once a week. Turfed areas: - at least once a day for the first ten to fourteen days, thereafter at least once a week. The Contractor must allow in his rates for providing and removing at completion all necessary temporary water piping complete with fittings, sprinklers, hoses, etc. as required for the proper watering of the grassed or turfed areas of the plateaux and banks. Cutting of Grass: — The Contractor must commence mowing as soon as possible once turfed areas have become established and undertake regular mowing at approximately one-week intervals up to the date of final delivery, except that, during the maintenance period, the mowing of the plateaux will be undertaken by the Institution. Note: — All stages of grass planting and turfing are to be supervised on a full time basis by a competent person with the necessary experience and knowledge. It shall be the responsibility of the Contractor to advise the Department when the following operations are to be carried out in order that his representative may be present: — a) the application of fertilizer b) the application of weed killer. Should the Contractor fail to do so, the Department shall have the right to instruct the Contractor to repeat the operation at his own expense. 3.

CONCRETE, FORMWORK AND REINFORCEMENT GENERAL:

This specification applies to concrete work formed into its final shape and position in-situ. All concrete and formwork shall be carried out in accordance with SANS Specification 1200 G — Concrete (Structural) (a copy of which the Contractor will be required to keep on the site so that it can be referred to at all times during the Contract), with the following amplifications and amendments: — INTERPRETATIONS: — Clauses 2.1 and 2.2 of SANS Specification 1200G refer. This preamble, together with any other supplementary preambles appearing in these Bills of Quantities shall be deemed to be the project specification and are the "Portion 2" referred to in Clause 2.2. DEFINITIONS: — Clause 2.3 of SANS Specification 1200 G refers. All references to the Engineer shall be deemed to mean the Department. MATERIALS Cement: — unless otherwise specified, shall be one or more of the following and shall, in each case, comply with the requirements of the relevant standard specification: — Portland cement and rapid-hardening cement to SANS 471 Specification Portland blast-furnace cement to SANS Specification 626. Portland cement 15 to SANS Specification

831. Nevertheless, no cement other than ordinary Portland cement shall be used without the approval of the Department. Cement containing more than 15% blast-furnace slag will not be permitted in columns or in members less than 50mm thick. In addition (for the abovementioned items) where Ordinary Portland cement is used, blastfurnace slag (from separate containers) must not be added in any proportion whatsoever. No mixing of two different types of cement in the same batch will be allowed, and unless otherwise approved by the Department, the same brand and type shall be used in all exposed concrete. STANDARD PREAMBLES TO ALL TRADES 9 Rev 3 January 2009 Lumpy cement, broken sacks and sweepings shall not be used. Cement supplied in sacks shall be used in the order in which it was delivered and shall not be kept in storage for longer than six (6) weeks without the approval of the Department. Water: — Shall be clean and free from injurious amounts of acids, alkalis, sugar, organic matter and other substances that could impair the strength or durability of the concrete. If so required by the Department, the suitability of the water shall be proved by tests carried out by an approved laboratory. Aggregates: — Unless otherwise specified both the coarse aggregate (stone) and the fine aggregate (sand) shall comply with the requirements of SANS Specification 1083. The Contractor is to prove compliance by means of either a certificate from the supplier or by grading analysis tests. Admixtures: — i.e. materials other than cement, aggregate and water shall not be used in the concrete mix without the approval of the Department. The onus for proof of satisfaction to the Department for any admixture proposed shall be with Contractor. Reinforcement: — for concrete shall be as specified and shall, in each case, comply with one of the following: — a) Type A hot rolled mild steel bars of plain round cross section to SANS Specification 920 b) Type C Class 2 hot rolled high yield stress Grade 1 deformed bars to SANS Specification 920 c) Type D Grade 1 cold worked deformed bars to SANS Specification 920. d) Welded steel fabric to SANS Specification 1024 manufactured from plain hard-drawn mild steel wire. A sample reinforcing rod, approximately 600mm long, may be taken from each consignment of rods of similar diameter, for testing. If any sample is found unsatisfactory the whole consignment of rods from which the sample was taken will be rejected. No substitution of the bars specified shall be made without the prior approval of the Department. REINFORCEMENT Bending: — Reinforcing bars shall be cut and bent according to the dimensions shown on the working drawings and in accordance with SANS Specification 82. Except as allowed for below, all bars shall be bent cold and bending shall be done slowly, a steady even pressure being used without jerk or impact. If approved by the Department, hot bending of bars

STRUCTURAL STEEL WORK GENERALLY:

The fabrication, assembly and erection of structural steelwork is to be executed in accordance with SANS Specification 1200H — Structural Steelwork (a copy of which the Contractor will be required to keep on site so that it can be referred to at all times during the Contract) with the following amplifications and amendments: — INTERPRETATIONS: — Clauses 2.1 and 2.2 refer. This preamble, together with any other supplementary preambles appearing in these Bills of Quantities shall be deemed the project specification and are the "Portion 2" referred to in Clause 2.2. DEFINITIONS: — Clause 2.3 of SANS Specification 1200H refers. All references to the Engineer shall be deemed to mean the Department. SUB-CONTRACTORS: —The Contractor shall either (a) have adequate satisfactory and approved

experience in this type of work or (b) employ an approved specialist structural steelwork Sub-Contractor. The Contractor, in the case of (a), or the specialist SubContractor, in the case of (b), shall employ at all stages of the Works both on and off site a competent Supervisor experienced in the work.

MATERIALS: — Unless otherwise shown on the drawings or hereunder, all rolled sections shall be hot rolled mild steel, and all materials shall comply with one of the following: — a) Weldable Structural Steels to SANS 4360: b) Hollow sections to SANS 4848 Part 2 and SANS 6323. c) Cold rolled sections to SANS 2994. d) Black bolts and nuts to SANS 135. e) Precision bolts and nuts to SANS 136. f) High-strength friction-grip bolts and nuts to SANS 1282. g) Flat and tapered washers to SANS 1149. h) Electrodes for welding to SANS 455.

SHOP DETAIL DRAWINGS: — The Contractor shall prepare shop detail drawings, in conformity with the details shown on the structural steelwork drawings and to show all information necessary for complete fabrication, assembly, erection and painting. In the preparation of the shop detail drawings the Contractor is to comply with the requirements of SANS Code of Practice 0162. **STANDARD PREAMBLES TO ALL TRADES 47 Rev 3 January 2009** The cost of preparing all necessary shop detail drawings and copies thereof is to be allowed for by the Contractor in his rates. The Contractor shall submit two copies of his shop detail drawings to the Department for approval at least 10 days before fabrication of the member concerned is due to commence. Such approval does not imply that a complete and comprehensive check of the detail drawings has been carried out, and the Contractor shall remain responsible for ensuring that the steelwork is correctly fabricated, assembled, erected and painted.

SUBSTITUTION OF SIZES, ETC.: — No substitution of sizes or joints additional to those shown on the drawings shall be made without the prior approval of the Department. Except in cases of proven non-availability of materials specified, any additional costs involved due to substitution shall be for the Contractor's account.

FIXINGS: — The positions and manner of fixing the hangers for suspended ceiling airconditioning ducts, pipe installations, etc. to the structural steelwork are to be approved by the Department before work on such installations commences.

FABRICATION, ASSEMBLY AND ERECTION Welding: — shall be carried out in accordance with SANS Code of Practice 044 and the relevant recommendations of SANS Code of Practice 0162 and SANS 5135, and in any case of conflict, the SANS Codes of Practice shall be deemed as binding. All welders employed on the Works shall be currently classified at least as grade 2 welders as defined by SANS Code of Practice 044. Should the Department so request, proof of the classification shall be produced. Unless otherwise specified all welds are to be continuous fillet welds of 6mm leg length or not less than the thinnest plate or section being welded.

Handling, Storage and Erection: — of members is to be undertaken in such a manner to prevent overstress or damage. Should overstress or damage occur, the Department shall be informed and his instructions sought. Storage shall be arranged such that damage to applied finishes is prevented. All plant and equipment used in the erection of structural steelwork shall be adequate in every respect. The Contractor shall allow in his rates for all necessary temporary bracing, and for maintaining and finally removing such temporary bracing.

Fixing of Bolts, etc.: — Unless approved by the Department, no pre-drilled fixings for bolts, etc. will be permitted through hollow section members. Any hollow section member that has been drilled or punctured in any way shall be considered condemned and must be replaced to the satisfaction of the Department.

INSPECTION AND TESTING Facility for Inspection: — The Contractor shall

**PROVINCE OF KWAZULU-NATAL
DEPARTMENT OF HEALTH**

ZNQ –

**EMS BASE CREIGHTON – SUPPLY, DELIVER AND INSTALL INFORMATION
BOARD AT EMS BASE CREIGHTON.**

3. SCOPE OF WORK

The work to be carried out under this contract includes the supply of all materials, and including all labour to carry out all electrical work and leaving in service condition to the satisfaction of the Secretary for Health: KwaZulu-Natal.

3.1. The work comprises of

3.3.11 Supply and install the following:

- (a) Earthworks – excavation of trenches for the steel poles.
- (b) Concrete to secure the poles
- (c) Frames to hold the boards.
- (d) Information boards

Note: Work to re measured on completion

Item no.	Description	Unit	Qty.	Rate	Amount
1.	<p style="text-align: center;"><u>BILL NO. 1</u></p> <p>EARTHWORKS.</p> <p>The Tenderer is referred to the relevant Clauses in the Model Preambles to All Trades and to the Supplementary Preambles which are incorporated at the back of these Bills of Quantities.</p> <p>Unless otherwise described the preambles and full descriptions of all items appearing in all the bills of the preceding section are to apply equally to this section.</p> <p><i>Excavations in soft rocks, hard rocks AND soil not exceeding 1.5 m deep purpose of excavations is to accommodate poles which will be carried boards and there are some supporting poles</i></p> <p><i>Size of Trench is: 300 x 300 x 800mm deep.</i> Note: there is four trenches to be excavated</p> <p>Trenches</p>	m ³	0.29		
2.	Keep excavation free of water	item	01.		
	<p>Carried to Final Summary Earthworks</p>				R

Item no.	Description	Unit	Qty.	Rate	Amount
1.	<p style="text-align: center;"><u>BILL NO. 2.</u></p> <p>CONCRETE, FORMWORK AND REINFORCEMENTS.</p> <p>The Tenderer is referred to the relevant Clauses in the Model Preambles to All Trades and to the Supplementary Preambles which are incorporated at the back of these Bills of Quantities.</p> <p>Unless otherwise described the preambles and full descriptions of all items appearing in all the bills of the preceding section are to apply equally to this section.</p> <p>Unreinforced concrete -15 mPa/19 mm concrete stones. All concrete is to be effectively cured.</p> <p>Footings and bases are to be kept wet for 7 days. Columns are to be wrapped in plastic for 7 days. Slabs are to be covered with plastic for 7 Days</p> <p><u>The concrete will utilized to secure all the poles (two poles and two supports) trench size: 300 x 300 x 800mm deep</u></p> <p>Supply, deliver and cast concrete:</p> <p>concrete</p>	m ³	0.29		
	<p>Carried to Final Summary Concrete, formwork and reinforcements</p>				R

Item no.	Description	Unit	Qty.	Rate	Amount
	<u>BILL NO 3</u>				
	STRUCTURAL STEEL WORK				
	CPAP WORK GROUP NO. 144 UNLESS OTHERWISE STATED)				
	The Contractor is referred to the relevant Clauses in the separate document Specifications of Materials and Methods to be Used (PW 371) Fourth Revision October 1993.				
	<u>Note: for all frames / steel work use hot dipped galvanized steel only. Thickness to be 2mm</u>				
	Supply, deliver and install:				
1.	5 665 x 75 x 75mm square tube (to carry the boards)	no.	01.		
2.	3 500 x 38 x 38mm square tubes (to support the uprights)	no.	01.		
	<u>25x25mm mild steel frame for sign board as manufactured by specialist. (refer to Drawing 1)</u> <u>The width of the frame is 3 000mm.</u>				
3.	Frame 1	no.	01.		
4.	Frame 2	no.	01.		
5.	Frame 3	no.	01.		
	Reflective vinyl lettering on 0.8mm thick Chromadek sheeting pop-riverted onto mild steel frame. (Refer to Drawing 2). <u>The width of the board is 3 000mm.</u>				
6.	Board for frame 1	no.	01.		
7.	Board for frame 2	no.	01.		
8.	Board for frame 3	no.	01.		
	Carried to Final Summary Structural steel work				R

Item no.	Description	Page no.	Amount
<u>FINAL SUMMARY</u>			
1.	Earthworks.	14.	
2.	Concrete, formwork and reinforcements.	15.	
3.	Structural steel work.	16.	
Carried to quotation form			R

The following documents must be returned with the quotation:

- CIDB Registration certificate under 1 GB and Above
- Valid Tax Clearance

COMPILED BY: C.B. Ngcobo 
 CHIEF WORKS INSPECTOR AT HARRY GWALA HEALTH DISTRICT

CHECKED BY: B.J ZINDELA 
 DISTRICT ENGINEER AT HARRY GWALA HEALTH DISTRICT

IMPORTANT
THIS FORM IS ONLY TO BE INCLUDED AND COMPLETED WHEN APPLICABLE TO THE QUOTATION.

OFFICIAL BRIEFING SESSION / SITE INSPECTION CERTIFICATE

Site/building/institution involved: **EMS BASE CREIGHTON.**

Quotation No.: **ZNQ –**

Service: **SUPPLY, DELIVER AND INSTALL INFORMATION BOARD AT EMS BASE CREIGHTON.**

THIS IS TO CERTIFY THAT..... OF (STATE NAME OF TENDERER) VISITED AND INSPECTED THE SITE ON (DATE) AND IS THEREFORE FAMILIAR WITH THE CIRCUMSTANCES AND THE SCOPE OF THE SERVICE TO BE RENDERED.

.....
SIGNATURE OF TENDERER OR AUTHORISED REPRESENTATIVE

DATE :

.....
SIGNATURE OF DEPARTMENTAL REPRESENTATIVE

DEPARTMENTAL STAMP:

DATE :



**SUPPLY, DELIVER AND INSTALL INFORMATION BOARD AT EMS BASE
CREIGHTON**

CRITERIA	POINT ALLOCATION	CONTRACTOR POINTS OBTAINED	COMMENTS
One verifiable order of similar work with completion certificate.	10		
Director /shareholder with relevant qualifications in the construction industry or the qualification of the Artisan who is going to execute the job. He / She has to be present on site during construction work	30		
Attach, the letter of good standing	10		
Attach, active CIDB	20		
Attach, EPWP attendance register and payment certificate.	10		
Locality 0 to 100 km = 20 points 101 to 300km 10 points	20		
Total points	100		

Minimum points required is 50

On appointment compliance with the following:

- Submission of site specific health and safety file.
- Covid 19 compliance
- Signing of site hand over certificate.
- Contractors staff to have identifiable workwear.
- Compliance with EPWP requirements.
- Submission of contractors program.
- Penalties will be imposed on defaulting contractors, formula as follows (0.00275 x total cost) = cost per day
- Contractors are requested to sign this document.

CONTRACTOR DETAILS

Initials and Surname: _____ Signature _____

Note: the Safety file is required within 14 working days after the Contractor has been awarded

BOARD SUITABLE FOR FRAME 1.

BOARD SUITABLE FOR FRAME 2.

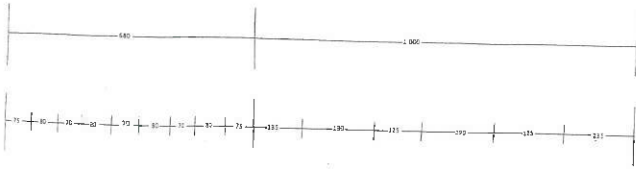

BOARD SUITABLE FOR FRAME 3.

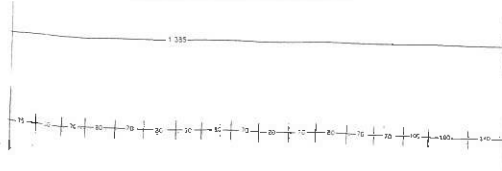

Drawing 2

M. Sami
[Signature] 17/03/2021

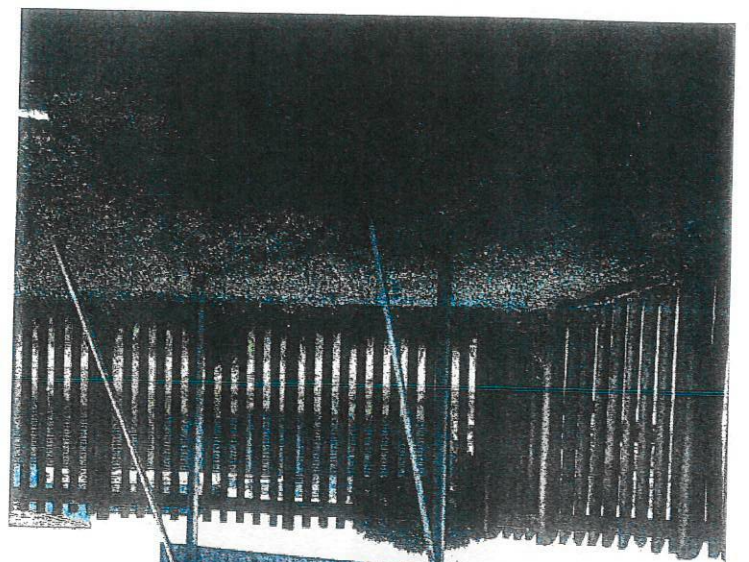
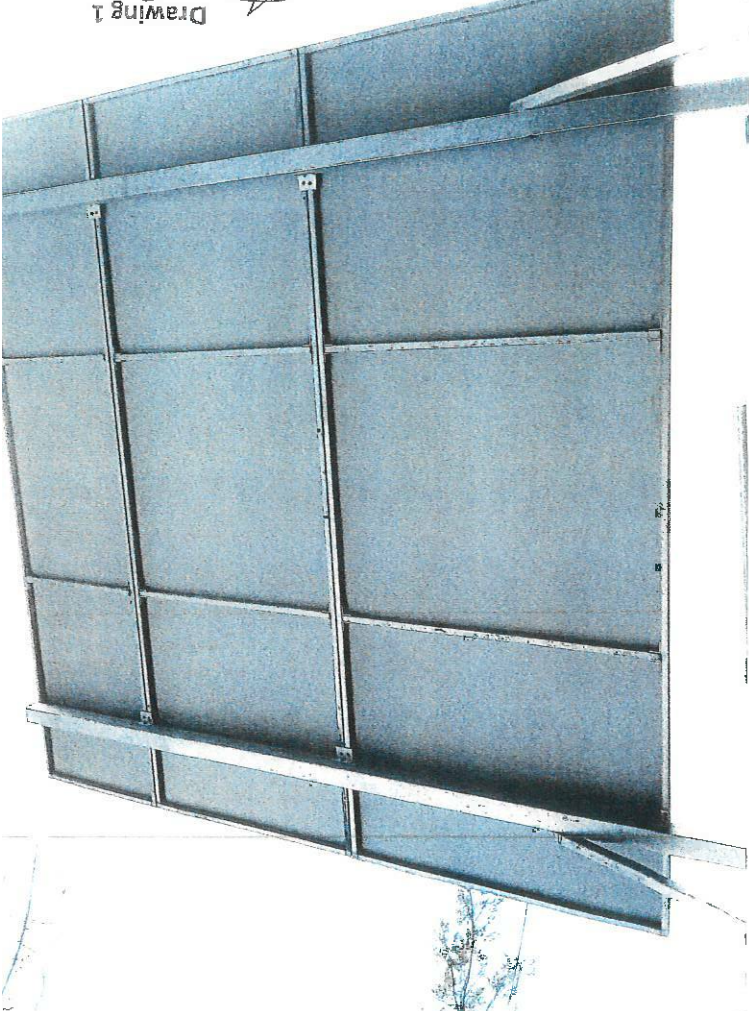

→FRAME 3.

→FRAME 2.

→FRAME 1.



**PROVINCE OF KWAZULU-NATAL
DEPARTMENT OF HEALTH**

ZNQ –

**EMS BASE UNDERBERG – SUPPLY, DELIVER AND INSTALL INFORMATION
BOARD AT EMS BASE UNDERBERG.**

1.1 SCOPE OF CONTRACT

This Contract is for the execution of the project indicated above.

1.2 CONTRACT DRAWINGS

These specifications and bill of quantities must be read in conjunction with drawings attached

1.3 CONDITIONS OF CONTRACT AND PRELIMINARIES

1.3.1 PERIOD OF CONTRACT

Six weeks (06) *Weeks* as the Contract Period for the completion of the Work from date of Site handover.

1.3.2 CONTRACT GUARANTEE:

The Successful Bidder will **NOT** be required to submit a contract guarantee.

1.3.3 GUARANTEE PERIOD

The guarantee period for the completion of the Structural work and all materials must be a minimum of Three (3) Calendar Months from the date of first delivery.

1.3.4 SITE AND MODE OF PROCEDURE

The work contained in this contract will be carried out on the site of the existing **EMS Base Underberg**.

The Bidder is advised that the existing premises will be occupied throughout the period of the contract, and that the minimum amount of disruption to services is of the utmost importance.

Damage to the existing buildings - Bidders to note that any damages done or occurring to any of the buildings will be repaired at the expense of the contractor/ Bidder.

The repairs must be to the satisfaction of the Kwazulu- Natal Department of Health.

Bidders are advised to visit the site prior to tendering and to acquaint themselves with the nature of the work to be done and access to the siting of the existing buildings etc., as no claim whatsoever will be allowed on the grounds of ignorance of the conditions under which the work will executed.

1.3.5 SATISFACTORY INSTALLATION

The whole of the installation shall be carried out in accordance with the South African Bureau of Standards Code of Practice for the application of National Building Regulations, the KZNPA Standard Preambles to all Trades, the KZNPA General Electrical Specification, ICASA, Telecommunications regulations, the South African Bureau of Standards Code of Practice for the Wiring of Premises SABS 0142 and the Occupational Health and Safety Act and Regulations 85/1993 as amended.

Copies of the KZNPA Standard Preambles to all Trades and the KZNPA General Electrical Specification are available at the office of the Secretary for Health – KwaZulu-Natal and can be obtained on request.

1.3.6 CERTIFICATE OF COMPLIANCE

On completion of the service, a copy of the "Certificate of Compliance for Electrical Installation" must be submitted to the office of the Secretary for Health: KwaZulu Natal.

1.3.7 GENERAL

The Bidder's / Contractors will be responsible for all masonry work associated with the electrical installation and making good of all work related to the electrical installation. The patching and painting must be to the satisfaction of the KwaZulu-Natal Department of Health.

1.3.8 EARTHWORKS

SITE CLEARANCE: —The item given in the Bills of Quantities for site clearance shall be deemed to include the removal from the site, or burning if permitted by the Local Authority, of shrubs and trees with trunks under 200mm girth measured at 1m above ground level, hedges, bushes, other vegetation, rubbish and debris. Holes left by roots are to be backfilled with earth and rammed.

EXCAVATIONS: — Rates for excavations are to include for forming and trimming to the correct levels, falls, slopes, curves, etc. for trimming sides, stepping, levelling and ramming bottoms, staging and disposing of the excavated material as described in the items. Rates for excavations to reduce levels over site are also to include for forming and trimming banks to the required batter. The Contractor is to allow in his rates for the bulking of excavated material.

1.3.9 CONCRETE

Concrete test cubes:

Allow for all necessary concrete test cubes size 150 x 150 x 150mm cast from batches of concrete required for the entire contract as specified, made, stored, cured and tested in accordance with SABS Methods 861 and 863, including use and waste of approved cube moulds, transporting to an approved testing laboratory for testing, paying all charges and submitting reports to the Principal Agent.

1.3.10 Curing

All concrete is to be effectively cured. slabs are to be kept wet for 7 days to be covered with plastic for 7 days.

Cost of tests

The costs of making, storing and testing of concrete test cubes as required under clause 7 "Tests" of SABS 1200 G shall include the cost of providing cube moulds necessary for the purpose, for testing costs and for submitting reports on the tests to the principal agent. The testing shall be undertaken by an independent firm or institution nominated by the contractor to the approval of the principal agent. (Test cubes are measured separately)

EARTHWORKS SITE CLEARANCE:

The item given in the Bills of Quantities for site clearance shall be deemed to include the removal from the site, or burning if permitted by the Local Authority, of shrubs and trees with trunks under 200mm girth measured at 1m above ground level, STANDARD PREAMBLES TO ALL TRADES 3 Rev 3 January 2009 hedges, bushes, other vegetation, rubbish and debris. Holes left by roots are to be backfilled with earth and rammed. EXCAVATIONS: — Rates for excavations are to include for forming and trimming to the correct levels, falls, slopes, curves, etc. for trimming sides, stepping, levelling and ramming bottoms, staging and disposing of the excavated material as described in the items. Rates for excavations to reduce levels over site are also to include for forming and trimming banks to the required batter. The Contractor is to allow in his rates for the bulking of excavated material. The term "excavate", unless otherwise stated, shall mean excavate in "soft excavation" as defined below and for the purpose of classifying excavations the following will apply: — a) Soft excavation: — shall be excavation in material that can be efficiently removed by a back-acting excavator of flywheel power approximately 0, 10 kW per millimetre of tined-bucket width without the assistance of pneumatic tools such as paving breakers, or that can be efficiently loaded without prior ripping or stockpiling by a rubber tired front-end loader of approximately 15t mass and a flywheel power of approximately 100 kW. b) Intermediate excavation: — shall be excavation in material that requires a backacting excavator of flywheel power exceeding 0,10kW per millimetre of tined-bucket width and the assistance of pneumatic tools prior to removal by equipment equivalent to that specified in (a) above. c) Hard rock excavation: — shall be excavation in material that cannot be efficiently removed without blasting or without wedging and splitting prior to removal. d) Class A Boulder excavation: — shall be excavation in material containing more than 40% by volume of boulders of size between 0.03m³ and 20m³ in a matrix of softer material or smaller boulders. Note: — Excavation of solid boulders or lumps of size exceeding 20m³ will be classed as hard rock excavation. (2) Excavation of fissured or fractured rock will not be classed as boulder excavation but as hard rock or intermediate excavation according to the nature of the material. e) Class B Boulder excavation: — shall be excavation of boulders only in a material containing 40% or less by volume of boulders of size between 0.03m³ and 20m³ in a matrix of softer material or smaller boulders. Note: — Those boulders requiring individual drilling and blasting in order to be loaded by a back-acting excavator as specified in (a) above, or by a track type frontend loader, will each be separately measured as Class B boulder excavation. The

excavation of the rest of the material will be classed as soft or intermediate excavation according to the nature of the material. Method of Classifying: — The Contractor may use any method he chooses to excavate any class of material but his chosen method of excavation shall not determine the classification of the excavation. The Department will decide on the classification of the materials. The classification will be based on inspection of the material to be excavated and the criteria given in (a) to (e) above, as applicable. The decision of the Department shall be, subject to the relevant provisions of the contract, final and binding. Should the Contractor consider that the excavation is other than "soft excavation" he must notify the Department immediately in order that an inspection be made and a decision arrived at by the Department as to the category of such excavation. Should the Contractor fail to give such notification, the excavation shall be deemed to be "soft excavation" and shall be measured and valued accordingly. Blasting will only be permitted with the written authority of the Department, if and when permission is granted, it is to be executed only by persons holding the necessary Government Blasting Certificate and subject to all regulations imposed by the Department and/or Local Authority. In addition, the Contractor is to indemnify the Provincial Administration against all claims in respect of damage to persons and property resulting from such blasting operations. STANDARD PREAMBLES TO ALL TRADES 4 Rev 3 January 2009 Before commencing any excavations, the Contractor must satisfy himself as to the accuracy of any levels indicated on the drawings, as no claim will be entertained at a later date for any alleged inaccuracy in such levels. Excavation shall be carried down to such depths as are necessary to obtain firm foundations, but before proceeding to greater depths than are shown on the drawings, the Department's approval must be obtained. The Contractor will be responsible if he excavates wider or deeper than shown or required. If the excavations are deeper than shown or required such extra excavations are to be filled in with mass concrete at the Contractor's expense. If the excavations are wider than shown or required, any form-work or mass concrete filling required to the side of the concrete foundations is to be executed at the Contractor's expense and to the approval of the Department. Depths of excavations as approved shall be checked and recorded by the a Departmental Official and the Contractor's Foreman before any concrete is laid or the excavations are otherwise covered or filled in. Notwithstanding such approval, any excavations which become waterlogged or otherwise spoilt after approval, shall be cleaned out and reformed, at the Contractor's expense and to the satisfaction of the Department, before any concrete, etc. is laid. WATER: — The Contractor shall keep all excavations free from water or mud by pumping, baling or otherwise. WORKING SPACE: — The Contractor is to allow against the items of "excavate to provide working space" for excavating beyond the extent of the net excavations measured to provide the necessary working space for the carrying out of such work as is described in the items. Rates are to include, in addition to the extra excavation, for any additional risk of collapse so incurred and for filling back and compacting the excavated material. No separate item for working space is provided or will be considered where the face of the measured excavation is 750mm or more away from the finished face of the structure. Separate items for working space for the building of brick foundation walls on ordinary concrete wall footings will not be considered. In the case of column base and pile cap excavations, where the dimensions between the column face and the excavation face is less than 500mm, working space has been measured for

the width of the column face from the commencing level of excavation to the top of the column base or pile cap only where the top of the column base or pile cap exceeds 1.5m below the commencing level of excavation. RISK OF COLLAPSE: — The Contractor shall maintain all excavated faces affecting the safety of the works and workmen. He must either provide all necessary temporary planking, strutting or shoring to all vertical excavated faces or carry the risk of collapse of these faces with all its implications. He must assume full responsibility in this connection and must allow in his rates accordingly. In addition, all excavated faces exceeding 1.5m deep are to be maintained in accordance with Government Regulations. Quantities reflect the total superficial areas of the vertical excavated faces and will be subject to variation only in so far as these areas may vary, notwithstanding whether any temporary supports are used or not. FILLING, ETC.: — All backfilling and filling under floors and paving must be of selected material from the excavations, unless otherwise stated, returned and compacted in layers as later described and with the top surface dressed to the correct levels and grades, all to the approval of the Department. Under no circumstances will the Contractor be allowed to use clay, peat or other unsuitable material for filling. STANDARD PREAMBLES TO ALL TRADES 5 Rev 3 January 2009 Rates for all items of filling with material from the excavations are to include haulage not exceeding 100m from the perimeter of the excavations. Any filling supplied by the Contractor is to be of suitable material approved by the Department. COMPACTION OF FILLING ETC.: — All filling and backfilling is to be done in layers not exceeding 200mm thick before compaction, with the layers level to ensure uniform compaction. Each layer is to be thoroughly compacted over the whole of the area to a dry density not less than 90% of Mod. A.A.S.H.O. density. The surface of each compacted layer shall be uniform and tightly bonded. Care is to be taken that no damage is done to foundation walls, drains and other services. The densities of compaction referred to are to be determined by tests carried out in accordance with A.S.T.M. Designation D 1557-58 and at an optimum moisture content of not more or less than 5% of the required Mod. A.A.S.H.O. The Contractor shall be responsible for having sufficient tests taken of the density of the compacted filling to ensure that the required compaction is being attained to the satisfaction of the Department. These tests are to be undertaken by an independent testing authority nominated by the Contractor to the approval of the Department. The costs of all tests in this connection shall be borne by the Contractor and shall be allowed for in his rates. PROTECTION AGAINST SUBTERRANEAN WOOD-DESTROYING TERMITES: — Where protection against termites is to be provided: — a) Remove vegetable matter All dead roots and other vegetable matter likely to encourage termites must be removed from the ground under, against the building and from all filling material. b) Treating the ground The ground under surface beds, and below suspended wood floors, must be treated by the application of Soil Insecticides of Chlordane or Aldrin types complying with SANS Specifications 1165 and 1164 respectively, mixed with water and applied at the rate of not less than 5 litres of solution per square metre uniformly over the whole surface. The concentration of the solution must be strictly in accordance with the manufacturer's instructions and to the approval of the Department. The Department reserves the right to take samples of the diluted solution, at any time, in order to test the concentration of the chemicals used. Where the ground to be treated is of earth filling, the upper 50mm layer of filling must be levelled by raking, but must not be rammed until after the solution has been applied, and where of natural ground, it must

be loosened to a depth of not less than 50mm and similarly levelled, in order to enable the solution to penetrate into the soil. After the solution has been applied and allowed to penetrate the surface, the soil must be well rammed and consolidated. Before applying the solution to the ground under the floors, splay back earth for a depth and width of 75mm from the internal faces of walls enclosing the floors, against internal walls, sleeper piers, etc. and thoroughly saturate with the solution. After the solution has soaked into the earth, the splayed grooves must be filled with earth and consolidated. The treated layer of soil under suspended wood floors must be protected with a 75mm thick layer of approved clean gravel, finished to an even surface. The treated layer of soil under concrete surface beds must be protected with a 25mm thick layer of well-consolidated approved grit prior to laying the waterproofing membrane. Great care must be taken when laying concrete surface beds, protective layers, etc. in order to avoid rupturing the treated layer of soil. Should the treated layer be ruptured at any STANDARD PREAMBLES TO ALL TRADES 6 Rev 3 January 2009 point it must be made good and the area affected re-treated with the soil insecticide. Contractors are advised that: a. Special precautions must be taken to protect the workmen whilst using the soil insecticide. b. The treatment of filling or ground under floors shall be done as soon as practicable, so that treatment may dry out before the floors are laid. c. The treatment of the ground must be carried out under the supervision of the Department. d. The soil insecticide to be delivered to the site in sealed drums clearly labelled or stamped with the name of the product. e. In addition to the foregoing the application of the soil insecticide to be carried out in accordance with SANS Code of Practice 0124 — the application of Certain Soil Insecticides for the Protection of Buildings. f. The protective layers of gravel or grit have been measured separately. RE-USE OF EXCAVATED MATERIAL: — Material of any kind that may be discovered on the site during the excavation shall remain the property of the Administration. Such material may, if approved, be used for aggregate. Material so used shall be valued and the value deducted from the Contract Sum. DEMOLITIONS: — The Contractor is referred to the preambles for "Alterations" insofar as they apply and the following: — The demolition of existing buildings is to be done in a practical and safe manner, under the continuous supervision of a competent Foreman. Rates for the demolition of existing buildings are to include for breaking up and removing all external screen walls, steps and ramps, surface water channels, rainwater sumps, gulleys, etc. and grubbing up and removing all foundation walls and footings, disconnecting and removing all services to a point not less than 1m beyond the perimeter of the buildings, plugging off ends of all remaining pipes, and for filling in all holes with clean earth and ramming up to ground level. All movable fittings and furniture, fire extinguishers and electrical and other equipment in the buildings to be demolished are to remain the property of and will be removed by the Administration prior to the commencement of the demolition. Before commencing the demolitions, the Contractor shall comply with any Local Authority regulations in force in respect of rodent extermination, etc. and he shall obtain the required Clearance Certificate. Items to cover the cost of obtaining the certificate and the fumigation, etc. of the buildings to be demolished have been provided elsewhere in the Bills of Quantities, and the fumigation is to be carried out by a firm specialising in this type of work. The fumigation of the buildings to be demolished shall only be carried out if called for by the Local Authorities and if not required the value of the relevant items in the Bills of Quantities will be deducted from the Contract Sum. After handing

**SUPPLY, DELIVER AND INSTALL INFORMATION BOARD AT EMS BASE
UNDERBERG.**

over the site to the Contractor, the risk of any loss or damage to the buildings to be demolished and the materials therein, caused by theft, vandalism, etc. shall be the responsibility of the Contractor and he shall take such precautions as he deems necessary against such loss or damage.

GRASS PLANTING AND TURFING: — Is to be "Cape Kweek" or "Umgeni" grass scientifically known as *Cynodon dactylon* or other local fine grass approved by the Department. In areas where fine grass does not grow readily, Kikuyu grass *Pennisetum clandestinum* may be substituted. The areas must be identified and the approval of the Department obtained before Kikuyu grass is to be planted.

Grass Planting To Level Areas: — The areas to receive grass are to be weeded and raked free of stones and other superfluous matter and all depressions left by the earthworks plant are to be filled in with approved topsoil. The planting of grass is to be carried out in continuous root planting in rows 200mm apart. The method of planting called "sprigging" may be used as an alternative.

STANDARD PREAMBLES TO ALL TRADES 7 Rev 3 January 2009 Immediately after completion of each strip or square, the area thus grassed is to be thoroughly watered and lightly rolled. Any drifting or piling up of the top soil due to wind or any other cause must be prevented as far as possible and should such piling up of soil against newly planted grass occur the soil must immediately be raked level and lightly rolled.

Turfing: — Banks are to be carefully trimmed to an even surface and weeded and raked free of stones, etc. and all depressions filled in with approved topsoil as before described. Turfing of banks is to be carried out with 25mm thick maximum 500mm x 1000mm weedfree grass sods, of grass as before described, and as approved by the Department. The grass sods are to be set in position in horizontal rows to broken bond and closely fitted together and tamped flat with a timber pummel, a maximum of two sods in every square metre of area covered being staked to the bank to maintain position, with and including one sharpened wood or bamboo skewer 250mm long and with all cavities between sods filled in with approved top soil and the whole area lightly top soil dressed on completion.

Established Lawn: — The use of established lawn in pieces size approximately 500mm x 1000mm x 25mm thick in lieu of grass sods on banks will be permitted provided that the established lawn is supplied and laid by a firm experienced in this type of work and to the approval of the Department. The fitting, tamping, staking and top dressing must all be as described for turfing, except that one piece per square metre is required to be staked as described.

Fertilizer: — An approved fertilizer of the following types— Type 2:3:2 for grass planted levelled areas and Type 3:2:1 for turfed or established lawn covered banks is to be supplied and applied by the Contractor at the rate of 400 kg per hectare. In the case of grass planted levelled areas the fertilizer is to be applied either before or after grass planting and in the case of turfed or established lawn covered banks the fertilizer is to be applied after the sods or pieces have been laid. The fertilizer above described is to in addition to any fertilizer which may have been specified to be applied during either the operation of scarifying and grading the area to be grassed or the re-spreading of top soil. A sample of the existing topsoil or the topsoil to be re-spread is to be sent to an approved fertilizer manufacturer for testing and advice on the acid or alkaline content of the soil. The cost of this test is to be borne by the Contractor if this is not provided free by the fertilizer manufacturer. The requisite quantities of limestone ammonium nitrate for acidic soil or ammonium sulphate for alkaline soil as determined by the soil test will be supplied to the Contractor by the Department and the cost thereof is to be included in a Provisional Sum

elsewhere in the Bills of Quantities. The application of this treatment is to be undertaken by the Contractor and his rates for grassing, etc. must include for same. Weed killer: — "Weed Master or Turf Master" or other approved weed killer is to be applied to the entire grassed or turfed areas at a rate of 4 litres mixed with 200 litres of water per hectare, this being equivalent to 40-45 millilitres mixed with 5 litres of water per fifty square metres. The solution is to be sprayed on with a suitable spraying apparatus to achieve an even distribution. Six to eight weeks later, the operation is to be repeated. The application of weed killer is not to take place during wet weather. Weather conditions should be such as to allow a minimum of two hours or absorption before the likelihood of rain. Watering and Rolling: — The entire turfed area is to be kept clear of weeds, lightly rolled and thoroughly watered throughout the period of the Contract and or at least three months from the time of acceptance of the grounds or until the grassing or turfing is well established if that is sooner, all to the satisfaction of the Department. In the absence of rain, the initial watering of grassed or turfed areas is to be carried out as follows: — STANDARD PREAMBLES TO ALL TRADES 8 Rev 3 January 2009 Grass planted levelled areas: - at least twice a week. Established lawn areas: - at least once a week. Turfed areas: - at least once a day for the first ten to fourteen days, thereafter at least once a week. The Contractor must allow in his rates for providing and removing at completion all necessary temporary water piping complete with fittings, sprinklers, hoses, etc. as required for the proper watering of the grassed or turfed areas of the plateaux and banks. Cutting of Grass: — The Contractor must commence mowing as soon as possible once turfed areas have become established and undertake regular mowing at approximately one-week intervals up to the date of final delivery, except that, during the maintenance period, the mowing of the plateaux will be undertaken by the Institution. Note: — All stages of grass planting and turfing are to be supervised on a full time basis by a competent person with the necessary experience and knowledge. It shall be the responsibility of the Contractor to advise the Department when the following operations are to be carried out in order that his representative may be present: — a) the application of fertilizer b) the application of weed killer. Should the Contractor fail to do so, the Department shall have the right to instruct the Contractor to repeat the operation at his own expense. 3.

CONCRETE, FORMWORK AND REINFORCEMENT GENERAL:

This specification applies to concrete work formed into its final shape and position in-situ. All concrete and formwork shall be carried out in accordance with SANS Specification 1200 G — Concrete (Structural) (a copy of which the Contractor will be required to keep on the site so that it can be referred to at all times during the Contract), with the following amplifications and amendments: — INTERPRETATIONS: — Clauses 2.1 and 2.2 of SANS Specification 1200G refer. This preamble, together with any other supplementary preambles appearing in these Bills of Quantities shall be deemed to be the project specification and are the "Portion 2" referred to in Clause 2.2. DEFINITIONS: — Clause 2.3 of SANS Specification 1200 G refers. All references to the Engineer shall be deemed to mean the Department. MATERIALS Cement: — unless otherwise specified, shall be one or more of the following and shall, in each case, comply with the requirements of the relevant standard specification: — Portland cement and rapid-hardening cement to SANS 471 Specification Portland blast-furnace cement to SANS Specification 626. Portland cement 15 to SANS Specification

831. Nevertheless, no cement other than ordinary Portland cement shall be used without the approval of the Department. Cement containing more than 15% blast-furnace slag will not be permitted in columns or in members less than 50mm thick. In addition (for the abovementioned items) where Ordinary Portland cement is used, blastfurnace slag (from separate containers) must not be added in any proportion whatsoever. No mixing of two different types of cement in the same batch will be allowed, and unless otherwise approved by the Department, the same brand and type shall be used in all exposed concrete. STANDARD PREAMBLES TO ALL TRADES 9 Rev 3 January 2009 Lumpy cement, broken sacks and sweepings shall not be used. Cement supplied in sacks shall be used in the order in which it was delivered and shall not be kept in storage for longer than six (6) weeks without the approval of the Department. Water: — Shall be clean and free from injurious amounts of acids, alkalis, sugar, organic matter and other substances that could impair the strength or durability of the concrete. If so required by the Department, the suitability of the water shall be proved by tests carried out by an approved laboratory. Aggregates: — Unless otherwise specified both the coarse aggregate (stone) and the fine aggregate (sand) shall comply with the requirements of SANS Specification 1083. The Contractor is to prove compliance by means of either a certificate from the supplier or by grading analysis tests. Admixtures: — i.e. materials other than cement, aggregate and water shall not be used in the concrete mix without the approval of the Department. The onus for proof of satisfaction to the Department for any admixture proposed shall be with Contractor. Reinforcement: — for concrete shall be as specified and shall, in each case, comply with one of the following: — a) Type A hot rolled mild steel bars of plain round cross section to SANS Specification 920 b) Type C Class 2 hot rolled high yield stress Grade 1 deformed bars to SANS Specification 920 c) Type D Grade 1 cold worked deformed bars to SANS Specification 920. d) Welded steel fabric to SANS Specification 1024 manufactured from plain hard-drawn mild steel wire. A sample reinforcing rod, approximately 600mm long, may be taken from each consignment of rods of similar diameter, for testing. If any sample is found unsatisfactory the whole consignment of rods from which the sample was taken will be rejected. No substitution of the bars specified shall be made without the prior approval of the Department. REINFORCEMENT Bending: — Reinforcing bars shall be cut and bent according to the dimensions shown on the working drawings and in accordance with SANS Specification 82. Except as allowed for below, all bars shall be bent cold and bending shall be done slowly, a steady even pressure being used without jerk or impact. If approved by the Department, hot bending of bars

STRUCTURAL STEEL WORK GENERALLY:

The fabrication, assembly and erection of structural steelwork is to be executed in accordance with SANS Specification 1200H — Structural Steelwork (a copy of which the Contractor will be required to keep on site so that it can be referred to at all times during the Contract) with the following amplifications and amendments: — INTERPRETATIONS: — Clauses 2.1 and 2.2 refer. This preamble, together with any other supplementary preambles appearing in these Bills of Quantities shall be deemed the project specification and are the "Portion 2" referred to in Clause 2.2. DEFINITIONS: — Clause 2.3 of SANS Specification 1200H refers. All references to the Engineer shall be deemed to mean the Department. SUB-CONTRACTORS: —The Contractor shall either (a) have adequate satisfactory and approved

experience in this type of work or (b) employ an approved specialist structural steelwork Sub-Contractor. The Contractor, in the case of (a), or the specialist SubContractor, in the case of (b), shall employ at all stages of the Works both on and off site a competent Supervisor experienced in the work.

MATERIALS: — Unless otherwise shown on the drawings or hereunder, all rolled sections shall be hot rolled mild steel, and all materials shall comply with one of the following: — a) Weldable Structural Steels to SANS 4360: b) Hollow sections to SANS 4848 Part 2 and SANS 6323. c) Cold rolled sections to SANS 2994. d) Black bolts and nuts to SANS 135. e) Precision bolts and nuts to SANS 136. f) High-strength friction-grip bolts and nuts to SANS 1282. g) Flat and tapered washers to SANS 1149. h) Electrodes for welding to SANS 455.

SHOP DETAIL DRAWINGS: — The Contractor shall prepare shop detail drawings, in conformity with the details shown on the structural steelwork drawings and to show all information necessary for complete fabrication, assembly, erection and painting. In the preparation of the shop detail drawings the Contractor is to comply with the requirements of SANS Code of Practice 0162.

STANDARD PREAMBLES TO ALL TRADES 47 Rev 3 January 2009 The cost of preparing all necessary shop detail drawings and copies thereof is to be allowed for by the Contractor in his rates. The Contractor shall submit two copies of his shop detail drawings to the Department for approval at least 10 days before fabrication of the member concerned is due to commence. Such approval does not imply that a complete and comprehensive check of the detail drawings has been carried out, and the Contractor shall remain responsible for ensuring that the steelwork is correctly fabricated, assembled, erected and painted.

SUBSTITUTION OF SIZES, ETC.: — No substitution of sizes or joints additional to those shown on the drawings shall be made without the prior approval of the Department. Except in cases of proven non-availability of materials specified, any additional costs involved due to substitution shall be for the Contractor's account.

FIXINGS: — The positions and manner of fixing the hangers for suspended ceiling airconditioning ducts, pipe installations, etc. to the structural steelwork are to be approved by the Department before work on such installations commences.

FABRICATION, ASSEMBLY AND ERECTION Welding: — shall be carried out in accordance with SANS Code of Practice 044 and the relevant recommendations of SANS Code of Practice 0162 and SANS 5135, and in any case of conflict, the SANS Codes of Practice shall be deemed as binding. All welders employed on the Works shall be currently classified at least as grade 2 welders as defined by SANS Code of Practice 044. Should the Department so request, proof of the classification shall be produced. Unless otherwise specified all welds are to be continuous fillet welds of 6mm leg length or not less than the thinnest plate or section being welded.

Handling, Storage and Erection: — of members is to be undertaken in such a manner to prevent overstress or damage. Should overstress or damage occur, the Department shall be informed and his instructions sought. Storage shall be arranged such that damage to applied finishes is prevented. All plant and equipment used in the erection of structural steelwork shall be adequate in every respect. The Contractor shall allow in his rates for all necessary temporary bracing, and for maintaining and finally removing such temporary bracing.

Fixing of Bolts, etc.: — Unless approved by the Department, no pre-drilled fixings for bolts, etc. will be permitted through hollow section members. Any hollow section member that has been drilled or punctured in any way shall be considered condemned and must be replaced to the satisfaction of the Department.

INSPECTION AND TESTING Facility for Inspection: — The Contractor shall

PROVINCE OF KWAZULU-NATAL
DEPARTMENT OF HEALTH

ZNQ –

EMS BASE UNDERBERG – SUPPLY, DELIVER AND INSTALL INFORMATION
BOARD AT EMS BASE UNDERBERG.

TECHNICAL SPECIFICATIONS

2. TECHNICAL SPECIFICATION

2.1 GENERAL

This TECHNICAL SPECIFICATION shall be read in conjunction with all other sections of the SPECIFICATION and cognisance shall be taken of the clauses relevant to this particular installation, whether any specific clauses are referred to or not.

2.2 *Standard Preambles*

This is available from the department on request.

2.3 *Health and Safety Specification*

Health and Safety Plan with Risk assessment schedule is to be compiled taking cognisance of the specific type of patient's that walk around the institution all day. All areas are to be protected at all times from patients falling in. All new and old materials are to be securely stored during construction to eliminate any person from rolling them around or playing inside them.

Grading: 1 GB AND Above

CIDB COMPLIANCE

- 2.4 Amendments: Functionality in different contracting strategies in line with regulations 4.3.3 of the CIDB regulations, where functionality is evaluated, at least three Persons who are fully conversant with the Technical aspects of the scope of works shall undertake such evaluation.

**PROVINCE OF KWAZULU-NATAL
DEPARTMENT OF HEALTH**

ZNQ –

**EMS BASE UNDERBERG – SUPPLY, DELIVER AND INSTALL INFORMATION
BOARD AT EMS BASE UNDERBERG.**

3. SCOPE OF WORK

The work to be carried out under this contract includes the supply of all materials, and including all labour to carry out all electrical work and leaving in service condition to the satisfaction of the Secretary for Health: KwaZulu-Natal.

3.1. The work comprises of

3.3.11 Supply and install the following:

- (a) Earthworks – excavation of trenches for the steel poles.
- (b) Concrete to secure the poles
- (c) Frames to hold the boards.
- (d) Information boards

Note: Work to re measured on completion

Item no.	Description	Unit	Qty.	Rate	Amount
	BILL NO. 1				
	EARTHWORKS.				
	The Tenderer is referred to the relevant Clauses in the Model Preambles to All Trades and to the Supplementary Preambles which are incorporated at the back of these Bills of Quantities.				
	Unless otherwise described the preambles and full descriptions of all items appearing in all the bills of the preceding section are to apply equally to this section.				
	<i>Excavations in soft rocks, hard rocks AND soil not exceeding 1.5 m deep purpose of excavations is to accommodate poles which will be carried boards and there are some supporting poles</i>				
	Size of Trench is: 300 x 300 x 800mm deep. Note: there is four trenches to be excavated				
1.	Trenches	m ³	0.29		
2.	Keep excavation free of water	item	01.		
	Carried to Final Summary Earthworks				R



Item no.	Description	Unit	Qty.	Rate	Amount
	BILL NO 3				
	STRUCTURAL STEEL WORK				
	CPAP WORK GROUP NO. 144 UNLESS OTHERWISE STATED)				
	The Contractor is referred to the relevant Clauses in the separate document Specifications of Materials and Methods to be Used (PW 371) Fourth Revision October 1993.				
	<u>Note: for all frames / steel work use hot dipped galvanized steel only. Thickness to be 2mm</u>				
	Supply, deliver and install:				
1.	5 665 x 75 x 75mm square tube (to carry the boards)	no.	01.		
2.	3 500 x 38 x38mm square tubes (to support the uprights)	no.	01.		
	<u>25x25mm mild steel frame for sign board as manufactured by specialist. (refer to Drawing 1). The width of the frame is 3 000mm.</u>				
3.	Frame 1	no.	01.		
4.	Frame 2	no.	01.		
5.	Frame 3	no.	01.		
	Reflective vinyl lettering on 0.8mm thick Chromadek sheeting pop-riverted onto mild steel frame. (Refer to Drawing 2). <u>The width of the board is 3 000mm.</u>				
6.	Board for frame 1	no.	01.		
7.	Board for frame 2	no.	01.		
8.	Board for frame 3	no.	01.		
	Carried to Final Summary Structural steel work				R

Item no.	Description	Page no.	Amount
<u>FINAL SUMMARY</u>			
1.	Earthworks.	14.	
2.	Concrete, formwork and reinforcements.	15.	
3.	Structural steel work.	16.	
Carried to quotation form			R

The following documents must be returned with the quotation:

- CIDB Registration certificate under 1 GB and Above
- Valid Tax Clearance

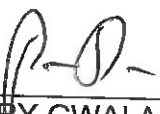
COMPILED BY: C.B. Ngcobo 
 CHIEF WORKS INSPECTOR AT HARRY GWALA HEALTH DISTRICT

CHECKED BY: B.J ZINDELA  
 DISTRICT ENGINEER AT HARRY GWALA HEALTH DISTRICT

**SUPPLY, DELIVER AND INSTALL INFORMATION BOARD AT EMS BASE
 UNDERBERG.**

IMPORTANT

THIS FORM IS ONLY TO BE INCLUDED AND COMPLETED WHEN APPLICABLE TO THE QUOTATION.

OFFICIAL BRIEFING SESSION / SITE INSPECTION CERTIFICATE

Site/building/institution involved: **EMS BASE UNDERBERG.**

Quotation No.: **ZNQ -**

Service: **SUPPLY, DELIVER AND INSTALL INFORMATION BOARD AT EMS BASE UNDERBERG.**

THIS IS TO CERTIFY THAT..... OF (STATE NAME OF TENDERER) VISITED AND INSPECTED THE SITE ON (DATE) AND IS THEREFORE FAMILIAR WITH THE CIRCUMSTANCES AND THE SCOPE OF THE SERVICE TO BE RENDERED.

.....
SIGNATURE OF TENDERER OR AUTHORISED REPRESENTATIVE

DATE :

.....
SIGNATURE OF DEPARTMENTAL REPRESENTATIVE

DEPARTMENTAL STAMP:

DATE :



health

Department:
Health
PROVINCE OF KWAZULU-NATAL

**SUPPLY, DELIVER AND INSTALL INFORMATION BOARD AT EMS BASE
UNDERBERG.**

CRITERIA	POINT ALLOCATION	CONTRACTOR POINTS OBTAINED	COMMENTS
One verifiable order of similar work with completion certificate.	10		
Director /shareholder with relevant qualifications in the construction industry or the qualification of the Artisan who is going to execute the job. He / She has to be present on site during construction work	30		
Attach, the letter of good standing	10		
Attach, active CIDB	20		
Attach, EPWP attendance register and payment certificate.	10		
Locality 0 to100 km = 20 points 101 to 300km 10 points	20		
Total points	100		

Minimum points required is 50

On appointment compliance with the following:

- Submission of site specific health and safety file.
- Covid 19 compliance
- Signing of site hand over certificate.
- Contractors staff to have identifiable workwear.
- Compliance with EPWP requirements.
- Submission of contractors program.
- Penalties will be imposed on defaulting contractors, formula as follows $(0.00275 \times \text{total cost}) = \text{cost per day}$
- Contractors are requested to sign this document.

CONTRACTOR DETAILS

Initials and Surname: _____ Signature _____

Note: the Safety file is required within 14 working days after the Contractor has been awarded

**SUPPLY, DELIVER AND INSTALL INFORMATION BOARD AT EMS BASE 19
UNDERBERG.**

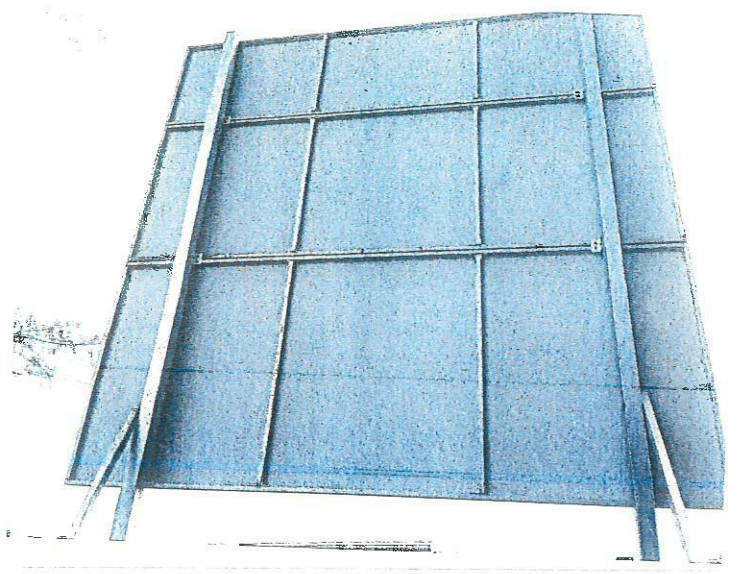
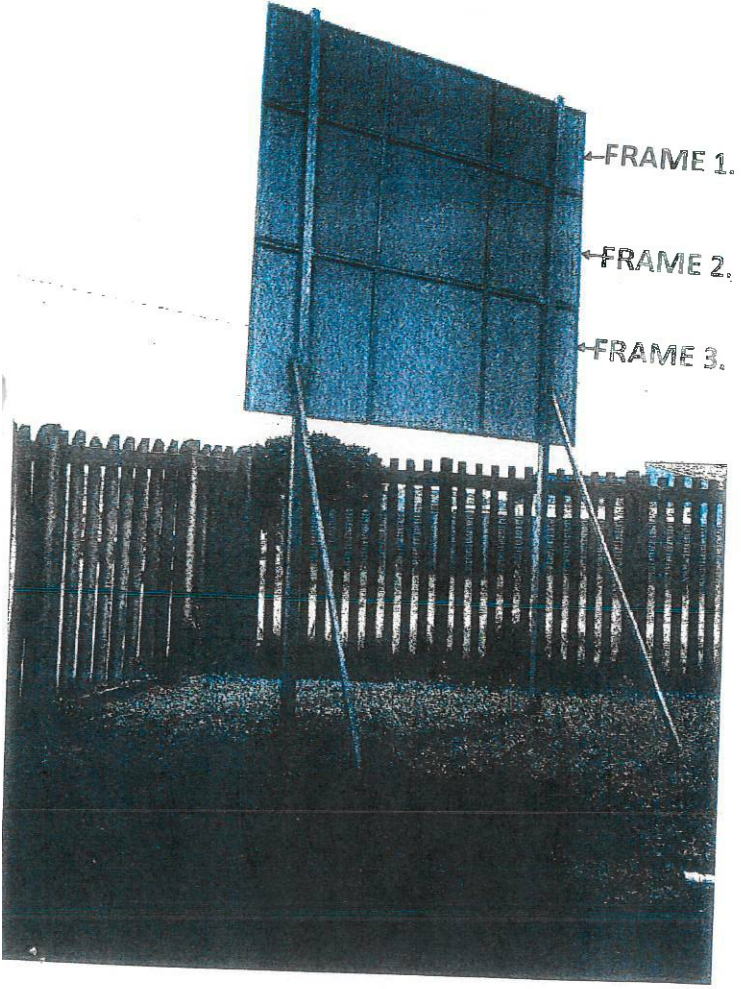

Drawing 1
M. S. A. M.
A. A. A. A.

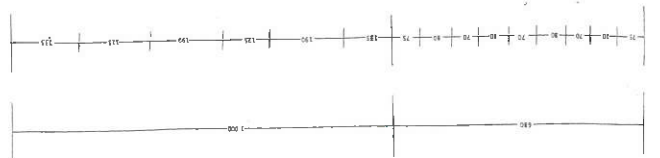
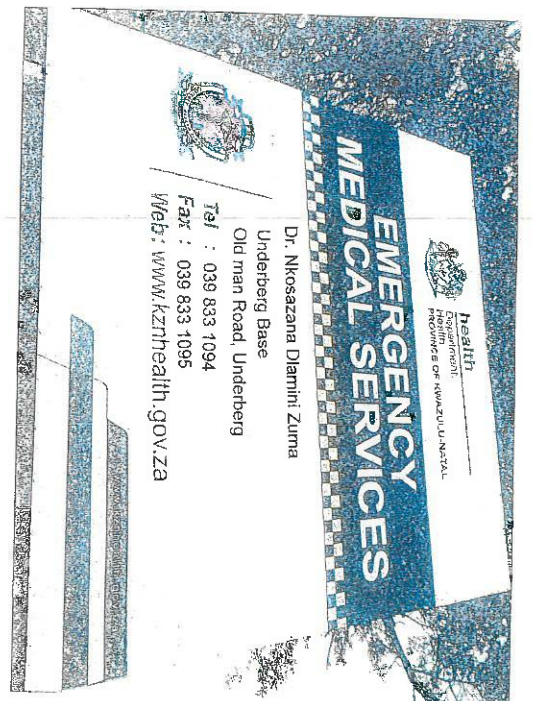

BOARD SUITABLE FOR FRAME 2.

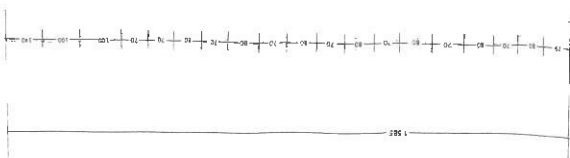

BOARD SUITABLE FOR FRAME 3.

Drawing 2

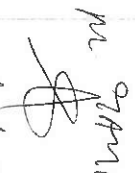
 M. Dlamini
 17/03/2021

**PROVINCE OF KWAZULU-NATAL
DEPARTMENT OF HEALTH**

ZNQ –

**EMS BASE IXOPO – SUPPLY, DELIVER AND INSTALL INFORMATION BOARD AT
EMS BASE IXOPO.**

1.1 SCOPE OF CONTRACT

This Contract is for the execution of the project indicated above.

1.2 CONTRACT DRAWINGS

These specifications and bill of quantities must be read in conjunction with drawings attached

1.3 CONDITIONS OF CONTRACT AND PRELIMINARIES

1.3.1 PERIOD OF CONTRACT

Six weeks (06) *Weeks* as the Contract Period for the completion of the Work from date of Site handover.

1.3.2 CONTRACT GUARANTEE:

The Successful Bidder will **NOT** be required to submit a contract guarantee.

1.3.3 GUARANTEE PERIOD

The guarantee period for the completion of the Structural work and all materials must be a minimum of Three (3) Calendar Months from the date of first delivery.

1.3.4 SITE AND MODE OF PROCEDURE

The work contained in this contract will be carried out on the site of the existing **EMS Base Ixopo**.

The Bidder is advised that the existing premises will be occupied throughout the period of the contract, and that the minimum amount of disruption to services is of the utmost importance.

Damage to the existing buildings - Bidders to note that any damages done or occurring to any of the buildings will be repaired at the expense of the contractor/ Bidder.

The repairs must be to the satisfaction of the Kwazulu- Natal Department of Health.

Bidders are advised to visit the site prior to tendering and to acquaint themselves with the nature of the work to be done and access to the siting of the existing buildings etc., as no claim whatsoever will be allowed on the grounds of ignorance of the conditions under which the work will executed.

1.3.5 SATISFACTORY INSTALLATION

The whole of the installation shall be carried out in accordance with the South African Bureau of Standards Code of Practice for the application of National Building Regulations, the KZNPA Standard Preambles to all Trades, the KZNPA General Electrical Specification, ICASA, Telecommunications regulations, the South African Bureau of Standards Code of Practice for the Wiring of Premises SABS 0142 and the Occupational Health and Safety Act and Regulations 85/1993 as amended.

Copies of the KZNPA Standard Preambles to all Trades and the KZNPA General Electrical Specification are available at the office of the Secretary for Health – KwaZulu-Natal and can be obtained on request.

1.3.6 CERTIFICATE OF COMPLIANCE

On completion of the service, a copy of the "Certificate of Compliance for Electrical Installation" must be submitted to the office of the Secretary for Health: KwaZulu Natal.

1.3.7 GENERAL

The Bidder's / Contractors will be responsible for all masonry work associated with the electrical installation and making good of all work related to the electrical installation. The patching and painting must be to the satisfaction of the KwaZulu-Natal Department of Health.

1.3.8 EARTHWORKS

SITE CLEARANCE: —The item given in the Bills of Quantities for site clearance shall be deemed to include the removal from the site, or burning if permitted by the Local Authority, of shrubs and trees with trunks under 200mm girth measured at 1m above ground level, hedges, bushes, other vegetation, rubbish and debris. Holes left by roots are to be backfilled with earth and rammed.

EXCAVATIONS: — Rates for excavations are to include for forming and trimming to the correct levels, falls, slopes, curves, etc. for trimming sides, stepping, levelling and ramming bottoms, staging and disposing of the excavated material as described in the items. Rates for excavations to reduce levels over site are also to include for forming and trimming banks to the required batter. The Contractor is to allow in his rates for the bulking of excavated material.

1.3.9 CONCRETE

Concrete test cubes:

Allow for all necessary concrete test cubes size 150 x 150 x 150mm cast from batches of concrete required for the entire contract as specified, made, stored, cured and tested in accordance with SABS Methods 861 and 863, including use and waste of approved cube moulds, transporting to an approved testing laboratory for testing, paying all charges and submitting reports to the Principal Agent.

1.3.10 Curing

All concrete is to be effectively cured. slabs are to be kept wet for 7 days to be covered with plastic for 7 days.

Cost of tests

The costs of making, storing and testing of concrete test cubes as required under clause 7 "Tests" of SABS 1200 G shall include the cost of providing cube moulds necessary for the purpose, for testing costs and for submitting reports on the tests to the principal agent. The testing shall be undertaken by an independent firm or institution nominated by the contractor to the approval of the principal agent. (Test cubes are measured separately)

EARTHWORKS SITE CLEARANCE:

The item given in the Bills of Quantities for site clearance shall be deemed to include the removal from the site, or burning if permitted by the Local Authority, of shrubs and trees with trunks under 200mm girth measured at 1m above ground level, STANDARD PREAMBLES TO ALL TRADES 3 Rev 3 January 2009 hedges, bushes, other vegetation, rubbish and debris. Holes left by roots are to be backfilled with earth and rammed. EXCAVATIONS: — Rates for excavations are to include for forming and trimming to the correct levels, falls, slopes, curves, etc. for trimming sides, stepping, levelling and ramming bottoms, staging and disposing of the excavated material as described in the items. Rates for excavations to reduce levels over site are also to include for forming and trimming banks to the required batter. The Contractor is to allow in his rates for the bulking of excavated material. The term "excavate", unless otherwise stated, shall mean excavate in "soft excavation" as defined below and for the purpose of classifying excavations the following will apply: — a) Soft excavation: — shall be excavation in material that can be efficiently removed by a back-acting excavator of flywheel power approximately 0, 10 kW per millimetre of tined-bucket width without the assistance of pneumatic tools such as paving breakers, or that can be efficiently loaded without prior ripping or stockpiling by a rubber tired front-end loader of approximately 15t mass and a flywheel power of approximately 100 kW. b) Intermediate excavation: — shall be excavation in material that requires a backacting excavator of flywheel power exceeding 0,10kW per millimetre of tined-bucket width and the assistance of pneumatic tools prior to removal by equipment equivalent to that specified in (a) above. c) Hard rock excavation: — shall be excavation in material that cannot be efficiently removed without blasting or without wedging and splitting prior to removal. d) Class A Boulder excavation: — shall be excavation in material containing more than 40% by volume of boulders of size between 0.03m³ and 20m³ in a matrix of softer material or smaller boulders. Note: — Excavation of solid boulders or lumps of size exceeding 20m³ will be classed as hard rock excavation. (2) Excavation of fissured or fractured rock will not be classed as boulder excavation but as hard rock or intermediate excavation according to the nature of the material. e) Class B Boulder excavation: — shall be excavation of boulders only in a material containing 40% or less by volume of boulders of size between 0.03m³ and 20m³ in a matrix of softer material or smaller boulders. Note: — Those boulders requiring individual drilling and blasting in order to be loaded by a back-acting excavator as specified in (a) above, or by a track type frontend loader, will each be separately measured as Class B boulder excavation. The

excavation of the rest of the material will be classed as soft or intermediate excavation according to the nature of the material. Method of Classifying: — The Contractor may use any method he chooses to excavate any class of material but his chosen method of excavation shall not determine the classification of the excavation. The Department will decide on the classification of the materials. The classification will be based on inspection of the material to be excavated and the criteria given in (a) to (e) above, as applicable. The decision of the Department shall be, subject to the relevant provisions of the contract, final and binding. Should the Contractor consider that the excavation is other than “soft excavation” he must notify the Department immediately in order that an inspection be made and a decision arrived at by the Department as to the category of such excavation. Should the Contractor fail to give such notification, the excavation shall be deemed to be “soft excavation” and shall be measured and valued accordingly. Blasting will only be permitted with the written authority of the Department, if and when permission is granted, it is to be executed only by persons holding the necessary Government Blasting Certificate and subject to all regulations imposed by the Department and/or Local Authority. In addition, the Contractor is to indemnify the Provincial Administration against all claims in respect of damage to persons and property resulting from such blasting operations. STANDARD PREAMBLES TO ALL TRADES 4 Rev 3 January 2009 Before commencing any excavations, the Contractor must satisfy himself as to the accuracy of any levels indicated on the drawings, as no claim will be entertained at a later date for any alleged inaccuracy in such levels. Excavation shall be carried down to such depths as are necessary to obtain firm foundations, but before proceeding to greater depths than are shown on the drawings, the Department’s approval must be obtained. The Contractor will be responsible if he excavates wider or deeper than shown or required. If the excavations are deeper than shown or required such extra excavations are to be filled in with mass concrete at the Contractor’s expense. If the excavations are wider than shown or required, any form-work or mass concrete filling required to the side of the concrete foundations is to be executed at the Contractor’s expense and to the approval of the Department. Depths of excavations as approved shall be checked and recorded by the a Departmental Official and the Contractor’s Foreman before any concrete is laid or the excavations are otherwise covered or filled in. Notwithstanding such approval, any excavations which become waterlogged or otherwise spoilt after approval, shall be cleaned out and reformed, at the Contractor’s expense and to the satisfaction of the Department, before any concrete, etc. is laid. WATER: — The Contractor shall keep all excavations free from water or mud by pumping, baling or otherwise. WORKING SPACE: — The Contractor is to allow against the items of “excavate to provide working space” for excavating beyond the extent of the net excavations measured to provide the necessary working space for the carrying out of such work as is described in the items. Rates are to include, in addition to the extra excavation, for any additional risk of collapse so incurred and for filling back and compacting the excavated material. No separate item for working space is provided or will be considered where the face of the measured excavation is 750mm or more away from the finished face of the structure. Separate items for working space for the building of brick foundation walls on ordinary concrete wall footings will not be considered. In the case of column base and pile cap excavations, where the dimensions between the column face and the excavation face is less than 500mm, working space has been measured for

the width of the column face from the commencing level of excavation to the top of the column base or pile cap only where the top of the column base or pile cap exceeds 1.5m below the commencing level of excavation. **RISK OF COLLAPSE:** — The Contractor shall maintain all excavated faces affecting the safety of the works and workmen. He must either provide all necessary temporary planking, strutting or shoring to all vertical excavated faces or carry the risk of collapse of these faces with all its implications. He must assume full responsibility in this connection and must allow in his rates accordingly. In addition, all excavated faces exceeding 1.5m deep are to be maintained in accordance with Government Regulations. Quantities reflect the total superficial areas of the vertical excavated faces and will be subject to variation only in so far as these areas may vary, notwithstanding whether any temporary supports are used or not. **FILLING, ETC.:** — All backfilling and filling under floors and paving must be of selected material from the excavations, unless otherwise stated, returned and compacted in layers as later described and with the top surface dressed to the correct levels and grades, all to the approval of the Department. Under no circumstances will the Contractor be allowed to use clay, peat or other unsuitable material for filling. **STANDARD PREAMBLES TO ALL TRADES 5 Rev 3 January 2009** Rates for all items of filling with material from the excavations are to include haulage not exceeding 100m from the perimeter of the excavations. Any filling supplied by the Contractor is to be of suitable material approved by the Department. **COMPACTION OF FILLING ETC.:** — All filling and backfilling is to be done in layers not exceeding 200mm thick before compaction, with the layers level to ensure uniform compaction. Each layer is to be thoroughly compacted over the whole of the area to a dry density not less than 90% of Mod. A.A.S.H.O. density. The surface of each compacted layer shall be uniform and tightly bonded. Care is to be taken that no damage is done to foundation walls, drains and other services. The densities of compaction referred to are to be determined by tests carried out in accordance with A.S.T.M. Designation D 1557-58 and at an optimum moisture content of not more or less than 5% of the required Mod. A.A.S.H.O. The Contractor shall be responsible for having sufficient tests taken of the density of the compacted filling to ensure that the required compaction is being attained to the satisfaction of the Department. These tests are to be undertaken by an independent testing authority nominated by the Contractor to the approval of the Department. The costs of all tests in this connection shall be borne by the Contractor and shall be allowed for in his rates. **PROTECTION AGAINST SUBTERRANEAN WOOD-DESTROYING TERMITES:** — Where protection against termites is to be provided: — a) Remove vegetable matter All dead roots and other vegetable matter likely to encourage termites must be removed from the ground under, against the building and from all filling material. b) Treating the ground The ground under surface beds, and below suspended wood floors, must be treated by the application of Soil Insecticides of Chlordane or Aldrin types complying with SANS Specifications 1165 and 1164 respectively, mixed with water and applied at the rate of not less than 5 litres of solution per square metre uniformly over the whole surface. The concentration of the solution must be strictly in accordance with the manufacturer's instructions and to the approval of the Department. The Department reserves the right to take samples of the diluted solution, at any time, in order to test the concentration of the chemicals used. Where the ground to be treated is of earth filling, the upper 50mm layer of filling must be levelled by raking, but must not be rammed until after the solution has been applied, and where of natural ground, it must

be loosened to a depth of not less than 50mm and similarly levelled, in order to enable the solution to penetrate into the soil. After the solution has been applied and allowed to penetrate the surface, the soil must be well rammed and consolidated. Before applying the solution to the ground under the floors, splay back earth for a depth and width of 75mm from the internal faces of walls enclosing the floors, against internal walls, sleeper piers, etc. and thoroughly saturate with the solution. After the solution has soaked into the earth, the splayed grooves must be filled with earth and consolidated. The treated layer of soil under suspended wood floors must be protected with a 75mm thick layer of approved clean gravel, finished to an even surface. The treated layer of soil under concrete surface beds must be protected with a 25mm thick layer of well-consolidated approved grit prior to laying the waterproofing membrane. Great care must be taken when laying concrete surface beds, protective layers, etc. in order to avoid rupturing the treated layer of soil. Should the treated layer be ruptured at any STANDARD PREAMBLES TO ALL TRADES 6 Rev 3 January 2009 point it must be made good and the area affected re-treated with the soil insecticide. Contractors are advised that: a. Special precautions must be taken to protect the workmen whilst using the soil insecticide. b. The treatment of filling or ground under floors shall be done as soon as practicable, so that treatment may dry out before the floors are laid. c. The treatment of the ground must be carried out under the supervision of the Department. d. The soil insecticide to be delivered to the site in sealed drums clearly labelled or stamped with the name of the product. e. In addition to the foregoing the application of the soil insecticide to be carried out in accordance with SANS Code of Practice 0124 — the application of Certain Soil Insecticides for the Protection of Buildings. f. The protective layers of gravel or grit have been measured separately. RE-USE OF EXCAVATED MATERIAL: — Material of any kind that may be discovered on the site during the excavation shall remain the property of the Administration. Such material may, if approved, be used for aggregate. Material so used shall be valued and the value deducted from the Contract Sum. DEMOLITIONS: — The Contractor is referred to the preambles for "Alterations" insofar as they apply and the following: — The demolition of existing buildings is to be done in a practical and safe manner, under the continuous supervision of a competent Foreman. Rates for the demolition of existing buildings are to include for breaking up and removing all external screen walls, steps and ramps, surface water channels, rainwater sumps, gulleys, etc. and grubbing up and removing all foundation walls and footings, disconnecting and removing all services to a point not less than 1m beyond the perimeter of the buildings, plugging off ends of all remaining pipes, and for filling in all holes with clean earth and ramming up to ground level. All movable fittings and furniture, fire extinguishers and electrical and other equipment in the buildings to be demolished are to remain the property of and will be removed by the Administration prior to the commencement of the demolition. Before commencing the demolitions, the Contractor shall comply with any Local Authority regulations in force in respect of rodent extermination, etc. and he shall obtain the required Clearance Certificate. Items to cover the cost of obtaining the certificate and the fumigation, etc. of the buildings to be demolished have been provided elsewhere in the Bills of Quantities, and the fumigation is to be carried out by a firm specialising in this type of work. The fumigation of the buildings to be demolished shall only be carried out if called for by the Local Authorities and if not required the value of the relevant items in the Bills of Quantities will be deducted from the Contract Sum. After handing

over the site to the Contractor, the risk of any loss or damage to the buildings to be demolished and the materials therein, caused by theft, vandalism, etc. shall be the responsibility of the Contractor and he shall take such precautions as he deems necessary against such loss or damage.

GRASS PLANTING AND TURFING: — Is to be "Cape Kweek" or "Umgeni" grass scientifically known as *Cynodon dactylon* or other local fine grass approved by the Department. In areas where fine grass does not grow readily, Kikuyu grass *Pennisetum clandestinum* may be substituted. The areas must be identified and the approval of the Department obtained before Kikuyu grass is to be planted.

Grass Planting To Level Areas: — The areas to receive grass are to be weeded and raked free of stones and other superfluous matter and all depressions left by the earthworks plant are to be filled in with approved topsoil. The planting of grass is to be carried out in continuous root planting in rows 200mm apart. The method of planting called "sprigging" may be used as an alternative.

STANDARD PREAMBLES TO ALL TRADES 7 Rev 3 January 2009 Immediately after completion of each strip or square, the area thus grassed is to be thoroughly watered and lightly rolled. Any drifting or piling up of the top soil due to wind or any other cause must be prevented as far as possible and should such piling up of soil against newly planted grass occur the soil must immediately be raked level and lightly rolled.

Turfing: — Banks are to be carefully trimmed to an even surface and weeded and raked free of stones, etc. and all depressions filled in with approved topsoil as before described. Turfing of banks is to be carried out with 25mm thick maximum 500mm x 1000mm weedfree grass sods, of grass as before described, and as approved by the Department. The grass sods are to be set in position in horizontal rows to broken bond and closely fitted together and tamped flat with a timber pummel, a maximum of two sods in every square metre of area covered being staked to the bank to maintain position, with and including one sharpened wood or bamboo skewer 250mm long and with all cavities between sods filled in with approved top soil and the whole area lightly top soil dressed on completion.

Established Lawn: — The use of established lawn in pieces size approximately 500mm x 1000mm x 25mm thick in lieu of grass sods on banks will be permitted provided that the established lawn is supplied and laid by a firm experienced in this type of work and to the approval of the Department. The fitting, tamping, staking and top dressing must all be as described for turfing, except that one piece per square metre is required to be staked as described.

Fertilizer: — An approved fertilizer of the following types— Type 2:3:2 for grass planted levelled areas and Type 3:2:1 for turfed or established lawn covered banks is to be supplied and applied by the Contractor at the rate of 400 kg per hectare. In the case of grass planted levelled areas the fertilizer is to be applied either before or after grass planting and in the case of turfed or established lawn covered banks the fertilizer is to be applied after the sods or pieces have been laid. The fertilizer above described is to in addition to any fertilizer which may have been specified to be applied during either the operation of scarifying and grading the area to be grassed or the re-spreading of top soil. A sample of the existing topsoil or the topsoil to be re-spread is to be sent to an approved fertilizer manufacturer for testing and advice on the acid or alkaline content of the soil. The cost of this test is to be borne by the Contractor if this is not provided free by the fertilizer manufacturer. The requisite quantities of limestone ammonium nitrate for acidic soil or ammonium sulphate for alkaline soil as determined by the soil test will be supplied to the Contractor by the Department and the cost thereof is to be included in a Provisional Sum

elsewhere in the Bills of Quantities. The application of this treatment is to be undertaken by the Contractor and his rates for grassing, etc. must include for same. Weed killer: — “Weed Master or Turf Master” or other approved weed killer is to be applied to the entire grassed or turfed areas at a rate of 4 litres mixed with 200 litres of water per hectare, this being equivalent to 40-45 millilitres mixed with 5 litres of water per fifty square metres. The solution is to be sprayed on with a suitable spraying apparatus to achieve an even distribution. Six to eight weeks later, the operation is to be repeated. The application of weed killer is not to take place during wet weather. Weather conditions should be such as to allow a minimum of two hours or absorption before the likelihood of rain. Watering and Rolling: — The entire turfed area is to be kept clear of weeds, lightly rolled and thoroughly watered throughout the period of the Contract and or at least three months from the time of acceptance of the grounds or until the grassing or turfing is well established if that is sooner, all to the satisfaction of the Department. In the absence of rain, the initial watering of grassed or turfed areas is to be carried out as follows: — STANDARD PREAMBLES TO ALL TRADES 8 Rev 3 January 2009 Grass planted levelled areas: - at least twice a week. Established lawn areas: - at least once a week. Turfed areas: - at least once a day for the first ten to fourteen days, thereafter at least once a week. The Contractor must allow in his rates for providing and removing at completion all necessary temporary water piping complete with fittings, sprinklers, hoses, etc. as required for the proper watering of the grassed or turfed areas of the plateaux and banks. Cutting of Grass: — The Contractor must commence mowing as soon as possible once turfed areas have become established and undertake regular mowing at approximately one-week intervals up to the date of final delivery, except that, during the maintenance period, the mowing of the plateaux will be undertaken by the Institution. Note: — All stages of grass planting and turfing are to be supervised on a full time basis by a competent person with the necessary experience and knowledge. It shall be the responsibility of the Contractor to advise the Department when the following operations are to be carried out in order that his representative may be present: — a) the application of fertilizer b) the application of weed killer. Should the Contractor fail to do so, the Department shall have the right to instruct the Contractor to repeat the operation at his own expense. 3.

CONCRETE, FORMWORK AND REINFORCEMENT GENERAL:

This specification applies to concrete work formed into its final shape and position in-situ. All concrete and formwork shall be carried out in accordance with SANS Specification 1200 G — Concrete (Structural) (a copy of which the Contractor will be required to keep on the site so that it can be referred to at all times during the Contract), with the following amplifications and amendments: — INTERPRETATIONS: — Clauses 2.1 and 2.2 of SANS Specification 1200G refer. This preamble, together with any other supplementary preambles appearing in these Bills of Quantities shall be deemed to be the project specification and are the “Portion 2” referred to in Clause 2.2. DEFINITIONS: — Clause 2.3 of SANS Specification 1200 G refers. All references to the Engineer shall be deemed to mean the Department. MATERIALS Cement: —unless otherwise specified, shall be one or more of the following and shall, in each case, comply with the requirements of the relevant standard specification: — Portland cement and rapid-hardening cement to SANS 471 Specification Portland blast-furnace cement to SANS Specification 626. Portland cement 15 to SANS Specification

831. Nevertheless, no cement other than ordinary Portland cement shall be used without the approval of the Department. Cement containing more than 15% blast-furnace slag will not be permitted in columns or in members less than 50mm thick. In addition (for the abovementioned items) where Ordinary Portland cement is used, blastfurnace slag (from separate containers) must not be added in any proportion whatsoever. No mixing of two different types of cement in the same batch will be allowed, and unless otherwise approved by the Department, the same brand and type shall be used in all exposed concrete. STANDARD PREAMBLES TO ALL TRADES 9 Rev 3 January 2009 Lumpy cement, broken sacks and sweepings shall not be used. Cement supplied in sacks shall be used in the order in which it was delivered and shall not be kept in storage for longer than six (6) weeks without the approval of the Department. Water: — Shall be clean and free from injurious amounts of acids, alkalis, sugar, organic matter and other substances that could impair the strength or durability of the concrete. If so required by the Department, the suitability of the water shall be proved by tests carried out by an approved laboratory. Aggregates: — Unless otherwise specified both the coarse aggregate (stone) and the fine aggregate (sand) shall comply with the requirements of SANS Specification 1083. The Contractor is to prove compliance by means of either a certificate from the supplier or by grading analysis tests. Admixtures: — i.e. materials other than cement, aggregate and water shall not be used in the concrete mix without the approval of the Department. The onus for proof of satisfaction to the Department for any admixture proposed shall be with Contractor. Reinforcement: — for concrete shall be as specified and shall, in each case, comply with one of the following: — a) Type A hot rolled mild steel bars of plain round cross section to SANS Specification 920 b) Type C Class 2 hot rolled high yield stress Grade 1 deformed bars to SANS Specification 920 c) Type D Grade 1 cold worked deformed bars to SANS Specification 920. d) Welded steel fabric to SANS Specification 1024 manufactured from plain hard-drawn mild steel wire. A sample reinforcing rod, approximately 600mm long, may be taken from each consignment of rods of similar diameter, for testing. If any sample is found unsatisfactory the whole consignment of rods from which the sample was taken will be rejected. No substitution of the bars specified shall be made without the prior approval of the Department. REINFORCEMENT Bending: — Reinforcing bars shall be cut and bent according to the dimensions shown on the working drawings and in accordance with SANS Specification 82. Except as allowed for below, all bars shall be bent cold and bending shall be done slowly, a steady even pressure being used without jerk or impact. If approved by the Department, hot bending of bars

STRUCTURAL STEEL WORK GENERALLY:

The fabrication, assembly and erection of structural steelwork is to be executed in accordance with SANS Specification 1200H — Structural Steelwork (a copy of which the Contractor will be required to keep on site so that it can be referred to at all times during the Contract) with the following amplifications and amendments: — INTERPRETATIONS: — Clauses 2.1 and 2.2 refer. This preamble, together with any other supplementary preambles appearing in these Bills of Quantities shall be deemed the project specification and are the "Portion 2" referred to in Clause 2.2. DEFINITIONS: — Clause 2.3 of SANS Specification 1200H refers. All references to the Engineer shall be deemed to mean the Department. SUB-CONTRACTORS: —The Contractor shall either (a) have adequate satisfactory and approved

experience in this type of work or (b) employ an approved specialist structural steelwork Sub-Contractor. The Contractor, in the case of (a), or the specialist SubContractor, in the case of (b), shall employ at all stages of the Works both on and off site a competent Supervisor experienced in the work.

MATERIALS: — Unless otherwise shown on the drawings or hereunder, all rolled sections shall be hot rolled mild steel, and all materials shall comply with one of the following: — a) Weldable Structural Steels to SANS 4360: b) Hollow sections to SANS 4848 Part 2 and SANS 6323. c) Cold rolled sections to SANS 2994. d) Black bolts and nuts to SANS 135. e) Precision bolts and nuts to SANS 136. f) High-strength friction-grip bolts and nuts to SANS 1282. g) Flat and tapered washers to SANS 1149. h) Electrodes for welding to SANS 455.

SHOP DETAIL DRAWINGS: — The Contractor shall prepare shop detail drawings, in conformity with the details shown on the structural steelwork drawings and to show all information necessary for complete fabrication, assembly, erection and painting. In the preparation of the shop detail drawings the Contractor is to comply with the requirements of SANS Code of Practice 0162.

STANDARD PREAMBLES TO ALL TRADES 47 Rev 3 January 2009 The cost of preparing all necessary shop detail drawings and copies thereof is to be allowed for by the Contractor in his rates. The Contractor shall submit two copies of his shop detail drawings to the Department for approval at least 10 days before fabrication of the member concerned is due to commence. Such approval does not imply that a complete and comprehensive check of the detail drawings has been carried out, and the Contractor shall remain responsible for ensuring that the steelwork is correctly fabricated, assembled, erected and painted.

SUBSTITUTION OF SIZES, ETC.: — No substitution of sizes or joints additional to those shown on the drawings shall be made without the prior approval of the Department. Except in cases of proven non-availability of materials specified, any additional costs involved due to substitution shall be for the Contractor's account.

FIXINGS: — The positions and manner of fixing the hangers for suspended ceiling airconditioning ducts, pipe installations, etc. to the structural steelwork are to be approved by the Department before work on such installations commences.

FABRICATION, ASSEMBLY AND ERECTION Welding: — shall be carried out in accordance with SANS Code of Practice 044 and the relevant recommendations of SANS Code of Practice 0162 and SANS 5135, and in any case of conflict, the SANS Codes of Practice shall be deemed as binding. All welders employed on the Works shall be currently classified at least as grade 2 welders as defined by SANS Code of Practice 044. Should the Department so request, proof of the classification shall be produced. Unless otherwise specified all welds are to be continuous fillet welds of 6mm leg length or not less than the thinnest plate or section being welded.

Handling, Storage and Erection: — of members is to be undertaken in such a manner to prevent overstress or damage. Should overstress or damage occur, the Department shall be informed and his instructions sought. Storage shall be arranged such that damage to applied finishes is prevented. All plant and equipment used in the erection of structural steelwork shall be adequate in every respect. The Contractor shall allow in his rates for all necessary temporary bracing, and for maintaining and finally removing such temporary bracing.

Fixing of Bolts, etc.: — Unless approved by the Department, no pre-drilled fixings for bolts, etc. will be permitted through hollow section members. Any hollow section member that has been drilled or punctured in any way shall be considered condemned and must be replaced to the satisfaction of the Department.

INSPECTION AND TESTING Facility for Inspection: — The Contractor shall

afford to the Department all reasonable access to inspect the steelwork at any stage of its fabrication, and shall give due notice before delivery of steelwork to the site to allow inspection and tests to be conducted if so required by the Department. Cost of Tests: — The cost of all tests required by the Department shall be borne by the Administration, except that the costs of the following tests shall be borne by the Contractor:- (a) Testing of welders and equipment (b) Such tests (including load tests) as may be necessary by failure on the part of the Contractor to meet the requirements of the specification. Procedure in the Event of Failure: — In the event of a failure of a test, the Contractor shall STANDARD PREAMBLES TO ALL TRADES 48 Rev 3 January 2009 either replace the defective item or prove its sufficiency by means of a load test carried out in accordance with Appendix B of Chapter 6 of the South African Standard Building Regulations.

PROVINCE OF KWAZULU-NATAL
DEPARTMENT OF HEALTH

ZNQ –

EMS BASE IXOPO – SUPPLY, DELIVER AND INSTALL INFORMATION BOARD AT
EMS BASE IXOPO.

TECHNICAL SPECIFICATIONS

2. TECHNICAL SPECIFICATION

2.1 GENERAL

This TECHNICAL SPECIFICATION shall be read in conjunction with all other sections of the SPECIFICATION and cognisance shall be taken of the clauses relevant to this particular installation, whether any specific clauses are referred to or not.

2.2 *Standard Preambles*

This is available from the department on request.

2.3 *Health and Safety Specification*

Health and Safety Plan with Risk assessment schedule is to be compiled taking cognisance of the specific type of patient's that walk around the institution all day. All areas are to be protected at all times from patients falling in. All new and old materials are to be securely stored during construction to eliminate any person from rolling them around or playing inside them.

Grading: 1 GB AND Above

CIDB COMPLIANCE

- 2.4 Amendments: Functionality in different contracting strategies in line with regulations 4.3.3 of the CIDB regulations, where functionality is evaluated, at least three Persons who are fully conversant with the Technical aspects of the scope of works shall undertake such evaluation.**

**PROVINCE OF KWAZULU-NATAL
DEPARTMENT OF HEALTH**

ZNQ –

**EMS BASE IXOPO – SUPPLY, DELIVER AND INSTALL INFORMATION BOARD AT
EMS BASE IXOPO.**

3. SCOPE OF WORK

The work to be carried out under this contract includes the supply of all materials, and including all labour to carry out all electrical work and leaving in service condition to the satisfaction of the Secretary for Health: KwaZulu-Natal.

3.1. The work comprises of

3.3.11 Supply and install the following:

- (a) Earthworks – excavation of trenches for the steel poles.
- (b) Concrete to secure the poles
- (c) Frames to hold the boards.
- (d) Information boards

Note: Work to re measured on completion

Item no.	Description	Unit	Qty.	Rate	Amount
1.	<p align="center"><u>BILL NO. 2.</u></p> <p>CONCRETE, FORMWORK AND REINFORCEMENTS.</p> <p>The Tenderer is referred to the relevant Clauses in the Model Preambles to All Trades and to the Supplementary Preambles which are incorporated at the back of these Bills of Quantities.</p> <p>Unless otherwise described the preambles and full descriptions of all items appearing in all the bills of the preceding section are to apply equally to this section.</p> <p>Unreinforced concrete -15 mPa/19 mm concrete stones. All concrete is to be effectively cured.</p> <p>Footings and bases are to be kept wet for 7 days. Columns are to be wrapped in plastic for 7 days. Slabs are to be covered with plastic for 7 Days</p> <p><u>The concrete will utilized to secure all the poles (two poles and two supports) trench size: 300 x 300 x 800mm deep</u></p> <p>Supply, deliver and cast concrete:</p> <p>concrete</p>	m ³	0.29		
	<p>Carried to Final Summary Concrete, formwork and reinforcements</p>				R

Item no.	Description	Unit	Qty.	Rate	Amount
	<u>BILL NO 3</u>				
	STRUCTURAL STEEL WORK				
	CPAP WORK GROUP NO. 144 UNLESS OTHERWISE STATED)				
	The Contractor is referred to the relevant Clauses in the separate document Specifications of Materials and Methods to be Used (PW 371) Fourth Revision October 1993.				
	<u>Note: for all frames / steel work use hot dipped galvanized steel only. Thickness to be 2mm</u>				
	Supply, deliver and install:				
1.	5 665 x 75 x 75mm square tube (to carry the boards)	no.	01.		
2.	3 500 x 38 x38mm square tubes (to support the uprights)	no.	01.		
	<u>25x25mm mild steel frame for sign board as manufactured by specialist. (refer to Drawing 1)</u> <u>The width of the frame is 3 000mm.</u>				
3.	Frame 1	no.	01.		
4.	Frame 2	no.	01.		
5.	Frame 3	no.	01.		
	Reflective vinyl lettering on 0.8mm thick Chromadek sheeting pop-riverted onto mild steel frame. (Refer to Drawing 2). <u>The width of the board is 3 000mm.</u>				
6.	Board for frame 1	no.	01.		
7.	Board for frame 2	no.	01.		
8.	Board for frame 3	no.	01.		
	Carried to Final Summary Structural steel work				R

Item no.	Description	Page no.	Amount
<u>FINAL SUMMARY</u>			
1.	Earthworks.	14.	
2.	Concrete, formwork and reinforcements.	15.	
3.	Structural steel work.	16.	
Carried to quotation form			R

The following documents must be returned with the quotation:

- CIDB Registration certificate under 1 GB and Above
- Valid Tax Clearance

COMPILED BY: C.B. Ngcobo *C. Ngcobo*
 CHIEF WORKS INSPECTOR AT HARRY GWALA HEALTH DISTRICT

CHECKED BY: B.J ZINDELA *B.J. Zindele*
 DISTRICT ENGINEER AT HARRY GWALA HEALTH DISTRICT

IMPORTANT

THIS FORM IS ONLY TO BE INCLUDED AND COMPLETED WHEN APPLICABLE TO THE QUOTATION.

OFFICIAL BRIEFING SESSION / SITE INSPECTION CERTIFICATE

Site/building/institution involved: **EMS BASE IXOPO.**

Quotation No.: **ZNQ -**

Service: **SUPPLY, DELIVER AND INSTALL INFORMATION BOARD AT EMS BASE IXOPO.**

THIS IS TO CERTIFY THAT..... OF (STATE NAME OF TENDERER) VISITED AND INSPECTED THE SITE ON (DATE) AND IS THEREFORE FAMILIAR WITH THE CIRCUMSTANCES AND THE SCOPE OF THE SERVICE TO BE RENDERED.

.....
SIGNATURE OF TENDERER OR AUTHORISED REPRESENTATIVE

DATE :

.....
SIGNATURE OF DEPARTMENTAL REPRESENTATIVE

DEPARTMENTAL STAMP:

DATE :



SUPPLY, DELIVER AND INSTALL INFORMATION BOARD AT EMS BASE IXOPO.

CRITERIA	POINT ALLOCATION	CONTRACTOR POINTS OBTAINED	COMMENTS
One verifiable order of similar work with completion certificate.	10		
Director /shareholder with relevant qualifications in the construction industry or the qualification of the Artisan who is going to execute the job. He / She has to be present on site during construction work	30		
Attach, the letter of good standing	10		
Attach, active CIDB	20		
Attach, EPWP attendance register and payment certificate.	10		
Locality 0 to 100 km = 20 points 101 to 300km 10 points	20		
Total points	100		

Minimum points required is 50

On appointment compliance with the following:

- Submission of site specific health and safety file.
- Covid 19 compliance
- Signing of site hand over certificate.
- Contractors staff to have identifiable workwear.
- Compliance with EPWP requirements.
- Submission of contractors program.
- Penalties will be imposed on defaulting contractors, formula as follows $(0.00275 \times \text{total cost}) = \text{cost per day}$
- Contractors are requested to sign this document.

CONTRACTOR DETAILS

Initials and Surname: _____ Signature _____

Note: the Safety file is required within 14 working days after the Contractor has been awarded

1006 W
S

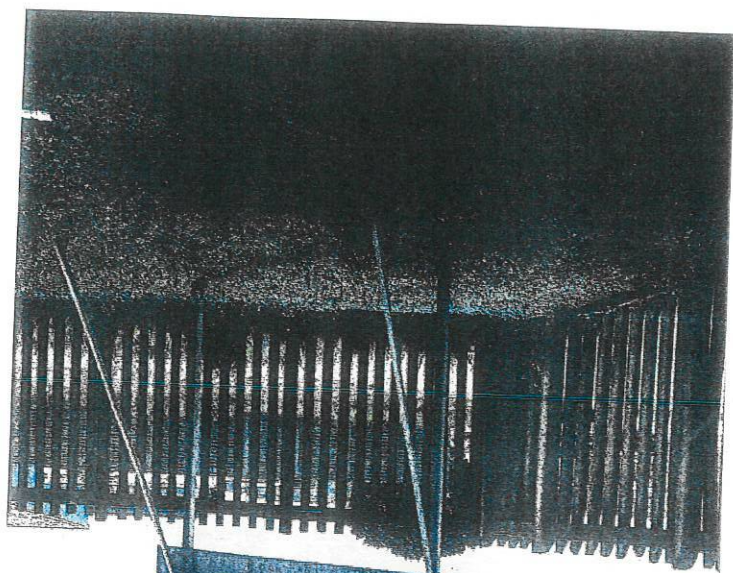
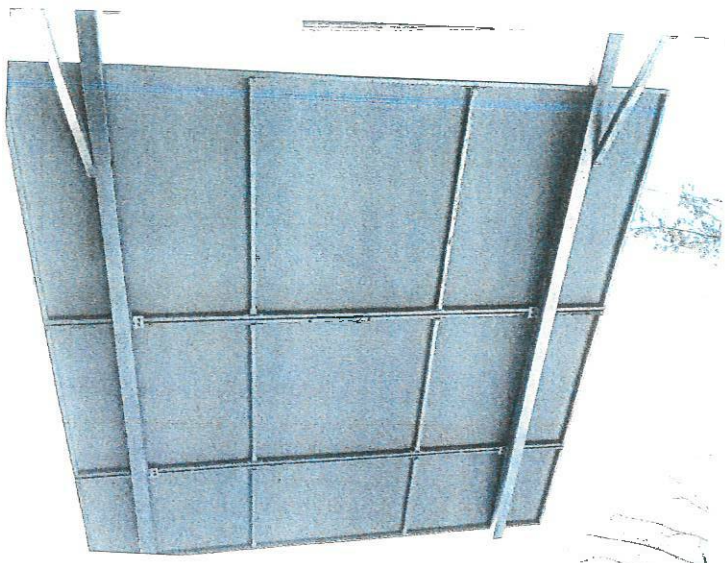

→ FRAME 3.
→ FRAME 2.
→ FRAME 1.



BOARD SUITABLE FOR FRAME 1.

BOARD SUITABLE FOR FRAME 2.

BOARD SUITABLE FOR FRAME 3.

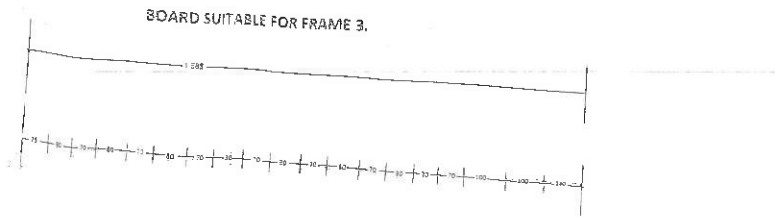
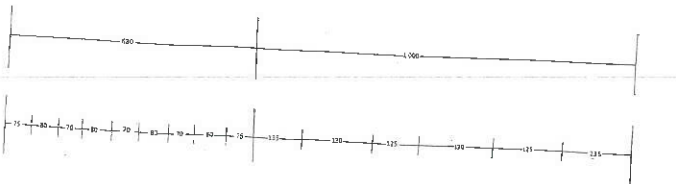

Drawing 2

[Signature]
 17/02/2021