



KWAZULU-NATAL PROVINCE
HEALTH
REPUBLIC OF SOUTH AFRICA

Quotation Advert

Opening Date: 28 July 2022
 Closing Date: 08 August 2022
 Closing Time: 11:00

INSTITUTION DETAILS

Institution Name: Select... Hlangisizwe CHC
 Province: KwaZulu-Natal
 Department or Entity: Department of Health
 Division or section: Central Supply Chain Management
 Place where goods / services is required: Hlangisizwe CHC
 Date Submitted:

ITEM CATEGORY AND DETAILS

Quotation Number: ZNQ: 172/22/23
 Item Category: Select... Services
 Item Description: Supply and install x2 shelters for KZN vehicles
 Quantity (if supplies):

COMPULSORY BRIEFING SESSION / SITE VISIT

Select Type: Select... Site meeting
 Date: 04 August 2022
 Time: 13:00
 Venue: Hlangisizwe CHC

QUOTES CAN BE COLLECTED FROM: Downloaded/Hlangisizwe CHC

QUOTES SHOULD BE DELIVERED TO: Hlangisizwe CHC

ENQUIRIES REGARDING THE ADVERT MAY BE DIRECTED TO:

Name: M Dlamini
 Email: Mmusawenkosi.Dlamini@kznhealth.gov.za
 Contact Number: 031 774 0620

Finance Manager Name:

M.P. Kumar

Finance Manager Signature:

No late quotes will be considered

HLENGISIZWE CHC
SPECIFICATION

INSTALLATION OF CANTILEVER SHADE PORTS AT HLENGISIZWE CHC

1. SCOPE OF CONTRACT:

This contract calls for the supply and installation of 3 by 25m x 5m; cantilever shade ports at main parking area at Hlengisizwe CHC.

Dimensions

- Height - 2,3m
- Width - 5m
- 50mm Cantilever post
- All substructure is 50 x 2mm hot dipped galvanized tubular section.
- Support column is 152mm x 3mm and 60 x 2mm brace round hot dipped galvanized tube into a 1.00 x 100m foundation . 20mpa
- Colour - green
- High density polyethylene shade cloth – no rotting
- Double stitching using 400 denier monofilament tread.
- Picture attached

1.KZN VEHICLE PARKING

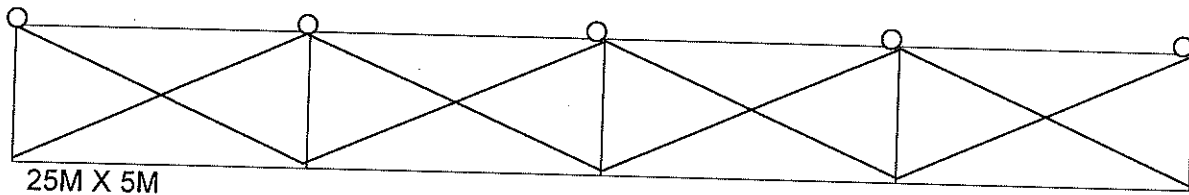

2.KZN VEHICLE PARKING

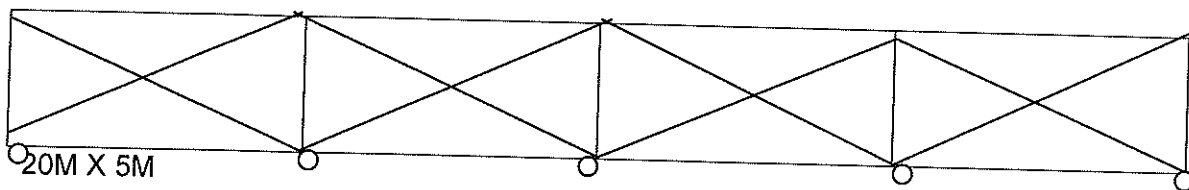

3.MANAGEMENT PARKING

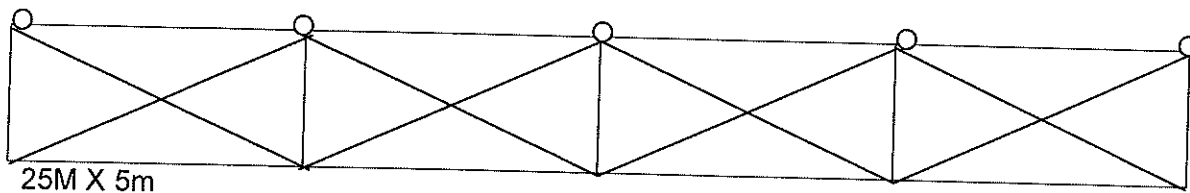

1.1 REQUIREMENTS: -

Tenderers are to make special note of the following: -

1. Prior to tendering, tenderers are advised to visit the Site and acquaint themselves fully with site conditions, nature and full extent of the work involved. Claims on the grounds of insufficient information in such respects or otherwise will not be entertained by the Administration.
2. **Competent workmen skilled in their trades shall carry out all work.** Quality of work shall be of the best standard practice and all workmanship shall be subject to the approval of the Systems Manager / CHC Manager of the Department of Health. Only new materials of the best quality shall be installed and must be SABS approved and marked .
3. **Attach reference of previous cantilever shade ports undertaken**
4. During the progress of work, the Contractor shall carefully clean up after his men and shall leave the premises and portions of the building in which his men have been working clean and free from debris.
5. The work contained in this Contract will be carried out within Hlengisizwe CHC. The Contractor will be required to conform to the security and other regulations imposed by the Health Services Department and, in addition, are to provide suitable means of identification of all workmen employed on the works to the approval of the Systems Manager : Department of Health.
6. The Contractor is advised that the premises will be occupied during and towards the end of the Contract.
7. Sanitary Conveniences. Tenderers are advised that they will be permitted to use certain existing sanitary conveniences on the site and they must allow for maintaining these in a clean condition.
8. Any damage to the existing fittings shall be made good at the Contractor's expense.
9. All work to be carried in accordance with the standard preambles to all trades.
10. Contractors are to ensure that they are registered with the CIDB.
11. Contractors are to take note time is of the essence and the contract period must be strictly adhered to.
12. CIDB certificate must be attached on the quotation.
13. A letter of good standing is required.

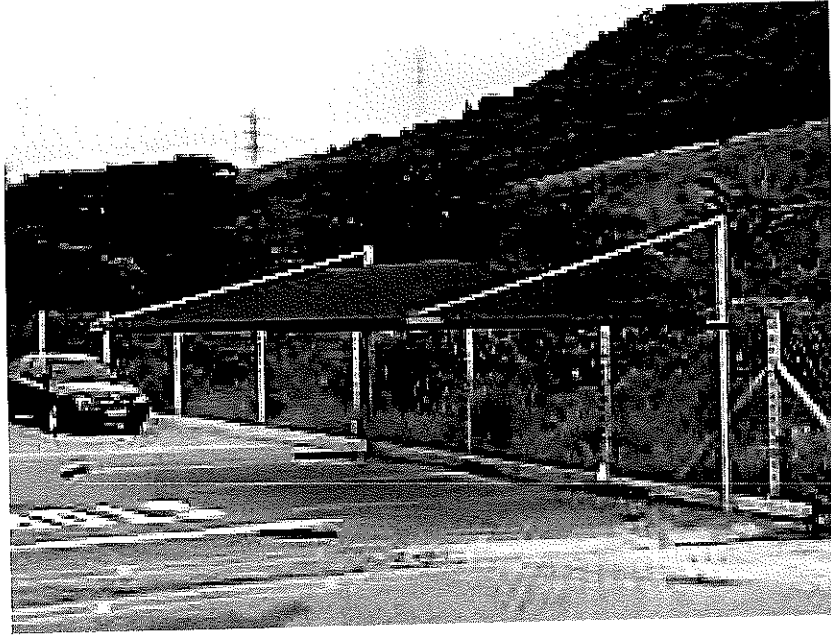

CANTILEVER SHADED PORT