



Quotation Advert

Opening Date: 01/09/2023
Closing Date: 11/09/2023
Closing Time: 11:00

INSTITUTION DETAILS

Institution Name: St Apollinaris Hospital
Province: KwaZulu-Natal
Department of entity: Department of Health
Division or section: Central Supply Chain Management
**Place where goods/
service is required:** St Apollinaris Hospital
Date Submitted: 01/09/2023

ITEM CATEGORY AND DETAILS

Quotation number: SAP 99-2023-2024
Item Category: Services
Item Description: Service provider to repair pharmacy area etc.
Quantity (if supplies):

COMPULSORY BRIEFING SESSION / SITE VISIT

Select Type: Both
Date: 06/09/2023
Time: 11:00am
Venue: LECTURE HALL

QUOTES CAN BE COLLECTED FROM: uploaded on website

QUOTES SHOULD BE DELIVERED TO: Security tender box

ENQUIRIES REGARDING ADVERT MAY BE DIRECTED TO:

Name: MN SOKHELA/ KP MAKHANYA

Email: N/A

Contact number: 039 8339001

Finance Manager Name: Mrs MB Kheswa

Finance Manager Signature 

OFFICIAL PRICE TAG FOR QUOTATIONS OVER R2 000.01

QUOTE NUMBER: ZNQ / SAP / 99 / 2023 / 2024

DESCRIPTION: SERVICE PROVIDER TO REPAIR PHARMACY AREA AND OPENING OF NEW WINDOWS + ENTRANC

PREFERENCE POINTS WILL BE ALLOCATED ACCORDING TO THE IMPLEMENTATION OF SPECIFIC GOALS IN TERMS OF PPR 2022:	POINTS ALLOCATED
Promotion of Enterprises manufacturing in the Province of KwaZulu-Natal	20

ICN NUMBER	QUANTITY	UNIT OF MEASURE	DESCRIPTION	BRAND & MODEL	COUNTRY OF MANUFACTUR E	PRICE	
						R	C
			SERVICE PROVIDER TO REPAIR PHARMACY AREA AND OPENING OF NEW WINDOWS AND ENTRANCE				
			NB: BBBEE SWORN AFFIDAVIT OR BBBEE CERTIFICATE MUST BE INCLUDED AS PART OF MANDATORY REQUIREMENT				
			BEC MIGHT CONDUCT SITE VISIT WITH SHORTLISTED BIDDERS PRIOR TO THE ADJUDICATION SO BE PREPARED				
			SUPPLIER MUST BE CIDB 1GB OR ABOVE				
VALUE ADDED TAX @ 15% (Only if VAT Vendor)							
TOTAL QUOTATION PRICE (VALIDITY PERIOD 90 Days)							

DOES THIS OFFER COMPLY WITH THE SPECIFICATION? YES / NO
 IS THE PRICE FIRM? YES / NO
 DOES THE ARTICLE CONFORM TO THE S.A.N.S. / S.A.B.S. SPECIFICATION? YES / NO

STATE DELIVERY PERIOD (E.G. 3 DAYS, 1 WEEK) _____

NAME OF BIDDER: _____

SIGNATURE OF BIDDER: _____
 [By signing this document, I hereby agree to all terms and conditions]

CAPACITY UNDER WHICH THIS QUOTE IS SIGNED: _____

DATE: _____

BIDDER'S DISCLOSURE

1 PURPOSE OF THE FORM

Any person (natural or juristic) may make an offer or offers in terms of this invitation to bid. In line with the principles of transparency, accountability, impartiality, and ethics as enshrined in the Constitution of the Republic of South Africa and further expressed in various pieces of legislation, it is required for the bidder to make this declaration in respect of the details required hereunder.

Where a person/s are listed in the Register for Tender Defaulters and / or the List of Restricted Suppliers, that person will automatically be disqualified from the bid process.

2 BIDDER'S DECLARATION

2.1. Is the bidder, or any of its directors / trustees / shareholders / members / partners or any person having a controlling interest¹ in the enterprise, employed by the state? **YES / NO**

2.1.1. If so, furnish particulars of the names, individual identity numbers, and, if applicable, state employee numbers of sole proprietor/ directors / trustees / shareholders / members/ partners or any person having a controlling interest in the enterprise, in table below.

FULL NAME	IDENTITY NUMBER	NAME OF STATE INSTITUTION

2.2. Do you, or any person connected with the bidder, have a relationship with any person who is employed by the procuring institution? **YES / NO**

2.2.1. If so, furnish particulars: _____

2.3. Does the bidder or any of its directors / trustees / shareholders / members / partners or any person having a controlling interest in the enterprise have any interest in any other related enterprise whether or not they are bidding for this contract? **YES / NO**

2.3.1. If so, furnish particulars: _____

3 DECLARATION

I, the undersigned, (name) _____ in submitting the accompanying bid, do hereby make the following statements that I certify to be true and complete in every respect:

- 3.1. I have read and I understand the contents of this disclosure;
- 3.2. I understand that the accompanying bid will be disqualified if this disclosure is found not to be true and complete in every respect;
- 3.3. The bidder has arrived at the accompanying bid independently from, and without consultation, communication, agreement or arrangement with any competitor. However, communication between partners in a joint venture or consortium² will not be construed as collusive bidding.
- 3.4. In addition, there have been no consultations, communications, agreements or arrangements with any competitor regarding the quality, quantity, specifications, prices, including methods, factors or formulas used to calculate prices, market allocation, the intention or decision to submit or not to submit the bid, bidding with the intention not to win the bid and conditions or delivery particulars of the products or services to which this bid invitation relates.
- 3.5. The terms of the accompanying bid have not been, and will not be, disclosed by the bidder, directly or indirectly, to any competitor, prior to the date and time of the official bid opening or of the awarding of the contract.
- 3.6. There have been no consultations, communications, agreements or arrangements made by the bidder with any official of the procuring institution in relation to this procurement process prior to and during the bidding process except to provide clarification on the bid submitted where so required by the institution; and the bidder was not involved in the drafting of the specifications or terms of reference for this bid.
- 3.7. I am aware that, in addition and without prejudice to any other remedy provided to combat any restrictive practices related to bids and contracts, bids that are suspicious will be reported to the Competition Commission for investigation and possible imposition of administrative penalties in terms of section 59 of the Competition Act No 89 of 1998 and or may be reported to the National Prosecuting Authority (NPA) for criminal investigation and or may be restricted from conducting business with the public sector for a period not exceeding ten (10) years in terms of the Prevention and Combating of Corrupt Activities Act No 12 of 2004 or any other applicable legislation.

I CERTIFY THAT THE INFORMATION FURNISHED IN PARAGRAPHS 1, 2 and 3 ABOVE IS CORRECT.

I ACCEPT THAT THE STATE MAY REJECT THE BID OR ACT AGAINST ME IN TERMS OF PARAGRAPH 6 OF PFMA SCM INSTRUCTION 03 OF 2021/22 ON PREVENTING AND COMBATING ABUSE IN THE SUPPLY CHAIN MANAGEMENT SYSTEM SHOULD THIS DECLARATION PROVE TO BE FALSE.

NAME OF BIDDER	SIGNATURE	POSITION	DATE

¹ the power, by one person or a group of persons holding the majority of the equity of an enterprise, alternatively, the person/s having the deciding vote or power to influence or to direct the course and decisions of the enterprise.

² Joint venture or Consortium means an association of persons for the purpose of combining their expertise, property, capital, efforts, skill and knowledge in an activity for the execution of a contract.

GENERAL CONDITIONS OF CONTRACT

NOTES

The purpose of this document is to:

- (i) Draw special attention to certain general conditions applicable to government bids, contracts and orders; and
- (ii) To ensure that clients be familiar with regard to the rights and obligations of all parties involved in doing business with government.

In this document words in the singular also mean in the plural and vice versa and words in the masculine also mean in the feminine and neuter.

- The General Conditions of Contract will form part of all bid/quotation documents and may not be amended.
- Special Conditions of Contract (SCC) relevant to a specific bid, should be compiled separately for every bid (if applicable) and will supplement the General Conditions of Contract. Whenever there is a conflict, the provisions in the SCC shall prevail.

1 Definitions

The following terms shall be interpreted as indicated:

- 1.1. "Closing time" means the date and hour specified in the bidding documents for the receipt of bids.
- 1.2. "Contract" means the written agreement entered into between the purchaser and the supplier, as recorded in the contract form signed by the parties, including all attachments and appendices thereto and all documents incorporated by reference therein.
- 1.3. "Contract price" means the price payable to the supplier under the contract for the full and proper performance of his contractual obligations.
- 1.4. "Corrupt practice" means the offering, giving, receiving, or soliciting of any thing of value to influence the action of a public official in the procurement process or in contract execution.
- 1.5. "Countervailing duties" are imposed in cases where an enterprise abroad is subsidized by its government and encouraged to market its products internationally.
- 1.6. "Country of origin" means the place where the goods were mined, grown or produced or from which the services are supplied. Goods are produced when, through manufacturing, processing or substantial and major assembly of components, a commercially recognized new product results that is substantially different in basic characteristics or in purpose or utility from its components.
- 1.7. "Day" means calendar day.
- 1.8. "Delivery" means delivery in compliance of the conditions of the contract or order.
- 1.9. "Delivery ex stock" means immediate delivery directly from stock actually on hand.
- 1.10. "Delivery into consignees store or to his site" means delivered and unloaded in the specified store or depot or on the specified site in compliance with the conditions of the contract or order, the supplier bearing all risks and charges involved until the supplies are so delivered and a valid receipt is obtained.
- 1.11. "Dumping" occurs when a private enterprise abroad market its goods on own initiative in the RSA at lower prices than that of the country of origin and which have the potential to harm the local industries in the RSA
- 1.12. "Force majeure" means an event beyond the control of the supplier and not involving the supplier's fault or negligence and not foreseeable. Such events may include, but is not restricted to, acts of the purchaser in its sovereign capacity, wars or revolutions, fires, floods, epidemics, quarantine restrictions and freight embargoes.
- 1.13. "Fraudulent practice" means a misrepresentation of facts in order to influence a procurement process or the execution of a contract to the detriment of any bidder, and includes collusive practice among bidders (prior to or after bid submission) designed to establish bid prices at artificial non-competitive levels and to deprive the bidder of the benefits of free and open competition.
- 1.14. "GCC" means the General Conditions of Contract.
- 1.15. "Goods" means all of the equipment, machinery, and/or other materials that the supplier is required to supply to the purchaser under the contract.
- 1.16. "Imported content" means that portion of the bidding price represented by the cost of components, parts or materials which have been or are still to be imported (whether by the supplier or his subcontractors) and which costs are inclusive of the costs abroad, plus freight and other direct importation costs such as landing costs, dock dues, import duty, sales duty or other similar tax or duty at the South African place of entry as well as transportation and handling charges to the factory in the Republic where the supplies covered by the bid will be manufactured.
- 1.17. "Local content" means that portion of the bidding price which is not included in the imported content provided that local manufacture does take place.
- 1.18. "Manufacture" means the production of products in a factory using labour, materials, components and machinery and includes other related value-adding activities.
- 1.19. "Order" means an official written order issued for the supply of goods or works or the rendering of a service.
- 1.20. "Project site," where applicable, means the place indicated in bidding documents.
- 1.21. "Purchaser" means the organization purchasing the goods.
- 1.22. "Republic" means the Republic of South Africa.
- 1.23. "SCC" means the Special Conditions of Contract.
- 1.24. "Services" means those functional services ancillary to the supply of the goods, such as transportation and any other incidental services, such as installation, commissioning, provision of technical assistance, training, catering, gardening, security, maintenance and other such obligations of the supplier covered under the contract.
- 1.25. "Written" or "in writing" means handwritten in ink or any form of electronic or mechanical writing.

2 Application

- 2.1. These general conditions are applicable to all bids, contracts and orders including bids for functional and professional services, sales, hiring, letting and the granting or acquiring of rights, but excluding immovable property, unless otherwise indicated in the bidding documents.
- 2.2. Where applicable, special conditions of contract are also laid down to cover specific supplies, services or works.
- 2.3. Where such special conditions of contract are in conflict with these general conditions, the special conditions shall apply.

3 General

- 3.1. Unless otherwise indicated in the bidding documents, the purchaser shall not be liable for any expense incurred in the preparation and submission of a bid. Where applicable a non-refundable fee for documents may be charged.
- 3.2. With certain exceptions, invitations to bid are only published in the Government Tender Bulletin. The Government Tender Bulletin may be obtained directly from the Government Printer, Private Bag X85, Pretoria 0001, or accessed electronically from www.treasury.gov.za



4 Standards

4.1. The goods supplied shall conform to the standards mentioned in the bidding documents and specifications.

5 Use of contract documents and information; inspection.

5.1. The supplier shall not, without the purchaser's prior written consent, disclose the contract, or any provision thereof, or any specification, plan, drawing, pattern, sample, or information furnished by or on behalf of the purchaser in connection therewith, to any person other than a person employed by the supplier in the performance of the contract. Disclosure to any such employed person shall be made in confidence and shall extend only so far as may be necessary for purposes of such performance.

5.2. The supplier shall not, without the purchaser's prior written consent, make use of any document or information mentioned in GCC clause 5.1 except for purposes of performing the contract.

5.3. Any document, other than the contract itself mentioned in GCC clause 5.1 shall remain the property of the purchaser and shall be returned (all copies) to the purchaser on completion of the supplier's performance under the contract if so required by the purchaser.

5.4. The supplier shall permit the purchaser to inspect the supplier's records relating to the performance of the supplier and to have them audited by auditors appointed by the purchaser, if so required by the purchaser.

6 Patent rights

6.1. The supplier shall indemnify the purchaser against all third-party claims of infringement of patent, trademark, or industrial design rights arising from use of the goods or any part thereof by the purchaser.

7 Performance security

7.1. Within thirty (30) days of receipt of the notification of contract award, the successful bidder shall furnish to the purchaser the performance security of the amount specified in SCC.

7.2. The proceeds of the performance security shall be payable to the purchaser as compensation for any loss resulting from the supplier's failure to complete his obligations under the contract.

7.3. The performance security shall be denominated in the currency of the contract, or in a freely convertible currency acceptable to the purchaser and shall be in one of the following forms:

(a) a bank guarantee or an irrevocable letter of credit issued by a reputable bank located in the purchaser's country or abroad, acceptable to the purchaser, in the form provided in the bidding documents or another form acceptable to the purchaser; or

(b) a cashier's or certified cheque

7.4. The performance security will be discharged by the purchaser and returned to the supplier not later than thirty (30) days following the date of completion of the supplier's performance obligations under the contract, including any warranty obligations, unless otherwise specified in SCC.

8 Inspections, tests and analyses

8.1. All pre-bidding testing will be for the account of the bidder.

8.2. If it is a bid condition that supplies to be produced or services to be rendered should at any stage during production or execution or on completion be subject to inspection, the premises of the bidder or contractor shall be open, at all reasonable hours, for inspection by a representative of the Department or an organization acting on behalf of the Department.

8.3. If there are no inspection requirements indicated in the bidding documents and no mention is made in the contract, but during the contract period it is decided that inspections shall be carried out, the purchaser shall itself make the necessary arrangements, including payment arrangements with the testing authority concerned.

8.4. If the inspections, tests and analyses referred to in clauses 8.2 and 8.3 show the supplies to be in accordance with the contract requirements, the cost of the inspections, tests and analyses shall be defrayed by the purchaser.

8.5. Where the supplies or services referred to in clauses 8.2 and 8.3 do not comply with the contract requirements, irrespective of whether such supplies or services are accepted or not, the cost in connection with these inspections, tests or analyses shall be defrayed by the supplier.

8.6. Supplies and services which are referred to in clauses 8.2 and 8.3 and which do not comply with the contract requirements may be rejected.

8.7. Any contract supplies may on or after delivery be inspected, tested or analyzed and may be rejected if found not to comply with the requirements of the contract. Such rejected supplies shall be held at the cost and risk of the supplier who shall, when called upon, remove them immediately at his own cost and forthwith substitute them with supplies which do comply with the requirements of the contract. Failing such removal the rejected supplies shall be returned at the suppliers cost and risk. Should the supplier fail to provide the substitute supplies forthwith, the purchaser may, without giving the supplier further opportunity to substitute the rejected supplies, purchase such supplies as may be necessary at the expense of the supplier.

8.8. The provisions of clauses 8.4 to 8.7 shall not prejudice the right of the purchaser to cancel the contract on account of a breach of the conditions thereof, or to act in terms of Clause 23 of GCC.

9 Packing

9.1. The supplier shall provide such packing of the goods as is required to prevent their damage or deterioration during transit to their final destination, as indicated in the contract. The packing shall be sufficient to withstand, without limitation, rough handling during transit and exposure to extreme temperatures, salt and precipitation during transit, and open storage. Packing, case size and weights shall take into consideration, where appropriate, the remoteness of the goods' final destination and the absence of heavy handling facilities at all points in transit.

9.2. The packing, marking, and documentation within and outside the packages shall comply strictly with such special requirements as shall be expressly provided for in the contract, including additional requirements, if any, specified in SCC, and in any subsequent instructions ordered by the purchaser.

10 Delivery and documents

10.1. Delivery of the goods shall be made by the supplier in accordance with the terms specified in the contract. The details of shipping and/or other documents to be furnished by the supplier are specified in SCC.

10.2. Documents to be submitted by the supplier are specified in SCC.

11 Insurance

11.1. The goods supplied under the contract shall be fully insured in a freely convertible currency against loss or damage incidental to manufacture or acquisition, transportation, storage and delivery in the manner specified in the SCC.

- 12 Transportation**
- 12.1. Should a price other than an all-inclusive delivered price be required, this shall be specified in the SCC.
- 13 Incidental services**
- 13.1. The supplier may be required to provide any or all of the following services, including additional services, if any, specified in SCC:
- (a) performance or supervision of on-site assembly and/or commissioning of the supplied goods;
 - (b) furnishing of tools required for assembly and/or maintenance of the supplied goods;
 - (c) furnishing of a detailed operations and maintenance manual for each appropriate unit of the supplied goods;
 - (d) performance or supervision or maintenance and/or repair of the supplied goods, for a period of time agreed by the parties, provided that this service shall not relieve the supplier of any warranty obligations under this contract; and
 - (e) training of the purchaser's personnel, at the supplier's plant and/or on-site, in assembly, start-up, operation, maintenance, and/or repair of the
- 13.2. Prices charged by the supplier for incidental services, if not included in the contract price for the goods, shall be agreed upon in advance by the parties and shall not exceed the prevailing rates charged to other parties by the supplier for similar services.
- 14 Spare parts**
- 14.1. As specified in SCC, the supplier may be required to provide any or all of the following materials, notifications, and information pertaining to spare parts manufactured or distributed by the supplier:
- (a) such spare parts as the purchaser may elect to purchase from the supplier, provided that this election shall not relieve the supplier of any warranty obligations under the contract; and
 - (b) in the event of termination of production of the spare parts:
 - (i) Advance notification to the purchaser of the pending termination, in sufficient time to permit the purchaser to procure needed requirements; and
 - (ii) following such termination, furnishing at no cost to the purchaser, the blueprints, drawings, and specifications of the spare parts, if requested.
- 15 Warranty**
- 15.1. The supplier warrants that the goods supplied under the contract are new, unused, of the most recent or current models, and that they incorporate all recent improvements in design and materials unless provided otherwise in the contract. The supplier further warrants that all goods supplied under this contract shall have no defect, arising from design, materials, or workmanship (except when the design and/or material is required by the purchaser's specifications) or from any act or omission of the supplier, that may develop under normal use of the supplied goods in the conditions prevailing in the country of final destination.
- 15.2. This warranty shall remain valid for twelve (12) months after the goods, or any portion thereof as the case may be, have been delivered to and accepted at the final destination indicated in the contract, or for eighteen (18) months after the date of shipment from the port or place of loading in the source country, whichever period concludes earlier, unless specified otherwise in SCC.
- 15.3. The purchaser shall promptly notify the supplier in writing of any claims arising under this warranty.
- 15.4. Upon receipt of such notice, the supplier shall, within the period specified in SCC and with all reasonable speed, repair or replace the defective goods or parts thereof, without costs to the purchaser.
- 15.5. If the supplier, having been notified, fails to remedy the defect(s) within the period specified in SCC, the purchaser may proceed to take such remedial action as may be necessary, at the supplier's risk and expense and without prejudice to any other rights which the purchaser may have against the supplier under the contract.
- 16 Payment**
- 16.1. The method and conditions of payment to be made to the supplier under this contract shall be specified in SCC.
- 16.2. The supplier shall furnish the purchaser with an invoice accompanied by a copy of the delivery note and upon fulfillment of other obligations stipulated in the contract.
- 16.3. Payments shall be made promptly by the purchaser, but in no case later than thirty (30) days after submission of an invoice or claim by the supplier.
- 16.4. Payment will be made in Rand unless otherwise stipulated in SCC.
- 17 Prices**
- 17.1. Prices charged by the supplier for goods delivered and services performed under the contract shall not vary from the prices quoted by the supplier in his bid, with the exception of any price adjustments authorized in SCC or in the purchaser's request for bid validity extension, as the case may be.
- 18 Contract amendments**
- 18.1. No variation in or modification of the terms of the contract shall be made except by written amendment signed by the parties concerned.
- 19 Assignment**
- 19.1. The supplier shall not assign, in whole or in part, its obligations to perform under the contract, except with the purchaser's prior written consent.
- 20 Subcontracts**
- 20.1. The supplier shall notify the purchaser in writing of all subcontracts awarded under this contracts if not already specified in the bid. Such notification, in the original bid or later, shall not relieve the supplier from any liability or obligation under the contract.
- 21 Delays in the supplier's performance**
- 21.1. Delivery of the goods and performance of services shall be made by the supplier in accordance with the time schedule prescribed by the purchaser in the contract.
- 21.2. If at any time during performance of the contract, the supplier or its subcontractor(s) should encounter conditions impeding timely delivery of the goods and performance of services, the supplier shall promptly notify the purchaser in writing of the fact of the delay, its likely duration and its cause(s). As soon as practicable after receipt of the supplier's notice, the purchaser shall evaluate the situation and may at his discretion extend the supplier's time for performance, with or without the imposition of penalties, in which case the extension shall be ratified by the parties by amendment of contract.
- 21.3. No provision in a contract shall be deemed to prohibit the obtaining of supplies or services from a national department, provincial department, or a local authority.
- 21.4. The right is reserved to procure outside of the contract small quantities or to have minor essential services executed if an emergency arises, the supplier's point of supply is not situated at or near the place where the supplies are required, or the supplier's services are not readily available.



- 21.5. Except as provided under GCC Clause 25, a delay by the supplier in the performance of its delivery obligations shall render the supplier liable to the imposition of penalties, pursuant to GCC Clause 22, unless an extension of time is agreed upon pursuant to GCC Clause 21.2 without the application of penalties.
- 21.6. Upon any delay beyond the delivery period in the case of a supplies contract, the purchaser shall, without canceling the contract, be entitled to purchase supplies of a similar quality and up to the same quantity in substitution of the goods not supplied in conformity with the contract and to return any goods delivered later at the supplier's expense and risk, or to cancel the contract and buy such goods as may be required to complete the contract and without prejudice to his other rights, be entitled to claim damages from the supplier.
- 22 Penalties**
- 22.1. Subject to GCC Clause 25, if the supplier fails to deliver any or all of the goods or to perform the services within the period(s) specified in the contract, the purchaser shall, without prejudice to its other remedies under the contract, deduct from the contract price, as a penalty, a sum calculated on the delivered price of the delayed goods or unperformed services using the current prime interest rate calculated for each day of the delay until actual delivery or performance. The purchaser may also consider termination of the contract pursuant to GCC Clause 23.
- 23 Termination for default**
- 23.1. The purchaser, without prejudice to any other remedy for breach of contract, by written notice of default sent to the supplier, may terminate this contract in whole or in part:
- (a) if the supplier fails to deliver any or all of the goods within the period(s) specified in the contract, or within any extension thereof granted by the purchaser pursuant to GCC Clause 21.2;
 - (b) if the Supplier fails to perform any other obligation(s) under the contract; or
 - (c) if the supplier, in the judgment of the purchaser, has engaged in corrupt or fraudulent practices in competing for or in executing the contract.
- 23.2. In the event the purchaser terminates the contract in whole or in part, the purchaser may procure, upon such terms and in such manner as it deems appropriate, goods, works or services similar to those undelivered, and the supplier shall be liable to the purchaser for any excess costs for such similar goods, works or services. However, the supplier shall continue performance of the contract to the extent not terminated.
- 23.3. Where the purchaser terminates the contract in whole or in part, the purchaser may decide to impose a restriction penalty on the supplier by prohibiting such supplier from doing business with the public sector for a period not exceeding 10 years.
- 23.4. If a purchaser intends imposing a restriction on a supplier or any person associated with the supplier, the supplier will be allowed a time period of not more than fourteen (14) days to provide reasons why the envisaged restriction should not be imposed. Should the supplier fail to respond within the stipulated fourteen (14) days the purchaser may regard the intended penalty as not objected against and may impose it on the supplier.
- 23.5. Any restriction imposed on any person by the Accounting Officer / Authority will, at the discretion of the Accounting Officer / Authority, also be applicable to any other enterprise or any partner, manager, director or other person who wholly or partly exercises or exercised or may exercise control over the enterprise of the first-mentioned person, and with which enterprise or person the first-mentioned person, is or was in the opinion of the Accounting Officer / Authority actively associated.
- 23.6. If a restriction is imposed, the purchaser must, within five (5) working days of such imposition, furnish the National Treasury, with the following information:
- (i) the name and address of the supplier and / or person restricted by the purchaser;
 - (ii) the date of commencement of the restriction
 - (iii) the period of restriction; and
 - (iv) the reasons for the restriction.
- These details will be loaded in the National Treasury's central database of suppliers or persons prohibited from doing business with the public sector.
- 23.7. If a court of law convicts a person of an offence as contemplated in sections 12 or 13 of the Prevention and Combating of Corrupt Activities Act, No. 12 of 2004, the court may also rule that such person's name be endorsed on the Register for Tender Defaulters. When a person's name has been endorsed on the Register, the person will be prohibited from doing business with the public sector for a period not less than five years and not more than 10 years. The National Treasury is empowered to determine the period of restriction and each case will be dealt with on its own merits. According to section 32 of the Act the Register must be open to the public. The Register can be perused on the National Treasury website.
- 24 Anti-dumping and countervailing duties and rights**
- 24.1. When, after the date of bid, provisional payments are required, or antidumping or countervailing duties are imposed, or the amount of a provisional payment or anti-dumping or countervailing right is increased in respect of any dumped or subsidized import, the State is not liable for any amount so required or imposed, or for the amount of any such increase. When, after the said date, such a provisional payment is no longer required or any such anti-dumping or countervailing right is abolished, or where the amount of such provisional payment or any such right is reduced, any such favourable difference shall on demand be paid forthwith by the contractor to the State or the State may deduct such amounts from moneys (if any) which may otherwise be due to the contractor in regard to supplies or services which he delivered or rendered, or is to deliver or render in terms of the contract or any other contract or any other amount which may be due to him.
- 25 Force Majeure**
- 25.1. Notwithstanding the provisions of GCC Clauses 22 and 23, the supplier shall not be liable for forfeiture of its performance security, damages, or termination for default if and to the extent that his delay in performance or other failure to perform his obligations under the contract is the result of an event of force majeure.
- 25.2. If a force majeure situation arises, the supplier shall promptly notify the purchaser in writing of such condition and the cause thereof. Unless otherwise directed by the purchaser in writing, the supplier shall continue to perform its obligations under the contract as far as is reasonably practical, and shall seek all reasonable alternative means for performance not prevented by the force majeure event.
- 26 Termination for insolvency**
- 26.1. The purchaser may at any time terminate the contract by giving written notice to the supplier if the supplier becomes bankrupt or otherwise insolvent. In this event, termination will be without compensation to the supplier, provided that such termination will not prejudice or affect any right of action or remedy which has accrued or will accrue thereafter to the purchaser.
- 27 Settlement of Disputes**
- 27.1. If any dispute or difference of any kind whatsoever arises between the purchaser and the supplier in connection with or arising out of the contract, the parties shall make every effort to resolve amicably such dispute or difference by mutual consultation.



- 27.2. If, after thirty (30) days, the parties have failed to resolve their dispute or difference by such mutual consultation, then either the purchaser or the supplier may give notice to the other party of his intention to commence with mediation. No mediation in respect of this matter may be commenced unless such notice is given to the other party.
- 27.3. Should it not be possible to settle a dispute by means of mediation, it may be settled in a South African court of law.
- 27.4. Mediation proceedings shall be conducted in accordance with the rules of procedure specified in the SCC.
- 27.5. Notwithstanding any reference to mediation and/or court proceedings herein,
(a) the parties shall continue to perform their respective obligations under the contract unless they otherwise agree; and
(b) the purchaser shall pay the supplier any monies due the supplier.

28 Limitation of liability

- 28.1. Except in cases of criminal negligence or willful misconduct, and in the case of infringement pursuant to Clause 6;
(a) the supplier shall not be liable to the purchaser, whether in contract, tort, or otherwise, for any indirect or consequential loss or damage, loss of use, loss of production, or loss of profits or interest costs, provided that this exclusion shall not apply to any obligation of the supplier to pay penalties and/or damages to the purchaser; and
(b) the aggregate liability of the supplier to the purchaser, whether under the contract, in tort or otherwise, shall not exceed the total contract price, provided that this limitation shall not apply to the cost of repairing or replacing defective equipment.

29 Governing language

- 29.1. The contract shall be written in English. All correspondence and other documents pertaining to the contract that is exchanged by the parties shall also be written in English.

30 Applicable law

- 30.1. The contract shall be interpreted in accordance with South African laws, unless otherwise specified in SCC.

31 Notices

- 31.1. Every written acceptance of a bid shall be posted to the supplier concerned by registered or certified mail and any other notice to him shall be posted by ordinary mail to the address furnished in his bid or to the address notified later by him in writing and such posting shall be deemed to be proper service of such notice.
- 31.2. The time mentioned in the contract documents for performing any act after such aforesaid notice has been given, shall be reckoned from the date of posting of such notice.

32 Taxes and duties

- 32.1. A foreign supplier shall be entirely responsible for all taxes, stamp duties, license fees, and other such levies imposed outside the purchaser's country.
- 32.2. A local supplier shall be entirely responsible for all taxes, duties, license fees, etc., incurred until delivery of the contracted goods to the purchaser.
- 32.3. No contract shall be concluded with any bidder whose tax matters are not in order. Prior to the award of a bid the Department must be in possession of a tax clearance certificate, submitted by the bidder. This certificate must be an original issued by the South African Revenue Services.

33 National Industrial Participation (NIP) Programme

- 33.1. The NIP Programme administered by the Department of Trade and Industry shall be applicable to all contracts that are subject to the NIP obligation.

34 Prohibition of Restrictive practices

- 34.1. In terms of section 4 (1) (b) (iii) of the Competition Act No. 89 of 1998, as amended, an agreement between, or concerted practice by, firms, or a decision by an association of firms, is prohibited if it is between parties in a horizontal relationship and if a bidder (s) is / are or a contractor(s) was / were involved in collusive bidding (or bid rigging).
- 34.2. If a bidder(s) or contractor(s), based on reasonable grounds or evidence obtained by the purchaser, has / have engaged in the restrictive practice referred to above, the purchaser may refer the matter to the Competition Commission for investigation and possible imposition of administrative penalties as contemplated in the Competition Act No. 89 of 1998.
- 34.3. If a bidder(s) or contractor(s), has / have been found guilty by the Competition Commission of the restrictive practice referred to above, the purchaser may, in addition and without prejudice to any other remedy provided for, invalidate the bid(s) for such item(s) offered, and / or terminate the contract in whole or part, and / or restrict the bidder(s) or contractor(s) from conducting business with the public sector for a period not exceeding ten (10) years and / or claim damages from the bidder(s) or contractor(s) concerned.

SPECIAL CONDITIONS OF CONTRACT

1. AMENDMENT OF CONTRACT

- 1.1. Any amendment to or renunciation of the provisions of the contract shall at all times be done in writing and shall be signed by both parties.

2. CHANGE OF ADDRESS

- 2.1. Bidders must advise the Department of Health (institution where the offer was submitted) should their address (domicilium citandi et executandi) details change from the time of bidding to the expiry of the contract.

3. GENERAL CONDITIONS ATTACHED TO THIS QUOTATION

- 3.1. The Department is under no obligation to accept the lowest or any quote.
- 3.2. The Department reserves the right to communicate in writing with vendors in cases where information is incomplete or where there are obscurities regarding technical aspects of the offer, to obtain confirmation of prices or preference claims in cases where it is evident that a typing, written, transfer or unit error has been made, to investigate the vendor's standing and ability to complete the supply/service satisfactorily.
- 3.3. **ALL DECISIONS TAKEN BY THE DEPARTMENT ARE FINAL, INCLUDING THE AWARD OR CANCELLATION OF THIS QUOTATION.**
- 3.4. The price quoted must include VAT (if VAT vendor).
- 3.5. Should a bidder become a VAT vendor after award or during the implementation of a contract, they may not request the VAT percentage from the Department as the service provider made an offer during the period they were not registered as a VAT vendor. The Department is only liable for any VAT from registered VAT vendors as originally stated on the quotation document.
- 3.6. The bidder must ensure the correctness & validity of the quotation:
- (i) that the price(s), rate(s) & preference quoted cover all for the work/item (s) & accept that any mistakes regarding the price (s) & calculations will be at the bidder's risk;
 - (ii) it is the responsibility of the bidder to confirm receipt of their quotation and to keep proof thereof.
- 3.7. The bidder must accept full responsibility for the proper execution & fulfilment of all obligations conditions devolving on under this agreement, as the Principal (s) liable for the due fulfilment of this contract.
- 3.8. This quotation will be evaluated based on the 80/20 points system, specification, correctness of information and/or functionality criteria. All required documentation must be completed in full and submitted.
- 3.9. Offers must comply strictly with the specification.
- 3.10. Only offers that meet or are greater than the specification will be considered.
- 3.11. Late offers will not be considered.
- 3.12. Expired product/s will not be accepted. All products supplied must be valid for a minimum period of six months.
- 3.13. Used/ second-hand products will not be accepted.
- 3.14. A bidder not registered on the Central Suppliers Database or whose verification has failed will not be considered.
- 3.15. All delivery costs must be included in the quoted price for delivery at the prescribed destination.
- 3.16. Only firm prices will be accepted. Such prices must remain firm for the contract period. Non-firm prices (including rates of exchange variations) will not be considered.
- 3.17. In cases where different delivery points influence the pricing, a separate pricing schedule must be submitted for each delivery point.
- 3.18. In the event of a bidder having multiple quotes, only the cheapest according to specification will be considered.
- 3.19. Verification will be conducted to identify if bidders have multiple companies and are cover-quoting for this bid.
- 3.20. In such instances, the Department reserves the right to immediately disqualify such bidders as cover-quoting is an offence that represents both corruption and acquisition fraud.

4. SPECIAL INSTRUCTIONS AND NOTICES TO BIDDERS REGARDING THE COMPLETION OF THIS QUOTATION.

- 4.1. Unless inconsistent with or expressly indicated otherwise by the context, the singular shall include the plural and vice versa and with words importing the masculine gender shall include the feminine and the neuter.
- 4.2. Under no circumstances whatsoever may the quotation/bid forms be retyped or redrafted. Photocopies of the original bid documentation may be used, but an original signature must appear on such photocopies.
- 4.3. The bidder is advised to check the number of pages and to satisfy himself that none are missing or duplicated.
- 4.4. Quotations submitted must be complete in all respects. However, where it is identified that information in a bidder's response, which does not affect the preference points or price, is incomplete in any respect, the said supplier meets all specification requirements and scores the highest points in terms of preference points and price, the Department reserves the right to request the bidder to complete/ submit such information.
- 4.5. Any alteration made by the bidder must be initialled; failure to do so may render the response invalid.
- 4.6. Use of correcting fluid is prohibited and may render the response invalid.
- 4.7. Quotations will be opened in public as soon as practicable after the closing time of quotation.
- 4.8. Where practical, prices are made public at the time of opening quotations.
- 4.9. If it is desired to make more than one offer against any individual item, such offers should be given on a photocopy of the page in question. Clear indication thereof must be stated on the schedules attached.
- 4.10. The Department is under no obligation to pay suppliers in part for work done if the supplier can no longer for fulfill their obligation.

5. SPECIAL INSTRUCTIONS REGARDING HAND DELIVERED QUOTATIONS

- 5.1. Quotation shall be lodged at the address indicated not later than the closing time specified for their receipt, and in accordance with the directives in the quotation documents.
- 5.2. Each quotation shall be addressed in accordance with the directives in the quotation documents and shall be lodged in a separate sealed envelope, with the name and address of the bidder, the quotation number and closing date indicated on the envelope. The envelope shall not contain documents relating to any quotation other than that shown on the envelope. If this provision is not complied with, such quotations/bids may be rejected as being invalid.
- 5.3. All quotations received in sealed envelopes with the relevant quotation numbers on the envelopes are kept unopened in safe custody until the closing time of the quotation/bids. Where, however, a quotation is received open, it shall be sealed. If it is received without a quotation/bid number on the envelope, it shall be opened, the quotation number ascertained, the envelope sealed and the quotation number written on the envelope.
- 5.4. A specific box is provided for the receipt of quotations, and no quotation found in any other box or elsewhere subsequent to the closing date and time of quotation will be considered.

5.6. Quotation documents must not be included in packages containing samples. Such quotations may be rejected as being invalid.

6. SAMPLES

6.1. In the case of the quote document stipulating that samples are required, the supplier will be informed in due course when samples should be provided to the institution. (This decreases the time of safety and storage risk that may be incurred by the respective institution). The bidders sample will be retained if such bidder wins the contract.

- (i). If a company/s who has not won the quote requires their samples, they must advise the institution in writing of such.
- (ii). If samples are not collected within three months of close of quote the institution reserves the right to dispose of them at their discretion.

6.2. **Samples must be made available when requested in writing or if stipulated on the document.**

- If a Bidder fails to provide a sample of their product on offer for scrutiny against the set specification when requested, their offer will be rejected. All (i) testing will be for the account of the bidder.

7. COMPULSORY SITE INSPECTION / BRIEFING SESSION

7.1. Bidders who fail to attend the compulsory meeting will be disqualified from the evaluation process.

- (i) The institution has determined that a compulsory site meeting will take place.

(ii) Date: 06 / 09 / 2023 Time: 11 : 00AM Place: LECTUREHALL

Institution Stamp:	Institution Site Inspection / briefing session Official: Full Name: _____ Signature: _____ Date: _____
--------------------	---

8. STATEMENT OF SUPPLIES AND SERVICES

8.1. The contractor shall, when requested to do so, furnish particulars of supplies delivered or services executed. If he/she fails to do so, the Department may, without prejudice to any other rights which it may have, institute inquiries at the expense of the contractor to obtain the required particulars.

9. SUBMISSION AND COMPLETION OF SBD 6.1

9.1. Should a bidder wish to qualify for preference points they must complete a SBD 6.1 document. Failure by a bidder to provide all relevant information required, will result in such a bidder not being considered for preference point's allocation. The preferences applicable on the closing date will be utilized. Any changes after the closing date will not be considered for that particular quote.

10. TAX COMPLIANCE REQUIREMENTS

10.1. In the event that the tax compliance status has failed on CSD, it is the suppliers' responsibility to provide a SARS pin in order for the institution to validate the tax compliance status of the supplier.

10.2. In the event that the institution cannot validate the suppliers' tax clearance on SARS as well as the Central Suppliers Database, the quote will not be considered and passed over as non-compliant according to National Treasury Instruction Note 4 (a) 2016/17.

11. TAX INVOICE

11.1. A tax invoice shall be in the currency of the Republic of South Africa and shall contain the following particulars:

- (i) the name, address and registration number of the supplier;
- (ii) the name and address of the recipient;
- (iii) an individual serialized number and the date upon which the tax invoice
- (iv) a description and quantity or volume of the goods or services supplied;
- (v) the official department order number issued to the supplier;
- (vi) the value of the supply, the amount of tax charged;
- (vii) the words tax invoice in a prominent place.

12. PATENT RIGHTS

12.1. The supplier shall indemnify the KZN Department of Health (hereafter known as the purchaser) against all third-party claims of infringement of patent, trademark, or industrial design rights arising from use of the goods or any part thereof by the purchaser.

13. PENALTIES

13.1. If at any time during the contract period, the service provider is unable to perform in a timely manner, the service provider must notify the institution in writing/email of the cause of and the duration of the delay. Upon receipt of the notification, the institution should evaluate the circumstances and, if deemed necessary, the institution may extend the service provider's time for performance.

13.2. In the event of delayed performance that extends beyond the delivery period, the institution is entitled to purchase commodities of a similar quantity and quality as a substitution for the outstanding commodities, without terminating the contract, as well as return commodities delivered at a later stage at the service provider's expense.

13.3. Alternatively, the institution may elect to terminate the contract and procure the necessary commodities in order to complete the contract. In the event that the contract is terminated the institution may claim damages from the service provider in the form of a penalty. The service provider's performance should be captured on the service provider database in order to determine whether or not the service provider should be awarded any contracts in the future.

13.4. If the supplier fails to deliver any or all of the goods or to perform the services within the period(s) specified in the contract, the purchaser shall, without prejudice to its other remedies under the contract, deduct from the contract price, as a penalty, a sum calculated on the delivered price of the delayed goods or unperformed services using the current prime interest rate calculated for each day of the delay until actual delivery or performance.



14. TERMINATION FOR DEFAULT

14.1. The purchaser, without prejudice to any other remedy for breach of contract, by written notice of default sent to the supplier, may terminate this contract in whole or in part:

- (i) if the supplier fails to deliver any or all of the goods within the period(s) specified in the contract,
- (ii) if the supplier fails to perform any other obligation(s) under the contract; or
- (iii) if the supplier, in the judgment of the purchaser, has engaged in corrupt or fraudulent practices in competing for or in executing the contract.

14.2. In the event the purchaser terminates the contract in whole or in part, the purchaser may procure, upon such terms and in such manner as it deems appropriate, goods, works or services similar to those undelivered, and the supplier shall be liable to the purchaser for any excess costs for such similar goods, works or services.

14.3. Where the purchaser terminates the contract in whole or in part, the purchaser may decide to impose a restriction penalty on the supplier by prohibiting such supplier from doing business with the public sector for a period not exceeding 10 years.

15. THE DEPARTMENT RESERVES THE RIGHT TO PASS OVER ANY QUOTATION WHICH FAILS TO COMPLY WITH THE ABOVE.

PREFERENCE POINTS CLAIM FORM IN TERMS OF THE PREFERENTIAL PROCUREMENT REGULATIONS 2022

This preference form must form part of all tenders invited. It contains general information and serves as a claim form for preference points for specific goals.

NB: BEFORE COMPLETING THIS FORM, TENDERERS MUST STUDY THE GENERAL CONDITIONS, DEFINITIONS AND DIRECTIVES APPLICABLE IN RESPECT OF THE TENDER AND PREFERENTIAL PROCUREMENT REGULATIONS, 2022

1. GENERAL CONDITIONS

- 1.1. The following preference point systems are applicable to invitations to tender:
- the 80/20 system for requirements with a Rand value of up to R50 000 000 (all applicable taxes included); and
 - the 90/10 system for requirements with a Rand value above R50 000 000 (all applicable taxes included).

1.2. The applicable preference point system for this tender is the 80/20 preference point system.

- 1.3. Points for this tender (even in the case of a tender for income-generating contracts) shall be awarded for:
- (a) Price; and
 - (b) Specific Goals.

1.4. The maximum points for this tender are allocated as follows:

	POINTS
PRICE	80
SPECIFIC GOALS	20
Total points for Price and Specific Goals	100

1.5. Failure on the part of a tenderer to submit proof or documentation required in terms of this tender to claim points for specific goals with the tender, will be interpreted to mean that preference points for specific goals are not claimed.

1.6. The organ of state reserves the right to require of a tenderer, either before a tender is adjudicated or at any time subsequently, to substantiate any claim in regard to preferences, in any manner required by the organ of state.

DEFINITIONS

- (a) "tender" means a written offer in the form determined by an organ of state in response to an invitation to provide goods or services through price quotations, competitive tendering process or any other method envisaged in legislation;
- (b) "price" means an amount of money tendered for goods or services, and includes all applicable taxes less all unconditional discounts;
- (c) "rand value" means the total estimated value of a contract in Rand, calculated at the time of bid invitation, and includes all applicable taxes;
- (d) "tender for income-generating contracts" means a written offer in the form determined by an organ of state in response to an invitation for the origination of income-generating contracts through any method envisaged in legislation that will result in a legal agreement between the organ of state and a third party that produces revenue for the organ of state, and includes, but is not limited to, leasing and disposal of assets and concession contracts, excluding direct sales and disposal of assets through public auctions; and
- (e) "the Act" means the Preferential Procurement Policy Framework Act, 2000 (Act No. 5 of 2000).

3. FORMULAE FOR PROCUREMENT OF GOODS AND SERVICES

3.1. POINTS AWARDED FOR PRICE

3.1.1. THE 80/20 OR 90/10 PREFERENCE POINT SYSTEMS

A maximum of 80 or 90 points is allocated for price on the following basis:

$$\begin{array}{ccc}
 \text{80/20} & & \text{90/10} \\
 P_s = 80 \left(1 - \frac{P_t - P_{min}}{P_{min}} \right) & \text{OR} & P_s = 90 \left(1 - \frac{P_t - P_{min}}{P_{min}} \right)
 \end{array}$$

Where

- P_s = Points scored for price of tender under consideration
- P_t = Price of tender under consideration
- P_{min} = Price of lowest acceptable tender

3.2. FORMULAE FOR DISPOSAL OR LEASING OF STATE ASSETS AND INCOME GENERATING PROCUREMENT

3.2.1. POINTS AWARDED FOR PRICE

A maximum of 80 or 90 points is allocated for price on the following basis:

$$\begin{array}{ccc}
 \text{80/20} & & \text{90/10} \\
 P_s = 80 \left(1 + \frac{P_t - P_{max}}{P_{max}} \right) & \text{OR} & P_s = 90 \left(1 + \frac{P_t - P_{max}}{P_{max}} \right)
 \end{array}$$

Where

- P_s = Points scored for price of tender under consideration
- P_t = Price of tender under consideration
- P_{max} = Price of highest acceptable tender



4. POINTS AWARDED FOR SPECIFIC GOALS

- 4.1. In terms of Regulation 4(2); 5(2); 6(2) and 7(2) of the Preferential Procurement Regulations, preference points must be awarded for specific goals stated in the tender. For the purposes of this tender the tenderer will be allocated points based on the goals stated in table 1 below as may be supported by proof/ documentation stated in the conditions of this tender:
- 4.2. In cases where organs of state intend to use Regulation 3(2) of the Regulations, which states that, if it is unclear whether the 80/20 or 90/10 preference point system applies, an organ of state must, in the tender documents, stipulate in the case of—
- (a) an invitation for tender for income-generating contracts, that either the 80/20 or 90/10 preference point system will apply and that the highest acceptable tender will be used to determine the applicable preference point system; or
 - (b) any other invitation for tender, that either the 80/20 or 90/10 preference point system will apply and that the lowest acceptable tender will be used to determine the applicable preference point system,
- then the organ of state must indicate the points allocated for specific goals for both the 90/10 and 80/20 preference point system.

Table 1: Specific goals for the tender and points claimed are indicated per the table below.

Note to tenderers: The tenderer must indicate how they claim points for each preference point system.

The specific goal/s allocated points in terms of this tender	Number of points allocated (80/20 system)	Number of points claimed (80/20 system)
Promotion of Enterprises manufacturing in the Province of KwaZulu-Natal	20	

DECLARATION WITH REGARD TO COMPANY/FIRM

- 4.3. Name of company/firm: _____
- 4.4. Company registration number: _____
- 4.5. TYPE OF COMPANY/ FIRM [tick applicable box]
- Partnership/Joint Venture / Consortium
 - One-person business/sole propriety
 - Close corporation
 - Public Company
 - Personal Liability Company
 - (Pty) Limited
 - Non-Profit Company
 - State Owned Company

4.6. I, the undersigned, who is duly authorised to do so on behalf of the company/firm, certify that the points claimed, based on the specific goals as advised in the tender, qualifies the company/ firm for the preference(s) shown and I acknowledge that:

- i) The information furnished is true and correct;
- ii) The preference points claimed are in accordance with the General Conditions as indicated in paragraph 1 of this form;
- iii) In the event of a contract being awarded, as a result of points claimed as shown in paragraphs 1.4 and 4.2, the contractor may be required to furnish documentary proof to the satisfaction of the organ of state that the claims are correct;
- iv) If the specific goals have been claimed or obtained on a fraudulent basis or any of the conditions of contract have not been fulfilled, the organ of state may, in addition to any other remedy it may have –
 - (a) disqualify the person from the tendering process;
 - (b) recover costs, losses or damages it has incurred or suffered as a result of that person's conduct;
 - (c) cancel the contract and claim any damages which it has suffered as a result of having to make less favourable arrangements due to such cancellation;
 - (d) recommend that the tenderer or contractor, its shareholders and directors, or only the shareholders and directors who acted on a fraudulent basis, be restricted from obtaining business from any organ of state for a period not exceeding 10 years, after the audi alteram partem (hear the other side) rule has been applied; and
 - (e) forward the matter for criminal prosecution, if deemed necessary.

_____ SIGNATURE(S) OF TENDERER(S)	
SURNAME AND NAME:	_____
DATE:	_____
ADDRESS:	_____



St. Agilline's Hospital
Off Conroy main road Conroy (GRIFFITHS) 4283
Private Bag 506 Bono, 4276
Tel: 039 836 8016 Fax: 039 836 8014
Email: info@mhncp.zahealth.gov.za
www.zahealth.gov.za

SUPPLY CHAIN MANAGEMENT

Date: 16 August 2023

ZNQ Number: SA99/2023/2024

TERMS OF REFERENCE

Item Specification: Service provider to repair pharmacy area and opening of new windows and entrance.

NB: B-BBEE sworn affidavits or B-BBEE certificate must be included as part of mandatory requirement.

BEC might conduct site visits with shortlisted bidders prior to the adjudication so be prepared

Supplier must be CIDB 1GB or above

Name & Surname	Designation	Signature
CS Mbanjwa	SMO	
TA Mkhize	CPC-QAM	
MI Ntshangase	SCC	
SF Sokhele	OMN	

SPECIFICATION TERMS AND CONDITIONS

- Only bidders that fully meet the specification shall be considered
- The institution is under no obligation to accept the lowest or any quote
- The quality of products must be SABS / SANS/ CKS approved and a certificate of compliance must be submitted when required
- The bidder must ensure the correctness and validity quote: the prices, rates & preference quoted cover all of the work and accept that any mistake regarding with the price calculations will be at the bidder's risk
- If the information supplied is found to be incorrect or false then the KZN department of Health, in addition to the remedies it may have, may recover from the contractor all cost, losses and damages incurred by the department as a result of the award of the contract, and / or cancel the contract and claim any damages
- Defaulting suppliers in terms of delivering, will be dealt with and will be reported at Treasury
- The evaluation criteria for the quotation above R30 000 will be 80/20 for the price and points certified BBBEE certificates and original tax clearance
- Incomplete declaration of interest and quotation form will not be considered
- Orders will be cancelled if the supplier fail to meet the set standards and lead time
- All quotations requiring registration with certain Bodies must be returned together with the following:
 - Valid tax clearance
 - Proof of registration with CSD
 - CK certificate / Cipro certificate
 - CIDB registration and grading with relevant job category
 - Reference letter (from where the supplier did the same job successfully)
 - Letter of good standing
 - Current proof of registration with relevant bodies
 - Sworn statement
- All conditions indicated in the quotation form will be applicable upon evaluation, and should be attached to evaluation criteria
- Quotation form must be completed and signed in full, any omissions or incomplete information and signatures will automatically disqualify the quotation
- Bill of quantity should be fully completed and all segments must be filled per item
- A guarantee / warrantee must be provided on appliances, services and repairs
- All these conditions are binding and service providers must comply with
- Samples must be provided with documents unless indicated otherwise
- For services requiring site inspection, no late bidders will be allowed to join briefing
- It is advisable to get all necessary information before quotation closing date

Chairperson
16/08/2023
Date

Tender user
17/08/2023
Date

CEO
21.08.2023
Date

Quote Number: _____

Item Description: Repair Pharmacy waiting area & some Alterations

Department/Section: MAINTENANCE

Purpose of Item: Repairs to Cover Patient's Arch

1. Pre-qualification criteria if any:

1.1. Is the item required to have a regulatory body certification (e.g. SABS, SANS, SANAS, ISO, CIDB, etc.)? Yes / No:
Regulatory Body / certification required if Yes: CIDB IGB & ABOVE

1.2. Is a compulsory site inspection / briefing session required? Yes / No
if Yes, specify: Date ____ / ____ / ____ Time ____ : ____ Place _____

1.3. Is local production and content part of the quote? Yes / No
if Yes, specify: SHUTTER PROOF GLASS & ALUMINIUM

1.4. Provisions of section 4(1)(a) of the PPPFA Regulations, 2017 if applicable? Yes / No
if Yes, specify: _____

1.5. Liability Cover insurance? Yes / No
if Yes, specify: MINIMUM of 3 MILLION RANDB

2. What is the specification of the required item?

List specifications to be advertised	Comment
1. <u>List Items that required are listed</u>	
2. <u>on the specification attached.</u>	
3.	
4.	
5.	

3. Does a sample need to be submitted? Yes / No (select option 3.1 or 3.2)

3.1. Deadline for submission if Yes: Date ____ / ____ / ____ Time ____ : ____ Place DURING SITE HAND OVER

or

3.2. Specify that samples must be made available when requested in writing. Yes or No

4. Penalties to be noted by the suppliers:

4.1. If the supplier fails to deliver any or all of the goods or to perform the services within the period(s) specified in the contract, the purchaser shall, without prejudice to its other remedies under the contract, **deduct from the contract price**, as a penalty, a sum calculated on the delivered price of the delayed goods or unperformed services using the current prime interest rate calculated for each day of the delay until actual delivery or performance.

5. What is the evaluation criteria / special terms and conditions to be advertised?

List evaluation criteria / special terms and conditions to be advertised (if applicable)	
1. Pre-qualification criteria	Does the offer meet the pre-qualification criteria?
2. Administrative	Does the offer comply to stipulated administrative requirements?
3. Conformance:	Was the product made or service performed to specifications?
4. Performance:	Will/does the product/service fulfil its performance obligation, in a manner that releases the supplier from all liabilities under the contract?
5. Features:	What characteristics does the product or service have?
6. Reliability:	How long can a product go between failures and the need for maintenance? (guarantee)
7. Durability:	What is the useful life for the product? How will the product hold up under extended use?
8. Serviceability:	How easy is it to repair, maintain or support the product or service? (customer support)
9. Ability & Capacity	The ability and capacity of the vendor to execute the contract
10. Preference points	Preferential Procurement System (80/20) if applicable

Name of End-user (in full)	<u>IS GWAMANDA</u>	Name of SCM Rep (in full)	
Designation / Rank (in full)	<u>Chief Artisan</u>	Designation/ Rank (in full)	
Signature	<u>[Signature]</u>	Signature	
Date		Date	

**PROVINCE OF KWAZULU-NATAL
DEPARTMENT OF HEALTH**

ZNQ –

**ST APOLLINARIS HOSPITAL – CONSTRUCTION OF A WAITING AREA SHELTER FOR
PATIENTS AT ST APOLLINARIS HOSPITAL.**

1.1 SCOPE OF CONTRACT

This Contract is for the execution of the project indicated above.

1.2 CONTRACT DRAWINGS

Drawing attached (Drawing 1, 2, 3, 4, 5, 6, 7 & 8)

1.3 CONDITIONS OF CONTRACT AND PRELIMINARIES

1.3.1 PERIOD OF CONTRACT

Four (04) *Weeks* as the Contract Period for the completion of the Work from date of Site handover.

1.3.2 CONTRACT GUARANTEE:

The Successful Bidder will **NOT** be required to submit a contract guarantee.

1.3.3 GUARANTEE PERIOD

The guarantee period for the completion of the Structural work and all materials must be a minimum of Three (3) Calendar Months from the date of first delivery.

1.3.4 SITE AND MODE OF PROCEDURE

The work contained in this contract will be carried out on the site of the existing at **St Apollinaris Hospital**.

The Bidder is advised that the existing premises will be occupied throughout the period of the contract, and that the minimum amount of disruption to services is of the utmost importance.

Damage to the existing buildings - Bidders to note that any damages done or occurring to any of the buildings will be repaired at the expense of the contractor/ Bidder.

The repairs must be to the satisfaction of the Kwazulu- Natal Department of Health. Bidders are advised to visit the site prior to tendering and to acquaint themselves with the nature of the work to be done and access to the siting of the existing buildings etc., as no claim whatsoever will be allowed on the grounds of ignorance of the conditions under which the work will be executed.

NB: Bidders are advised to examine the drawings and visit the site prior to quoting and to acquaint themselves with the nature of the work to be done and access to the siting of the existing buildings etc., as no claim will be

allowed on the grounds of ignorance of the conditions under which the work will be executed.

1.3.5 SATISFACTORY INSTALLATION

The whole of the installation shall be carried out in accordance with the South African Bureau of Standards Code of Practice for the application of National Building Regulations, the KZNPA Standard Preambles to all Trades, the KZNPA General Electrical Specification, ICASA, Telecommunications regulations, the South African Bureau of Standards Code of Practice for the Wiring of Premises SABS 0142 and the Occupational Health and Safety Act and Regulations 85/1993 as amended. Copies of the KZNPA Standard Preambles to all Trades and the KZNPA General Electrical Specification are available at the office of the Secretary for Health – KwaZulu-Natal and can be obtained on request.

PROVINCE OF KWAZULU-NATAL
DEPARTMENT OF HEALTH

ZNQ –

ST APOLLINARIS HOSPITAL - CONSTRUCTION OF A WAITING AREA SHELTER FOR
PATIENTS AT ST APOLLINARIS HOSPITAL.

TECHNICAL SPECIFICATIONS

2. TECHNICAL SPECIFICATION

2.1 GENERAL

This TECHNICAL SPECIFICATION shall be read in conjunction with all other sections of the SPECIFICATION and cognisance shall be taken of the clauses relevant to this particular installation, whether any specific clauses are referred to or not.

2.2 *Standard Preambles*

This is available from the department on request.

2.3 *Health and Safety Specification*

Health and Safety Plan with Risk assessment schedule is to be compiled taking cognisance of the specific type of patient's that walk around the institution all day. All areas are to be protected at all times from patients falling in. All new and old materials are to be securely stored during construction to eliminate any person from rolling them around or playing inside them.

Grading: 1 GB and above

CIDB COMPLIANCE

2.4 Amendments: Functionality in different contracting strategies in line with regulations 4.3.3 of the CIDB regulations, where functionality is evaluated, at least three Persons who are fully conversant with the Technical aspects of the scope of works shall undertake such evaluation

**PROVINCE OF KWAZULU-NATAL
DEPARTMENT OF HEALTH**

ZNQ –

**ST APOLLINARIS HOSPITAL – CONSTRUCTION OF A WAITING AREA SHELTER FOR
PATIENTS AT ST APOLLINARIS HOSPITAL.**

3. SCOPE OF WORK

The work to be carried out under this contract includes the supply of all materials, and including all labour to carry out all electrical work and leaving in service condition to the satisfaction of the Secretary for Health: KwaZulu-Natal.

3.1. The work comprises of

3.2 Supply and install the following

- a) Waiting area shelter.
- b) Partition wall.
- c) New office.

Note: All work to be re measured on Completion.

ALTERATIONS

All Notes, Preambles, etc. applicable for the various trades in the Bills of Quantities, will apply equally to the trades in this Bill. Tenderers are advised to visit the site and satisfy themselves as to the nature and extent of the work to be done, and also to examine the condition of the existing building.

Tenderers are advised that all materials from the pulling down (except where described to be re-used or handed over to the Department) will become the property of the Contractor, and all these materials, together with all rubbish and debris, must be immediately carted away, and the site left clean and unencumbered. Materials, etc. which are described to be handed over to the Department are to be carefully dismantled where necessary, and neatly stacked where directed on site. Items described as removed shall be removed from site. Credit for the value of the materials from the pulling down may be allowed for on the Final Summary page.

Prior to the removal of any timbers from the site, they are to be inspected by the Government Entomologist as laid down in Section 32 of the Government Forest and Veld Conservation Act of 1941 (Act 13 of 1941) as amended. If any of the timbers are infested with wood destroying agencies, they are to be disposed of in the manner prescribed by the Government Entomologist.

The Contractor is to give ample notice to the Department and Local Authorities regarding any disconnections necessary prior to the removal or interruption of electric light or telephone cables, water and sanitary services, etc.

Tenderers are advised that adjacent sections of this building will be occupied during the building operations, and the Contractor is required to carry out the work with as little noise,

dust and disturbance as possible. Undisturbed access is to be given to patients, staff and visitors.

The Contractor is advised to check all dimensions affecting the existing building as he will be held solely responsible for all new work being of the correct size. All sizes stated are approximate and under no circumstances will claims be entertained should actual sizes of existing items on site vary marginally from the sizes stated in this document.

The Contractor will be held solely responsible for any damage to persons, property, and equipment and for the safety of the structure throughout the whole of the Contract, and must make good at his own expense any damage that may occur.

The Contractor must obey the instructions of the Department in carrying out any portion of the work which in his opinion requires expediting, and the Contractor shall give priority to such work as and when directed.

In taking down and removing existing work, the utmost care is to be observed to avoid any structural or other damage to the remaining portions of the building. The Contractor must also protect all work not removed, such as walls, floors, doors, windows or joinery, loose and fixed fittings and electrical equipment, appliances, etc. from damage during the progress on the works and provide all necessary materials in so doing.

STANDARD PREAMBLES TO ALL TRADES 92

EARTHWORKS SITE CLEARANCE

The item given in the Bills of Quantities for site clearance shall be deemed to include the removal from the site, or burning if permitted by the Local Authority, of shrubs and trees with trunks under 200mm girth measured at 1m above ground level, STANDARD PREAMBLES TO ALL TRADES 3 Rev 3 January 2009 hedges, bushes, other vegetation, rubbish and debris. Holes left by roots are to be backfilled with earth and rammed. EXCAVATIONS: — Rates for excavations are to include for forming and trimming to the correct levels, falls, slopes, curves, etc. for trimming sides, stepping, levelling and ramming bottoms, staging and disposing of the excavated material as described in the items. Rates for excavations to reduce levels over site are also to include for forming and trimming banks to the required batter. The Contractor is to allow in his rates for the bulking of excavated material. The term "excavate", unless otherwise stated, shall mean excavate in "soft excavation" as defined below and for the purpose of classifying excavations the following will apply: — a) Soft excavation: — shall be excavation in material that can be efficiently removed by a back-acting excavator of flywheel power approximately 0, 10 kW per millimetre of tined-bucket width without the assistance of pneumatic tools such as paving breakers, or that can be efficiently loaded without prior ripping or stockpiling by a rubber tired front-end loader of approximately 15t mass and a flywheel power of approximately 100 kW. b) Intermediate excavation: — shall be excavation in material that requires a backacting excavator of flywheel power exceeding 0,10kW per millimetre of tined-bucket width and the assistance of pneumatic tools prior to removal by equipment equivalent to that specified in (a) above. c) Hard rock excavation: — shall be excavation in material that cannot be efficiently removed without blasting or without wedging and splitting prior to removal. d) Class A Boulder excavation: — shall be excavation in material containing more than 40% by volume of boulders of size between 0.03m³ and 20m³ in a matrix of softer material or smaller boulders. Note: — Excavation of solid boulders or lumps of size exceeding 20m³ will be classed as hard rock excavation. (2) Excavation of fissured or fractured rock will not be classed as boulder excavation but as hard rock or intermediate excavation according to the nature of the material. e) Class B Boulder excavation: — shall be excavation of boulders only in a material containing 40% or less by volume of boulders of size between 0.03m³ and 20m³ in a matrix of

softer material or smaller boulders. Note: — Those boulders requiring individual drilling and blasting in order to be loaded by a back-acting excavator as specified in (a) above, or by a track type frontend loader, will each be separately measured as Class B boulder excavation. The excavation of the rest of the material will be classed as soft or intermediate excavation according to the nature of the material. Method of Classifying: —The Contractor may use any method he chooses to excavate any class of material but his chosen method of excavation shall not determine the classification of the excavation. The Department will decide on the classification of the materials. The classification will be based on inspection of the material to be excavated and the criteria given in (a) to (e) above, as applicable. The decision of the Department shall be, subject to the relevant provisions of the contract, final and binding. Should the Contractor consider that the excavation is other than "soft excavation" he must notify the Department immediately in order that an inspection be made and a decision arrived at by the Department as to the category of such excavation. Should the Contractor fail to give such notification, the excavation shall be deemed to be "soft excavation" and shall be measured and valued accordingly. Blasting will only be permitted with the written authority of the Department, if and when permission is granted, it is to be executed only by persons holding the necessary Government Blasting Certificate and subject to all regulations imposed by the Department and/or Local Authority. In addition, the Contractor is to indemnify the Provincial Administration against all claims in respect of damage to persons and property resulting from such blasting operations. STANDARD PREAMBLES TO ALL TRADES 4 Rev 3 January 2009 Before commencing any excavations, the Contractor must satisfy himself as to the accuracy of any levels indicated on the drawings, as no claim will be entertained at a later date for any alleged inaccuracy in such levels. Excavation shall be carried down to such depths as are necessary to obtain firm foundations, but before proceeding to greater depths than are shown on the drawings, the Department's approval must be obtained. The Contractor will be responsible if he excavates wider or deeper than shown or required. If the excavations are deeper than shown or required such extra excavations are to be filled in with mass concrete at the Contractor's expense. If the excavations are wider than shown or required, any form-work or mass concrete filling required to the side of the concrete foundations is to be executed at the Contractor's expense and to the approval of the Department. Depths of excavations as approved shall be checked and recorded by the a Departmental Official and the Contractor's Foreman before any concrete is laid or the excavations are otherwise covered or filled in. Notwithstanding such approval, any excavations which become waterlogged or otherwise spoilt after approval, shall be cleaned out and reformed, at the Contractor's expense and to the satisfaction of the Department, before any concrete, etc. is laid. WATER: — The Contractor shall keep all excavations free from water or mud by pumping, baling or otherwise. WORKING SPACE: — The Contractor is to allow against the items of "excavate to provide working space" for excavating beyond the extent of the net excavations measured to provide the necessary working space for the carrying out of such work as is described in the items. Rates are to include, in addition to the extra excavation, for any additional risk of collapse so incurred and for filling back and compacting the excavated material. No separate item for working space is provided or will be considered where the face of the measured excavation is 750mm or more away from the finished face of the structure. Separate items for working space for the building of brick foundation walls on ordinary concrete wall footings will not be considered. In the case of column base and pile cap excavations, where the dimensions between the column face and the excavation face is less than 500mm, working space has been measured for the width of the column face from the commencing level of excavation to the top of the column base or pile cap only where the top of the column base or pile cap exceeds 1.5m below the commencing level of excavation. RISK OF COLLAPSE: — The Contractor shall maintain all excavated faces affecting the safety of the works and workmen. He must either provide all necessary temporary planking, strutting or shoring to all vertical excavated faces or carry the risk of collapse of these faces with all its implications. He must assume full responsibility in this connection and must allow in his rates accordingly. In addition, all excavated faces

exceeding 1.5m deep are to be maintained in accordance with Government Regulations. Quantities reflect the total superficial areas of the vertical excavated faces and will be subject to variation only in so far as these areas may vary, notwithstanding whether any temporary supports are used or not. FILLING, ETC.: — All backfilling and filling under floors and paving must be of selected material from the excavations, unless otherwise stated, returned and compacted in layers as later described and with the top surface dressed to the correct levels and grades, all to the approval of the Department. Under no circumstances will the Contractor be allowed to use clay, peat or other unsuitable material for filling. STANDARD PREAMBLES TO ALL TRADES 5 Rev 3 January 2009 Rates for all items of filling with material from the excavations are to include haulage not exceeding 100m from the perimeter of the excavations. Any filling supplied by the Contractor is to be of suitable material approved by the Department. COMPACTION OF FILLING ETC.: — All filling and backfilling is to be done in layers not exceeding 200mm thick before compaction, with the layers level to ensure uniform compaction. Each layer is to be thoroughly compacted over the whole of the area to a dry density not less than 90% of Mod. A.A.S.H.O. density. The surface of each compacted layer shall be uniform and tightly bonded. Care is to be taken that no damage is done to foundation walls, drains and other services. The densities of compaction referred to are to be determined by tests carried out in accordance with A.S.T.M. Designation D 1557-58 and at an optimum moisture content of not more or less than 5% of the required Mod. A.A.S.H.O. The Contractor shall be responsible for having sufficient tests taken of the density of the compacted filling to ensure that the required compaction is being attained to the satisfaction of the Department. These tests are to be undertaken by an independent testing authority nominated by the Contractor to the approval of the Department. The costs of all tests in this connection shall be borne by the Contractor and shall be allowed for in his rates. PROTECTION AGAINST SUBTERRANEAN WOOD-DESTROYING TERMITES: — Where protection against termites is to be provided: — a) Remove vegetable matter All dead roots and other vegetable matter likely to encourage termites must be removed from the ground under, against the building and from all filling material. b) Treating the ground The ground under surface beds, and below suspended wood floors, must be treated by the application of Soil Insecticides of Chlordane or Aldrin types complying with SANS Specifications 1165 and 1164 respectively, mixed with water and applied at the rate of not less than 5 litres of solution per square metre uniformly over the whole surface. The concentration of the solution must be strictly in accordance with the manufacturer's instructions and to the approval of the Department. The Department reserves the right to take samples of the diluted solution, at any time, in order to test the concentration of the chemicals used. Where the ground to be treated is of earth filling, the upper 50mm layer of filling must be levelled by raking, but must not be rammed until after the solution has been applied, and where of natural ground, it must be loosened to a depth of not less than 50mm and similarly levelled, in order to enable the solution to penetrate into the soil. After the solution has been applied and allowed to penetrate the surface, the soil must be well rammed and consolidated. Before applying the solution to the ground under the floors, splay back earth for a depth and width of 75mm from the internal faces of walls enclosing the floors, against internal walls, sleeper piers, etc. and thoroughly saturate with the solution. After the solution has soaked into the earth, the splayed grooves must be filled with earth and consolidated. The treated layer of soil under suspended wood floors must be protected with a 75mm thick layer of approved clean gravel, finished to an even surface. The treated layer of soil under concrete surface beds must be protected with a 25mm thick layer of well-consolidated approved grit prior to laying the waterproofing membrane. Great care must be taken when laying concrete surface beds, protective layers, etc. in order to avoid rupturing the treated layer of soil. Should the treated layer be ruptured at any STANDARD PREAMBLES TO ALL TRADES 6 Rev 3 January 2009 point it must be made good and the area affected re-treated with the soil insecticide. Contractors are advised that: a. Special precautions must be taken to protect the workmen whilst using the soil insecticide. b. The treatment of filling or ground under floors shall be done as soon as practicable, so that treatment may dry out before the floors are laid. c. The treatment of the

ground must be carried out under the supervision of the Department. d. The soil insecticide to be delivered to the site in sealed drums clearly labelled or stamped with the name of the product. e. In addition to the foregoing the application of the soil insecticide to be carried out in accordance with SANS Code of Practice 0124 — the application of Certain Soil Insecticides for the Protection of Buildings. f. The protective layers of gravel or grit have been measured separately. RE-USE OF EXCAVATED MATERIAL: — Material of any kind that may be discovered on the site during the excavation shall remain the property of the Administration. Such material may, if approved, be used for aggregate. Material so used shall be valued and the value deducted from the Contract Sum. DEMOLITIONS: — The Contractor is referred to the preambles for "Alterations" insofar as they apply and the following: — The demolition of existing buildings is to be done in a practical and safe manner, under the continuous supervision of a competent Foreman. Rates for the demolition of existing buildings are to include for breaking up and removing all external screen walls, steps and ramps, surface water channels, rainwater sumps, gulleys, etc. and grubbing up and removing all foundation walls and footings, disconnecting and removing all services to a point not less than 1m beyond the perimeter of the buildings, plugging off ends of all remaining pipes, and for filling in all holes with clean earth and ramming up to ground level. All movable fittings and furniture, fire extinguishers and electrical and other equipment in the buildings to be demolished are to remain the property of and will be removed by the Administration prior to the commencement of the demolition. Before commencing the demolitions, the Contractor shall comply with any Local Authority regulations in force in respect of rodent extermination, etc. and he shall obtain the required Clearance Certificate. Items to cover the cost of obtaining the certificate and the fumigation, etc. of the buildings to be demolished have been provided elsewhere in the Bills of Quantities, and the fumigation is to be carried out by a firm specialising in this type of work. The fumigation of the buildings to be demolished shall only be carried out if called for by the Local Authorities and if not required the value of the relevant items in the Bills of Quantities will be deducted from the Contract Sum. After handing over the site to the Contractor, the risk of any loss or damage to the buildings to be demolished and the materials therein, caused by theft, vandalism, etc. shall be the responsibility of the Contractor and he shall take such precautions as he deems necessary against such loss or damage. GRASS PLANTING AND TURFING: — Is to be "Cape Kweek" or "Umgeni" grass scientifically known as *Cynodon dactylon* or other local fine grass approved by the Department. In areas where fine grass does not grow readily, Kikuyu grass *Pennisetum clandestinum* may be substituted. The areas must be identified and the approval of the Department obtained before Kikuyu grass is to be planted. Grass Planting To Level Areas: — The areas to receive grass are to be weeded and raked free of stones and other superfluous matter and all depressions left by the earthworks plant are to be filled in with approved topsoil. The planting of grass is to be carried out in continuous root planting in rows 200mm apart. The method of planting called "sprigging" may be used as an alternative. STANDARD PREAMBLES TO ALL TRADES 7 Rev 3 January 2009 Immediately after completion of each strip or square, the area thus grassed is to be thoroughly watered and lightly rolled. Any drifting or piling up of the top soil due to wind or any other cause must be prevented as far as possible and should such piling up of soil against newly planted grass occur the soil must immediately be raked level and lightly rolled. Turfing: — Banks are to be carefully trimmed to an even surface and weeded and raked free of stones, etc. and all depressions filled in with approved topsoil as before described. Turfing of banks is to be carried out with 25mm thick maximum 500mm x 1000mm weedfree grass sods, of grass as before described, and as approved by the Department. The grass sods are to be set in position in horizontal rows to broken bond and closely fitted together and tamped flat with a timber pummel, a maximum of two sods in every square metre of area covered being staked to the bank to maintain position, with and including one sharpened wood or bamboo skewer 250mm long and with all cavities between sods filled in with approved top soil and the whole area lightly top soil dressed on completion. Established Lawn: — The use of established lawn in pieces size approximately 500mm x 1000mm x 25mm thick in lieu of grass sods on banks will be

permitted provided that the established lawn is supplied and laid by a firm experienced in this type of work and to the approval of the Department. The fitting, tamping, staking and top dressing must all be as described for turfing, except that one piece per square metre is required to be staked as described. Fertilizer: — An approved fertilizer of the following types— Type 2:3:2 for grass planted levelled areas and Type 3:2:1 for turfed or established lawn covered banks is to be supplied and applied by the Contractor at the rate of 400 kg per hectare. In the case of grass planted levelled areas the fertilizer is to be applied either before or after grass planting and in the case of turfed or established lawn covered banks the fertilizer is to be applied after the sods or pieces have been laid. The fertilizer above described is to in addition to any fertilizer which may have been specified to be applied during either the operation of scarifying and grading the area to be grassed or the re-spreading of top soil. A sample of the existing topsoil or the topsoil to be re-spread is to be sent to an approved fertilizer manufacturer for testing and advice on the acid or alkaline content of the soil. The cost of this test is to be borne by the Contractor if this is not provided free by the fertilizer manufacturer. The requisite quantities of limestone ammonium nitrate for acidic soil or ammonium sulphate for alkaline soil as determined by the soil test will be supplied to the Contractor by the Department and the cost thereof is to be included in a Provisional Sum elsewhere in the Bills of Quantities. The application of this treatment is to be undertaken by the Contractor and his rates for grassing, etc. must include for same. Weed killer: — "Weed Master or Turf Master" or other approved weed killer is to be applied to the entire grassed or turfed areas at a rate of 4 litres mixed with 200 litres of water per hectare, this being equivalent to 40-45 millilitres mixed with 5 litres of water per fifty square metres. The solution is to be sprayed on with a suitable spraying apparatus to achieve an even distribution. Six to eight weeks later, the operation is to be repeated. The application of weed killer is not to take place during wet weather. Weather conditions should be such as to allow a minimum of two hours or absorption before the likelihood of rain. Watering and Rolling: — The entire turfed area is to be kept clear of weeds, lightly rolled and thoroughly watered throughout the period of the Contract and or at least three months from the time of acceptance of the grounds or until the grassing or turfing is well established if that is sooner, all to the satisfaction of the Department. In the absence of rain, the initial watering of grassed or turfed areas is to be carried out as follows: — STANDARD PREAMBLES TO ALL TRADES 8

ROOF COVERINGS CONCRETE ROOFING TILES:

Shall conform to SANS Specification 542. The tiles are to be of pattern and colour specified and is to be even in thickness, uniform in shape and colour and free from cracks and blemishes. The tiles are to be laid to "straight bond" in accordance with SANS Code of Practice 062 with vertical joints and bottom edges of each course ranging perfectly straight. Unless otherwise specified each tile in every third course, all tiles in eaves and ridge courses and tiles in every course on each side of hips and valleys shall be secured with copper clout headed nails driven into the battens or with approved non-corrodible tile clips and nails in accordance with the manufacturer's instructions. Where nail holes in tiles have been cut off at hips, valleys, top edges, etc. new holes are to be drilled. All ridge and hip cappings are to be of the types specified and of colour to match the roofing tiles. The cappings are to be bedded, jointed, pointed and torched up over roofing tiles in 1:3 cement mortar tinted to match the tiles. Where cappings having butt jointed ends are specified, an approved damp proof course conforming to Type C of SANS Specification 952 is to be fixed under, laid over the roofing tiles in accordance with the manufacturer's instructions. Barge cappings are to be of the types specified and of colour to match the roofing tiles. The barge capping tiles are, unless otherwise specified, to be bedded, jointed, pointed and touched up over roofing tiles in 1:3 cement mortar tinted to match the tiles with every tile drilled and secured with copper clout headed nails to timber barge boards or bearers (elsewhere measured). Concrete tiles to residential units in non hail area's are permitted. "CHROMODEK" ROOFING SHEETS: - Shall be the secret fixed type, supplied with all fittings in full-length sheets in the profile and

colour as specified. Sheets shall be a minimum of .58mm and maximum of .8mm thickness. When .58 thick sheets are used, purlin spacings shall be a maximum of 1.2mtr ϕ and maximum 1.5mtr ϕ for .8 thickness. Sheets shall leave the factory in the specified colour and any scratches etc., due to handling are to be 'touched up' on site after installation. All fixings, valleys, cappings and securing clips shall be to manufacturers' recommendations and no variations shall be accepted without prior approval from the department. 0,58mm thick roof sheeting for purlins up to 1,2m spacing and 0,8mm thick roof sheeting for purlins exceeding 1,2m – 1,5m spacing. In area's up to 30Km from the coast, metal roof sheeting to be 0,58mm thick with special corrosion protection as supplied in "Global- Duro" roofing sheets. All other area's to be 0,58mm as "Global-Tech corrosion protection. 0,58mm "Klip Lock 700 " or "Craflack " and 0,8mm " Brownbuilt ". (0,8mm is recommended for high rainfall and snow fall area's due to deeper trough.)

RATES: — for roof coverings, are to include for all necessary half tiles at verges and for all square cutting and waste at verges, abutments, and top and bottom edges and to both sides of ridges. STANDARD PREAMBLES TO ALL TRADES 30 Rev 3 January 2009 Rates for cappings, etc. are to include for all short lengths, cutting, waste and fitting at intersections. All measurements are nett. No allowances have been made for overlaps.

CORRUGATED IRON ROOFING, CLADDING AND FITTINGS: — are to be of an approved brand and are to be manufactured from galvanized steel sheets of the thickness specified after galvanising and having a galvanized coating of "Isacor Coating Designation Z275" for inland areas and 'Z600" for coastal areas as specified. Roofing, etc. shall be lapped one and a half corrugations at sides and 30mm at ends unless otherwise specified. Roofing, etc. shall be fixed to timber purlins, rails etc. with standard galvanized drive screws 65mm long and to steel purlins, etc. with 8mm galvanized hook bolts of the lengths stated. Each screw or bolt shall be fitted with one lead washer and one bituminous felt washer and shall be spaced not less than one screw or bolt to every alternate corrugation across the width at end laps and ends of sheets and at each intermediate purlin or rail. Rates for roofing, cladding and fittings are to include for: — a) Fixing as described. b) Bedding washers in an approved mastic sealing compound c) Coating projecting ends of hook bolts and nuts with bitumen after fixing d) All square notches, square cutting and waste, laps, fitting and drilling. All measurements are nett. No allowance has been made for laps.

FLUTED STEEL ROOFING, CLADDING AND FITTINGS: — are to be approved galvanized fluted steel sheets and fittings manufactured from galvanized steel sheets of the thickness specified after galvanising (a) Galvanized steel sheets and fittings: — are to be manufactured from galvanized steel having a galvanized coating of "Isacor Coating Designation Z275" for inland areas and of "Z600" for coastal areas as specified with the sheets having a plain galvanized finish and the fittings an embossed galvanized finish. Roofing, etc. shall be fixed to timber purlins, rails, etc. with standard drive crews of the lengths stated and to steel purlins, rails, etc. with 8mm galvanized hook bolts of the lengths stated. Each fixing screw or bolt shall be fitted with washers as recommended by the manufacturer of the roofing Vertical cladding shall be fixed with broad flutes externally - unless otherwise described - to timber rails with standard galvanized drive screws 50mm long and to steel rails with 6mm diameter x 25mm long galvanized sheet bolts. Each fixing screw or bolt shall be fitted with washers as recommended by the manufacturer of the cladding including drilling steel rails as necessary. (b) Baked enamel finished galvanized steel sheets and fittings: — are to be manufactured from un-passivated galvanized steel having a galvanized coating of "Isacor Coating Designation Z275" and finished where described in the items, with approved factory applied baked enamel finish of colours to be selected by the Department. Roofing, etc. shall be fixed to timber

METALWORK

PROPRIETARY MATERIALS: — Where proprietary materials are specified, the materials used are to be of the type, specified or other approved by the Department.

RATES: — for all metalwork, unless otherwise stated, are to include for cutting to length, shaping, turning, threading, forging, fitting, assembling, riveting, welding, welded running joints, filing smooth, also for all screws and holes and hoisting and fixing in position. All screwed work is to have full threads

ALUMINIUM AND ANODISED ALUMINIUM: — is to be of the brand specified or other approved and of 6063-TF or equivalent quality and temper.

Aluminium bars and sections shall comply with the relevant clauses of SANS 1476, extruded tube and hollow sections with the relevant clauses of SANS 1474, and sheet and strips with the relevant clauses of SANS 1470. All alloys to be anodised are to be of anodising quality.

Aluminium is to be free from flaws, hammer and die markings or other imperfections. Anodising of aluminium is to be carried out in accordance with SANS Specification 999 by an approved process. The average anodic film thickness shall be 25 micrometer, and at no point should the anodic film thickness fall below 22 micrometer or be thicker than 30 micrometer.

to anodising, all surfaces are to be de-greased and cleaned, all irregularities removed and flushed off smooth and buffed where necessary.

All anodised aluminium must be coated with a suitable "non-yellowing" methacrylate lacquer film, approved by the Department, over the entire surface. The lacquer film must be continuous and of a uniform average thickness not less than 10 micrometer. The lacquer thickness must be determined by use of a film meter or other instrument methods as described in ASTM B244-49T. Rates for anodised aluminium must include for this protective coating.

Before the work is put in hand, samples of finish are to be submitted to the Department for approval, and all finished work is to be equal in all respects to the approved samples.

The Contractor shall provide all samples required for testing in accordance with SANS Specification 999. If required, tests on the anodic film are to be carried out at the works of the anodised to verify that the work conforms to SANS Specification 999, the cost of which will be borne by the Contractor.

The surfaces of all aluminium which are jointed to or are in contact with other materials when fixed, particularly ferrous metals, are to be suitably insulated to prevent electrolytic corrosion.

Joints in all aluminium members are to be neatly formed in an approved manner with screw heads, pins, rivets, etc. concealed so that the joints are practically invisible. Screw or bolt

jointing is to be kept to a minimum and will be permitted only when welding is impracticable.

Unless otherwise described, stainless steel screws or bolts are to be used for jointing and fixing aluminium work. Welded joints are to be formed by argon arc process using SANS 1476/NS6 welding rods and finished off smooth.

Welding is to be executed in such a manner as not to affect the colour of the material or the anodic coating.

Exposed heads of screws, pins, rivets, etc. in coloured anodised aluminium are to be touched up with enamel paint to match the coloured anodised finish.

in the general construction and design affecting neatness, strength or durability may be introduced. If any deviation is proposed, the Contractor must submit detailed drawings showing the particular construction and form or section he proposes to use and such drawings, details and samples of fittings, etc. are to be approved by the Department before manufacture is commenced and every facility must be given for the work to be inspected during manufacture.

No work may be fixed in position until it has been inspected and approved. Anodised aluminium work must be erected as near to the end of the Contract period as possible, to minimise the danger of damage or deterioration.

All work is to be suitably protected during building operations and left in a clean and satisfactorily finished condition on completion. In particular, all anodised aluminium work must be protected against damage, and against deterioration or discolouration caused by mortar droppings, wax, paint, etc. all to the entire satisfaction of the Department. All work so damaged, deteriorated or discoloured must be replaced at the Contractor's expense.

Rates for aluminium work are to include for necessary cutting to lengths, shaping, turning, threading, forging, fitting, assembling, riveting, welding, welded running joints, filing smooth, also for all screws and holes and hoisting and fixing in position. All screwed work is to have full threads.

ANODISED ALUMINIUM WELDED WINDOWS AND DOORS: — are to be of an approved manufacture and design.

Windows and doors are to be fabricated from Medium Universal equal leg sections, unless otherwise specified, measuring 33mm over one opening section and not less than 4mm thick through the flanges and not less than 4.75mm through the web, unless otherwise stated.

The aluminium sections are to be of approved manufacture and of 6063-TF or equivalent quality and temper and are to be anodised after manufacture to the approval of the Department. Welds are to be electrically flash butt resistance welded, properly ground and cleaned off to give a uniform appearances.

Anodising, etc. is to be carried out as before described.

windows and doors are to be suitable for internal glazing and are to be fitted with approved anodised aluminium glazing beads of the "clip on" type. Drilling for the fixing of glazing beads is to be done to suit the thickness of the glass used.

The frames are to be perfectly flat, square, butt-welded at joints (mechanical joints will not

be permitted) and all opening sashes must fit perfectly on all faces and open or close freely without binding at any point. The glazing bars must be continuous with continuous intersections (mitred intersections will not be permitted) with ends scribed and fitted to the frames with shouldered ends passed through and riveted over. The sight lines of the main frame, whether consisting of all fixed lights, all opening sashes or portions of both and the glass plane must be the same throughout each window.

Weathering on sections is to be solid extruded with the sections (screwed or riveted on strips will not be permitted) except weather bars to sills of inward opening sashes which must be welded on and not screwed or riveted except in the approved designs of built-up transoms.

No steel is to be used in the manufacture of the windows unless it is stainless steel of quality to A.I.S.I. Type 316. All fittings, butt hinges, screws, nuts, bolts, etc. are to be of high quality aluminium or other approved non-corrosive material compatible with aluminium and of sufficient strength to perform the functions for which they are used. The handles, sliding stays and peg stays are to have nylon washers, bushes and pressure pads and are to be secured to the frames with screws having riveted ends. Pop rivet fixings will not be permitted.

The transoms and mullions of all purpose-made windows and doors are to be equally spaced between the outer frames to form openings of equal size. Where this is not the case, either the width or the height of the opening is stated. Unless otherwise stated, the fixed lights and sashes of all purpose-made windows and doors are to be in one square and the sashes and doors are to open out.

Frames must be provided with suitable fixing lugs bolted on to frame with aluminium alloy bolts or are to be holed for screwing as required with lugs or holes spaced one near top, one near bottom and not more than 750mm apart intermediately each side of frame.

Frames more than 900mm wide are to be provided with similar fixings to top and bottom and not more than 750mm apart.

All composite windows, doors, etc. are to be supplied with suitable and approved coupling mullions or transoms. Rectangular hollow section transoms where specified are to be

25mm x 115mm in section manufactured from 3mm thick aluminium.

The Contractor must submit drawings showing details of sections he proposes to use and these drawings are to be approved by the Department before manufacture is commenced, and when requested, specimen windows and doors complete with all fittings as well as specimen coupling mullions, transoms etc. must be submitted for approval and all windows, doors, etc. supplied must conform to the approved samples.

manufacturer of the windows and doors must supply a dimensioned set of drawings with the windows and doors, for use on the site, including clearance and strict fixing methods and details.

Windows and doors are to be delivered to the site in suitable protective wrappings or crates and are to be stacked on end and carefully handled at all times to prevent any marking or staining of surfaces.

Immediately the windows and doors have been delivered on the site, they are to be

thoroughly overhauled and all necessary adjustments or repairs are to be made before they are fixed in position. A further inspection is to be made after fixing and any further servicing required must be carried out in order to leave the windows and doors in a satisfactory condition and waterproof after glazing is completed.

Side Hung Sashes: — are to open out on a pair of aluminium hinges complete with antifriction weatherproof bushings fixed pin and nylon washers and fitted with anodised aluminium alloy sliding stay with friction fastener and an approved anodised aluminium two point handle and striking plate.

Bottom Hung Sashes: — are to open in on a pair of aluminium hinges complete with antifriction weatherproof bushings, fixed pin and nylon washers and fitted with concealed side arms and strong lever action spring catch and keep.

Top Hung Sashes: — are to open out on a pair of aluminium hinges complete with antifriction weather proof bushings, fixed pin and nylon washers and fitted with anodised aluminium peg stay with cranked locking stay.

Pivot Hung Sashes: — are to be hung on a pair of approved weatherproof brass satin-chrome finished friction pivots of the greatest possible diameter permissible and fitted at top with strong lever action spring catch for long arm or hand operation and striking plate, unless otherwise stated.

Vertically Pivot Hung Sashes: — are to be hung on free pivot cups at the head incorporating nylon bearing sleeves and lever pivots at the sill and fitted with one two-point casement handle and striking plate.

Projected Out Sashes: — are to be balanced on approved concealed side arms with stainless steel shoes and channels and fitted at bottom with one approved bow handle with catch incorporated.

In Sashes: — are to be balanced on approved concealed side arms with stainless steel shoes and channels and fitted at top with strong lever action spring catch for long arm or hand operation and striking plate:

Doors: — are to be side hung to open out on one and a half pairs of aluminium hinges to each leaf complete with anti-friction weatherproof bushings, fixed pin and nylon washers and fitted with lock set as specified, and each lock is to be provided with two keys. Satin chrome finish flush bolts are to be fitted at top and bottom of meeting edge of first closing leaf of double doors.

Adjustable Louver Sets: — are to be approved anodised aluminium adjustable louver sets consisting of head and all weather strips fitted with neoprene gaskets and two jamb strips

each fitted with louver brackets with spring loaded clips for the specified width of glass louver blades and complete with tilt bars and operating lever handles. Where the openings are not of height to suit standard width louver blades an alternate head section with static clips must be provided to take a fixed louver blade of the required width. The sets-sets are to be tap screwed to the window frame with stainless steel self-tapping screws.

GLAZING TO DOORS / ALUMINIUM GLAZED SCREENS

No glazing permitted to any fitting below Lock Rail (ie 1,2m high.).

Burglar Bars: — are to be standard type burglar bars formed of 20mm x 5mm aluminium bars riveted at intersections and riveted at ends to the window frame with high strength aluminium rivets. The burglar bars to the small pane type window are to line through with the glazing bars, and windows of the horizontal-pane type or of the no-glazing bar type are to be fitted with burglar bars which are divided as for the small pane type window.

All exposed surfaces of anodised aluminium are to be protected by means of an approved fabric backed adhesive tape. The Contractor shall satisfy the Department that the tape he proposes to use can be easily stripped after long exposure to sunlight, and rates are to include or the final stripping of the protective tape and cleaning down to approval at completion.

All work is to be protected during building against deterioration or discolouration caused by mortar droppings, wax, paint, etc. and all work so damaged is to be replaced at the Contractor's expense to the approval of the Department.

All glass and glazing has been elsewhere measured. All sashes and openings, unless otherwise stated, are to be single panes without glazing bars.

All windows and doors must be fixed into preformed openings in the structure (the building in of windows and doors will not be pen fitted) and rates are to include for supplying necessary templates for forming the openings. Fixing in position of windows and doors has been measured separately. Sizes of windows and doors are given to the nearest 10mm.

ADJUSTABLE LOUVER GEAR SETS: — are to be approved natural anodised aluminium adjustable sets consisting of head and sill weather strips fitted with neoprene gaskets and two jamb strips and fitted with sets brackets with spring loaded clips for the specified glass sets blades and complete with tilt bars and operating handles. Where the openings are **not** of a height to suit standard width sets blades an alternate head section with static clips must be provided to take a fixed sets blade of the required width.

RATES: — are to include for fixing in accordance with the manufacturers instructions for screwing head and sill weather strips and jamb strips with stainless steel screws to frames (Elsewhere measured) and for oiling and easing at completion.

PROVINCE OF KWAZULU-NATAL
DEPARTMENT OF HEALTH

ZNQ -

ST APOLLINARIS HOSPITAL - CONSTRUCTION WAITING AREA SHELTER FOR
PATIENTS AT ST APOLLINARIS HOSPITAL.

SCHEDULE OF RATES

4.1 ITEMS AND PRICING

The Department reserves the right to place an order for any quantities of items included in the Schedules. The Schedule of Rates must also not be assumed to include and describe every detail of the supply requirement, but must be taken and read in conjunction with the other parts of the document. Thus the supplier shall not have claim for further payment in respect of any order which may be described or implied in the contract, although apparently no corresponding items are given in the Schedule of Rates. The supplier shall be deemed to have satisfied himself before quoting as to the correctness and sufficiency of his quote for the contract and of the rates and prices stated in the Schedule of Rates.

4.2 TAX AND DUTIES

Prices, quoted and paid, must include all customs, excise and import duties, and any other tariffs or taxes levied by the government or statutory body having jurisdiction on the goods provided under this contract, **including Value Added Tax (applicable to the current rate).**

3.3 RATES

Except where provision is made in the Schedule of Rates, the rates and prices inserted shall be the full rates and prices for the service delivered described under the respective items and shall cover all labour, transport, overhead charges and profit, etc. as well as the general liabilities, obligations and risks arising out of the Conditions of Contract, the overhead charges and profit being spread proportionately over the rates of the relative items in the Schedule of Rates.

tem No	Description	Qty	Rate	Amount
	<p style="text-align: center;"><u>BILL NO 1</u></p> <p>ALTERATIONS</p> <p>The Tenderer is referred to the relevant Clauses in the Model Preambles to All Trades and to the Supplementary Preambles which are incorporated at the back of these Bills of Quantities..</p> <p>Unless otherwise described the preambles and full descriptions of all items appearing in all the bills of the preceding sections are to apply equally to this section.</p> <p>NOTES</p> <p>The materials to be used and the work to be done are to be similar and equal to the new work Contained in all the subsequent Bills.</p> <p>Unless otherwise described, the preambles and full Descriptions of the items appearing in all the subsequent Bills are to apply equally to this Bill.</p> <p>Items described as to be re-used or to be handed over to the Director are to be carefully dismantled where necessary and stacked on site where directed, and the Contractor will be responsible for their removal and storage until required, and shall make good all items missing, damaged or broken at his own expense.</p> <p>Unless otherwise described, no materials from the alterations shall be re-used in any new work without the written approval of the Director, with the exception of facing bricks required in filling to openings, etc., which may be re-used if free of cracks and chips and properly cleaned of all mortar.</p>			
Alterations				

Item No	Description	Qty	Rate	Amount
	<p>The Contractor is to take all dimensions affecting the existing buildings on the site as he will be solely responsible for all new work being to the correct sizes.</p> <p>Prices are to include for carting away from site all materials not specifically mentioned as being stored on site for re-use or handed over to the Director and all rubbish, debris, etc., arising from the alterations, etc., and for making good all work damaged or disturbed to the approval of the Director.</p> <p>Tenderers are to include in pricing for the statutory Requirements with regard to the demolition and disposal of asbestos cement material arising from the works.</p>			
	<i>Alterations</i>			

Item No.	Description	Unit	Qty.	Rate	Amount
	REMOVAL OF EXISTING WORK:				
	<u>PHARMACY</u>				
1.	existing rotten purlin 50 x 76mm and make good	m	6.05		
2.	gutter, downpipe and make good.	m	2.48		
	<u>MANAGER OFFICE</u>				
3.	existing wooden wall, door frame, door etc. and make good	m ²	5.50		
	<u>NEW OFFICE AND SHELTER</u>				
4.	Cut and remove Concrete floor, floor tiles etc. (300 x 300 x100) four poles to be installed and make good.	m ³	0.04		
	<u>PHARMACY DISPENSARY</u>				
5.	Counter, window pane etc. and make good.	no.	02.		
	Carried to Final summary <i>Alterations</i>				R

Item No	Description	Qty	Rate	Amount
1.	<p style="text-align: center;"><u>BILL NO 2</u></p> <p>EARTHWORKS</p> <p>(CPAP Work Group No. 104)</p> <p>The Contractor is advised that the term 'earth' includes natural ground and 'made-up' ground and he must allow in his prices for excavations for trenches, bases, etc., for excavation in natural ground and 'made-up' ground and for backfilling trenches, bases, etc., to reduced or natural ground level with the same material removed from below the reduced or natural ground level and backfilling over with the imported material used in filling under floors.</p> <p>No material from below the reduced or natural ground level is to be used in filling above the reduced or natural ground level and no imported material is to be used in filling below the reduced or natural ground level. Working Space</p> <p>The Contractor is to allow against the item of 'excavate to provide working space' for excavating beyond the extent of the nett excavations measured to provide the necessary working space for the carrying out of such work as described in the items. Rates are to include, in addition to the extra excavation, for any additional risk of collapse so incurred and for filling back and compacting The excavated material.</p> <p>Note the excavation include soft rocks, hard rock and stones etc.</p> <p><u>All hedges, bushes, other vegetation, rubbish and debris must be removed from the site to the dumping area; the site must be left unsoiled.</u></p> <p><u>Excavation not exceeding 1.5 m deep to secure the square tube. Trench size 300mm length x 300 mm wide x 600mm deep (note there is 3 trenches to be excavated).</u></p> <p>trench</p> <p>Carried to Final Summary Earthworks</p>	m ³	0.17	R

Item No.	Description	Unit	Qty.	Rate	Amount
1.	<p style="text-align: center;"><u>BILL NO. 3</u></p> <p>CONCRETE, FORMWORK AND REINFORCEMENT</p> <p>The Tenderer is referred to the relevant Clauses in the Model Preambles to All Trades and to the Supplementary Preambles which are incorporated at the back of these Bills of Quantities.</p> <p>VIBRATED UNREINFORCED CONCRETE CAST ON/IN THE TRENCHES – 20 mPa / 19 mm concrete stones</p> <p>All concrete is to be effectively cured. Footings and bases are to be kept wet for 7 days. Columns are to be wrapped in plastic for 7 days. Slabs are to be covered with plastic for 7 days</p> <p>Supply, deliver and cast unreinforced concrete:</p> <p><u>to secure the square tubes (03 tubes to be secured, trench size 300 x300 x600 mm deep)</u></p> <p>concrete for poles.</p> <p>Carried to Final Summary Concrete, formwork and Reinforcements</p>	m ³	0.17		R

Item No	Description	Qty	Rate	Amount
	<p style="text-align: center;"><u>BILL NO. 4</u></p> <p>CARPENTRY AND JOINERY</p> <p>PREAMBLES</p> <p>For Preambles refer to "Standard Preambles to all trades - WB20 - 1986"</p> <p>SUPPLEMENTARY PREAMBLES</p> <p>TIMBER</p> <p>All softwood to be South African pine. All hardwood to be Iroko unless otherwise specified.</p> <p>DESCRIPTIONS</p> <p>The term "planted on" shall mean the nailing of one timber member to another.</p> <p>The term "screwed on" shall mean the countersunk screwing of one timber member to another.</p> <p>The term "screwed on and pelleted" shall mean the screwing of one timber member to another with the heads of screws sunk and pelleted.</p> <p>The term "plugged" shall mean the countersunk screwing of a timber member to and including plastic plugs in brickwork or</p> <p>The term "plugged and pelleted" shall mean the screwing of a timber member to and including plastic plugs in brickwork or concrete with heads of screws sunk and pelleted.</p> <p>Descriptions of floors, ceilings, joinery, etc. shall be deemed to include for all square cutting.</p> <p>Descriptions of items given in lineal metre shall be deemed to include for mitres, stopped ends, fitted intersections, etc.</p> <p>Carpentry and Joinery</p>			

Item No.	Description	Unit	Qty.	Rate	Amount
1.	<p align="center"><u>BILL NO. 3</u></p> <p align="center"><u>PHARMACY DISPENSARY (CUBICLES).</u></p> <p>Supply, deliver and install:</p> <p><u>treated SA Pine size 800mm length x 720mm wide x 20mm thick, the front edge to be molded (bull nose shape)</u></p> <p>boards</p> <p>Carried to Final Summary Carpentry and Joinery</p>	no.	02.		

Item No.	Description	Unit	Qty.	Rate	Amount
	<u>BILL NO. 5</u>				
	STRUCTURAL STEEL WORK				
	(CPAP WORK GROUP NO. 136 UNLESS OTHERWISE STATED)				
	The Tenderer is referred to the relevant clauses in the Specification of Materials and Methods to be used PW371, the Supplementary Preambles and Notes.				
	<u>Hot dip Galvanizing to be in accordance with SABS 7</u>				
	Supply, deliver and install Hot dip galvanized:				
	<u>NEW OFFICE AND SHELTER</u>				
	<u>square tube 75 x 75 x 1.60 mm with the welded base plate length of the square tube is 2966mm</u>				
1.	tube	no.	03.		
	<u>Base plate details: 250 x 250 x 5mm check the attached (drawing 8)</u>				
2.	base plate	no.	03.		
	Carried to Final Summary				
	Structural Steel Work				R

Item No.	Description	Unit	Qty.	Rate	Amount
	<p style="text-align: center;"><u>BILL NO. 6</u></p> <p>METAL WORK</p> <p>ALUMINIUM WINDOWS, DOORS, SCREENS, ETC. Aluminium Windows</p> <p>Aluminium windows are to be manufactured and supplied by Messrs. Sheer line Systems or other approved institution.</p> <p>Windows are to be factory-glazed and fitted with all necessary PVC or neoprene glazing gaskets, aluminium glazing beads, weather seals, etc., in accordance with the manufacturers standard details</p> <p>After fabrication the windows, glazing beads, etc., are to be properly etched and anodised bronze with an anodised film thickness of 25 microns in accordance with SABS 999.</p> <p>The frames are to be formed perfectly flat on all faces, truly square and properly jointed at angles and Intersections.</p> <p>The sight lines are to be the same throughout each Window of the same type.</p> <p>All frames are to be fitted with standard fixing lugs spaced one near each corner and not exceeding 450mm apart intermediately all round frame.</p> <p>The windows are to be protected with plastic sheeting held in position with non-staining adhesive tape capable of easy stripping.</p> <p>Prices for windows are to include for assembling the Component parts, setting up in position and plugging and screwing fixing lugs to concrete, oiling and easing all opening sections, protecting from damage and cleaning down and leaving in perfect condition at completion.</p> <p>Note: Colour for all aluminium to be Natural Silver (frames, doors, hinges, etc.)</p> <p>Also allow the price for the glasses on the aluminium Metal Work</p>				

Item No.	Description	Unit	Qty.	Rate	Amount
	Supply, deliver and install: <u>'Sheer line System 30' natural anodised aluminium windows glazed as scheduled and factory fitted with burglar bars to all opening sections:</u> <u>all door panels consists of 100mm stiles</u>				
	<u>NEW SHELTER</u>				
	<u>Window in six top hung opening lights and six fixed aluminium panels fitted on the bottom section. Panel size: 3 062.50 x 2 366mm high. Long side / Back (Drawing 1).</u>				
1.	panel	no.	02.		
	<u>All Windows are fixed the top half. Aluminium panels fitted on the bottom section. Panel size: 4 300mm x 2 480mm high. front (Drawing 2).</u>				
2.	panel	no.	01.		
	<u>Aluminium double door 1620 wide x 2032mm high fitted with 4mm 'Armour plate' clear top half and aluminium panel on the bottom. two flush bolts to be installed on top and bottom of one door</u>				
3.	double doors	no.	01.		
	<u>MANAGER OFFICE</u>				
	<u>Aluminium frames fitted with aluminium panels, single door. Wall size: 2 000 x 2 750mm high (Drawing 3)</u>				
4.	Aluminium wall.	no.	01.		
	<u>PHARMACY DISPENSARY</u>				
	<u>Aluminium frame with 6.4mm clear glass fitted on the aluminium frame, there is slot on the bottom and lockable small door. Size 800mm x 900mm high (Drawing 4)</u>				
4.	Aluminium frame and with lockable door and slot	no.	01.		
	Carried to Collection Summary Metal Work				

Item No.	Description	Unit	Qty.	Rate	Amount
	<u>PHARMACY DISPENSARY (INSIDE)</u>				
	<u>Aluminium frame with lockable door, 75mm stiles and aluminium panel fitted into the stiles. The frame has to be mounted on the wall. Size 950mm x 1050mm high (Drawing 5)</u>				
5.	Aluminium frame and with lockable door	no.	01.		
	<u>NEW OFFICE(ON THE SHELTER)</u>				
	<u>All Windows are fixed the top half. Aluminium panels fitted on the bottom section. Panel size: 1 700mm x 2 480mm high. Front of the office (Drawing 6). There is single door in the middle of the panel</u>				
6.	panel	no.	01.		
	<u>All panels are made up of aluminium and fixed. Panels to be fitted on the aluminium frames. Panel size: 2 000mm x 2 480mm high. side of the office (Drawing 7).</u>				
7.	Panel	no.	01.		
	<u>Aluminium single door 810 wide x 2032mm high with two aluminium panel on the top and bottom.</u>				
8.	single door	no.	01.		
	<u>NEW SHELTER</u>				
	<u>Industrial 155 mm box gutter with following specifications: back height 100 mm, front height 125mm mm and bottom is 100 mm and thickness of 0.6mm. colour green</u>				
9.	gutter	m	6.05		
	<u>Downpipe required aluminium rectangular shape 100 x 75mm. colour green</u>				
10.	down pipe	m	3.00		
	Carried to Collection Summary				
	Metal Work				R

Item No	Description	Page No	Amount
	<p align="center"><u>BILL NO. 6</u></p> <p>Metal Work</p> <p><u>Collection Summary</u></p>	<p>26.</p> <p>27.</p>	
	<p>Carried to Final Summary</p> <p>Metal work</p>		<p align="center">R</p>

Item No.	Description	Unit	Qty.	Rate	Amount
	<u>BILL NO. 7</u>				
	IRONMONGERY:				
	(CPAP WORK GROUP NO. 132 UNLESS OTHERWISE STATED)				
	The Tenderer is referred to the relevant clauses in the Specification of Materials and Methods to be used PW371, the Supplementary Preambles and Notes.				
	<u>NEW SHELTER (DOUBLE DOORS)</u>				
	<u>Aluminium Door handles + cylinder lock and insert lock. Suitable for aluminium door</u>				
1.	lock	no.	01.		
	<u>aluminium sinkless hinges or flush hinges.</u> Length: 100mm Wide: 44mm Thickness: 3mm				
2.	Hinge	no.	04.		
	Aluminium flush bolts for aluminium double doors (two per door, one on top and one on the bottom).				
3.	flush bolts	no.	02.		
	<u>NEW OFFICE</u>				
	<u>Aluminium Door handles + cylinder lock and insert lock. Suitable for aluminium door</u>				
4.	lock	no.	01.		
	<u>aluminium sinkless hinges or flush hinges.</u> Length: 100mm Wide: 44mm Thickness: 3mm				
5.	Hinge	no.	02.		
	Carried to Final Summary Ironmongery				R

Item no.	Description	Unit	Qty.	Rate	Amount
1.	<p style="text-align: center;">BILL NO 8</p> <p>TILING</p> <p>(CPAP WORK GROUP NO. 144 UNLESS OTHERWISE STATED)</p> <p>The Contractor is referred to the relevant Clauses in the separate document Specifications of Materials and Methods to be Used (PW 371) Fourth Revision October 1993.</p> <p>SUPPLEMENTARY PREAMBLES</p> <p>Descriptions</p> <p>Unless described as "fixed with adhesive to plaster (plaster elsewhere)" descriptions of tiling on brick or concrete walls, columns, etc. shall be deemed to include 1:4 cement plaster backing and descriptions of tiling on concrete floors etc. shall be deemed to include 1:3 plaster bedding</p> <p style="text-align: center;"><u>NEW SHELTER AND NEW OFFICE</u></p> <p><u>Supply, deliver and install floor tiles:</u></p> <p><u>Floor tiles fixed with an approved adhesive and jointed and pointed in tinted mortar grout. Note tiles need to match existing floor tiles. Tile to be installed where the poles, and door frames were installed</u></p> <p>floor tiles.</p> <p>Carried to Final Summary Tiling</p>	m ²	0.76		R

Item no.	Description	Unit	Qty.	Rate	Amount
1.	<p style="text-align: center;"><u>BILL NO. 9</u></p> <p>GLAZING</p> <p>The Tenderer is referred to the relevant clauses in the Specification of Materials and Methods to be used PW371, the Supplementary Preambles and Notes.</p> <p style="text-align: center;"><u>PHARMACY DISPENSARY (INSIDE).</u></p> <p><u>Cubicle 1 there is slot on the bottom and lockable door.</u></p> <p><u>Cubicle 2 there is slot on the bottom.</u></p> <p><u>(Drawing 4)</u></p> <p>Supply, deliver and install clear glass with the thickness of 6.4mm</p> <p>window pane exceeding 0.5m² but not exceeding 2m²</p> <p>Carried to Final Summary. Glazing.</p>	no.	02.		R

Item no	Description	Unit	Qty.	Rate	Amount
	<u>BILL NO. 10</u>				
	PAINTWORK (WORK GROUP NO. 152)				
	PREAMBLES For Preambles refer to "Standard Preambles to all trades - WB20 – 1986				
	SUPPLEMENTARY PREAMBLES DESCRIPTIONS Descriptions of paintwork shall be deemed to include for all cutting in				
	Proprietary Items Proprietary items or materials where specified are to be of the brand specified - or other approved - by Head: Works				
	PREPARATORY WORK TO EXISTING WORK: The boards needs to be sanded properly Before the varnish is applied. Apply sanding sealer and two coats of clear varnish Two board to be varnished on all the sides Supply, deliver and varnish:				
1.	Sa pine boards	m ²	2.42		
	<u>NEW SHELTER</u> supply, deliver and apply two coats of carbolinium on new roof purlin				
2.	carbolinium		1.52		
	Carried to Final Summary Paint Work				R

Item No	Description	Page No	Amount
<u>Final summary</u>			
1.	Alterations.	19.	
2.	Earthworks.	20.	
3.	Concrete formwork and Reinforcement.	21.	
4.	Carpentry and Joinery.	23.	
5.	Structural Steel Work.	24.	
6.	Metal Work.	28.	
7.	Ironmongery.	29.	
8.	Tiling	30.	
9.	Glazing	31.	
10.	Paint Work	32.	
Material recovered onsite will remain the property of the Department of Health KZN			
Carried to Quotation form			R

The following documents must be returned with the quotation:

- CIDB Registration certificate under General Building
- Valid Tax Clearance

COMPILED BY: C.B. Ngcobo 
CHIEF WORKS INSPECTOR AT HARRY GWALA HEALTH DISTRICT

CHECKED BY: B.J ZINDELA  28/08/23
DISTRICT ENGINEER AT HARRY GWALA HEALTH DISTRICT

IMPORTANT

THIS FORM IS ONLY TO BE INCLUDED AND COMPLETED WHEN APPLICABLE TO THE QUOTATION.

OFFICIAL BRIEFING SESSION / SITE INSPECTION CERTIFICATE

Site/building/institution involved: **ST APOLLINARIS HOSPITAL.**

Quotation No.: **ZNQ -**

Service: **CONSTRUCTION OF A WAITING AREA SHELTER FOR PATIENTS AT ST APOLLINARIS HOSPITAL. R**

THIS IS TO CERTIFY THAT..... OF (STATE NAME OF TENDERER) VISITED AND INSPECTED THE SITE ON (DATE) AND IS THEREFORE FAMILIAR WITH THE CIRCUMSTANCES AND THE SCOPE OF THE SERVICE TO BE RENDERED.

.....
SIGNATURE OF TENDERER OR AUTHORISED REPRESENTATIVE

DATE :.....

.....
SIGNATURE OF DEPARTMENTAL REPRESENTATIVE

DEPARTMENTAL STAMP:

DATE :.....

Note: the Safety file is required within 03 working days after the Contractor has been awarded

Initials and Surname: _____
Signature _____

CONTRACTOR DETAILS

- On appointment compliance with the following:
- Submission of site specific health and safety file.
- Covid 19 compliance
- Signing of site hand over certificate.
- Contractors staff to have identifiable workwear.
- Compliance with EPWP requirements.
- Submission of contractors program.
- Penalties will be imposed on defaulting contractors, formula as follows (0.00275 x total cost) = cost per day
- Contractors are requested to sign this document.

Minimum points required is 50

CRITERIA	POINT ALLOCATION	CONTRACTOR POINTS OBTAINED	COMMENTS
One verifiable order of similar work with completion certificate.	10		
Director /shareholder with relevant qualifications in the construction industry or the qualification of the Artisan who is going to execute the job. He / She has to be present on site during construction work	30		
Attach, the letter of good standing	10		
Attach, active CIDB	30		
Locality 0 to100 km = 20 points 101 to 300km 10 points	20		
Total points	100		

CONSTRUCTION OF A WAITING AREA SHELTER FOR PATIENTS AT ST APOLLINARIS HOSPITAL.

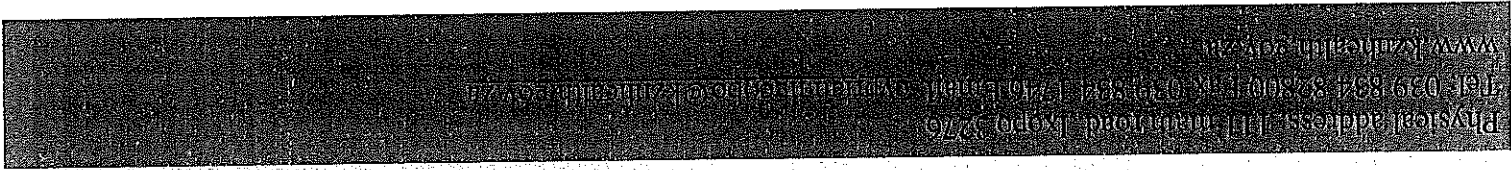

ST APOLLINARIES HOSPITAL

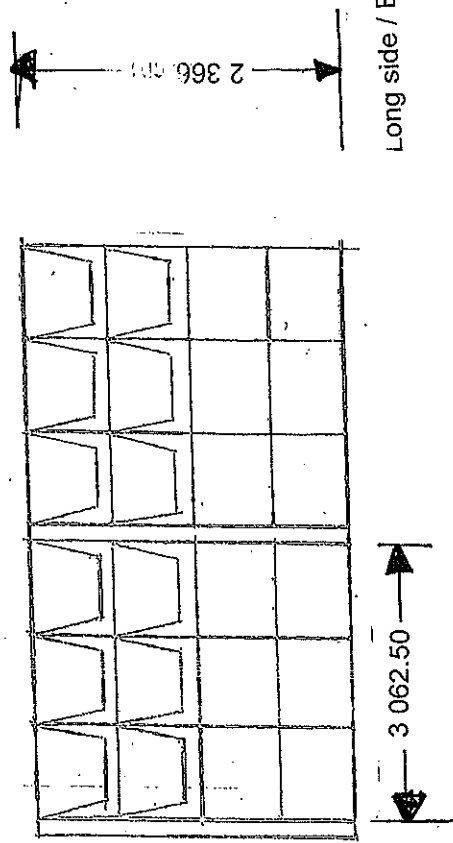

PHARMACY

Drawing 1

ST APOLLINARIES HOSPITAL

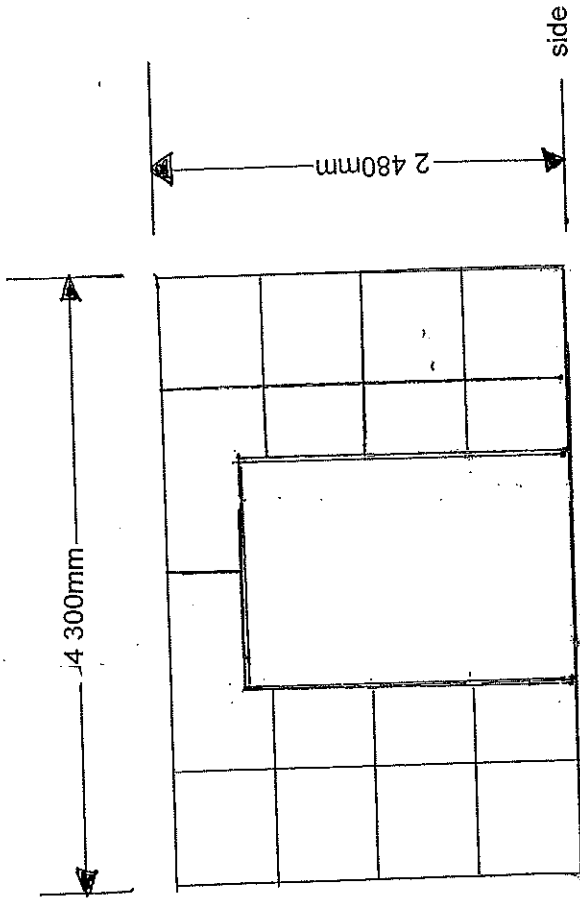

PHARMACY

Drawing 2

ST APOLLINARIES HOSPITAL

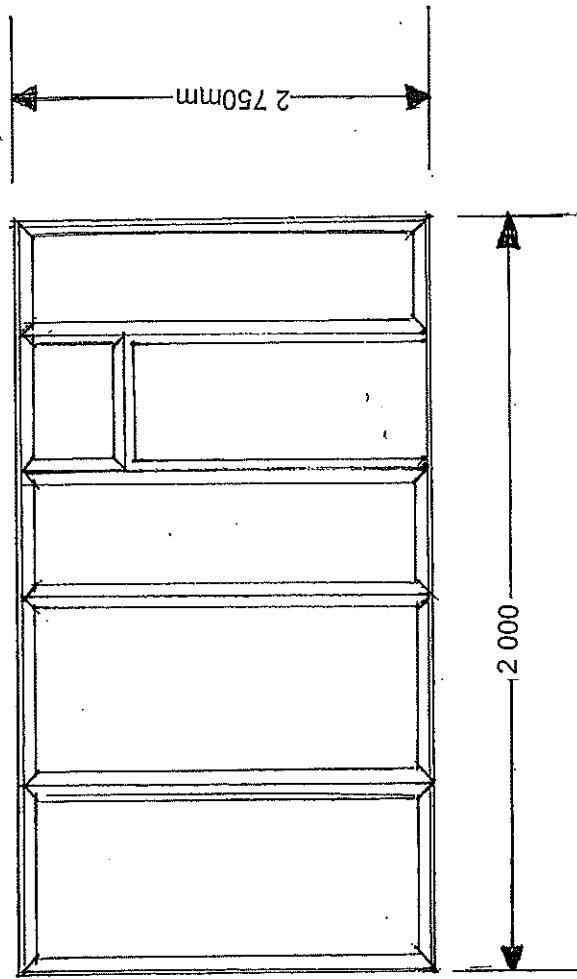

Drawing 3

ST APOLLINARIES HOSPITAL

CUBICLE 2

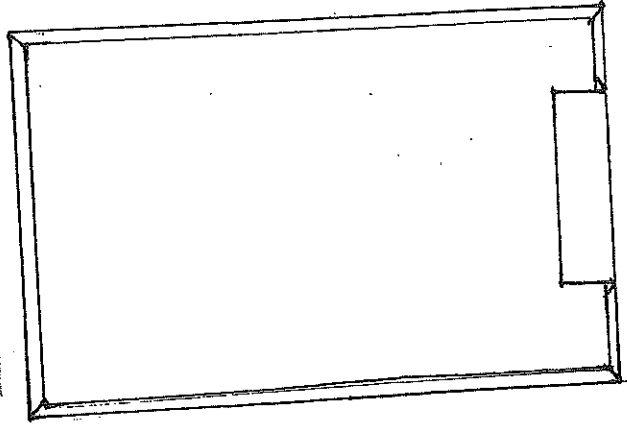

CUBICLE 1

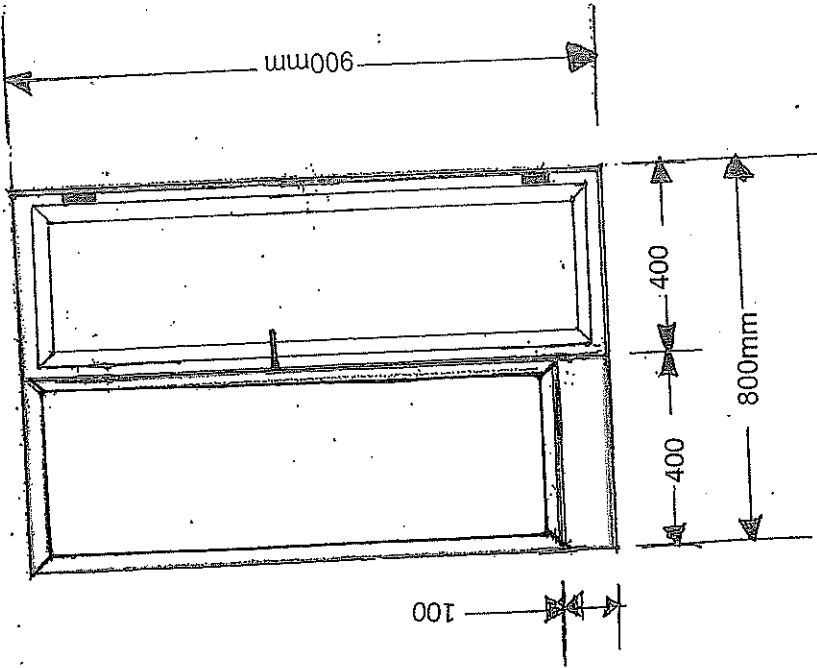

Drawing 4

ST APOLLINARIES HOSPITAL

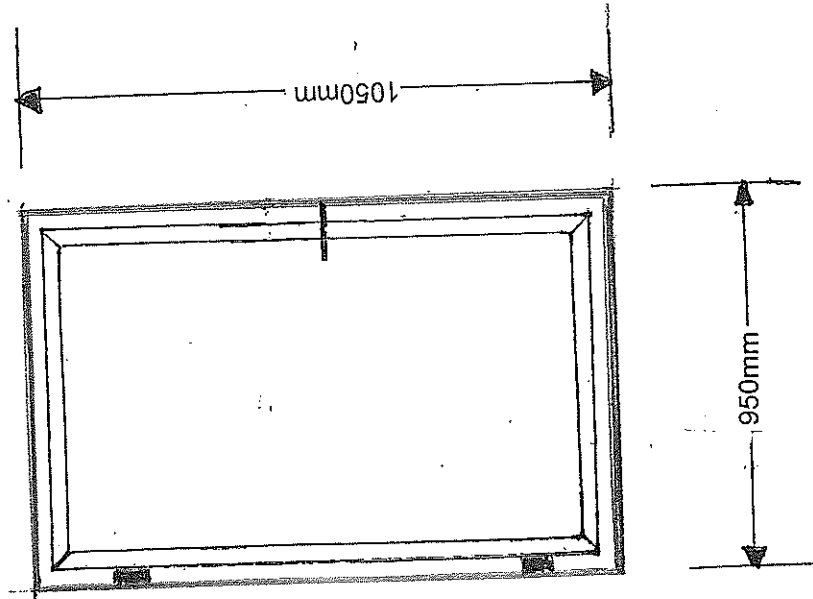

Drawing 5

ST APOLLINARIES HOSPITAL

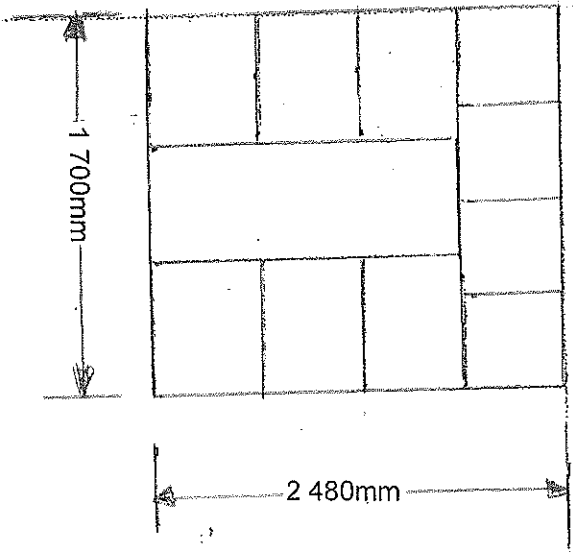

Drawing 6

ST APOLLINARIES HOSPITAL

NEW OFFICE SIDE

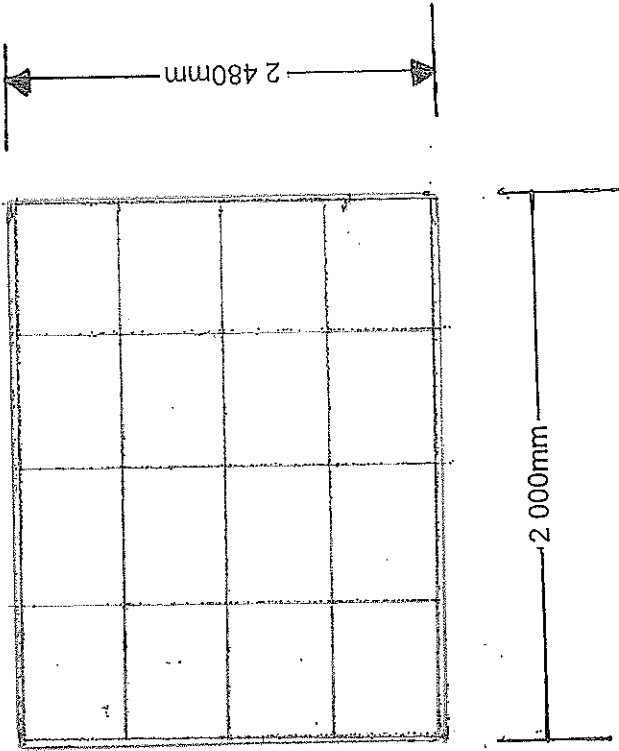

Drawing 7

ST APOLLINARIES HOSPITAL

Hop dipped galvanized base plate

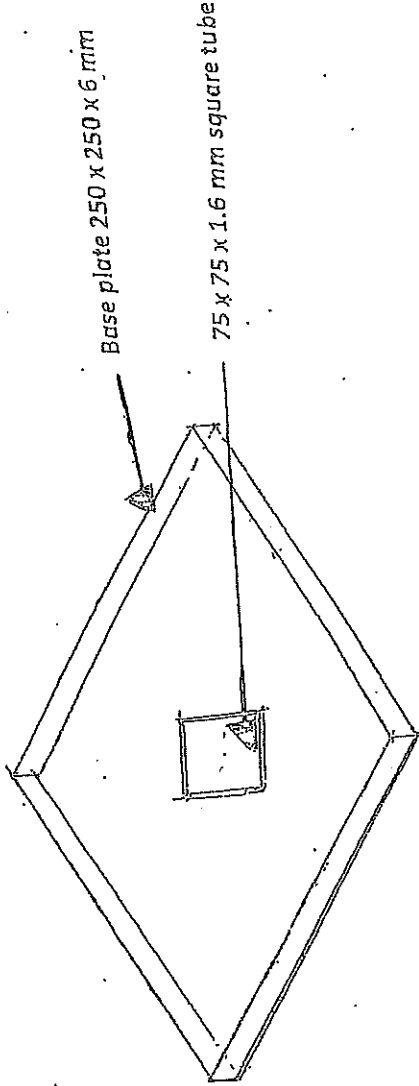

Drawing 8